

±12,471 SF  
**INDUSTRIAL  
SPACE  
FOR LEASE**

Corner  
Unit

Mezzanine  
Space Above  
Office Area

Professionally  
Owned and  
Managed by:



  
**TRANSWESTERN**  
REAL ESTATE  
SERVICES

# 1071 KINGSLAND DRIVE

Batavia, IL 60510

[Property Website](#)



## SPECIFICATIONS

- Building Size: ±54,522 SF
- Land Area: ±3.70 AC
- Available Size: ±12,471 SF
- Office Size: ±1,473 SF
- Mezzanine Size: ±1,560 SF
- Ceiling Height: 18'
- Loading: 1 Ext Dock / 1 DID
- Parking: ±20 Cars
- Sprinklers: Wet
- Year Built: 1990
- Zoning: LI (Light Industrial)
- Construction: Masonry/Metal
- **Lease Rate: Subject to Offer**

## HIGHLIGHTS

- Corner unit
- Mezzanine space above office area
- Low Kane County taxes
- Easy access to Routes 25, 31, 38, 56, and 59
- Professionally owned and managed

## PRICING

- CAM: \$1.15 PSF
- INS: \$0.16 PSF
- RET: \$2.02 PSF
- **Lease Rate: Subject to Offer**

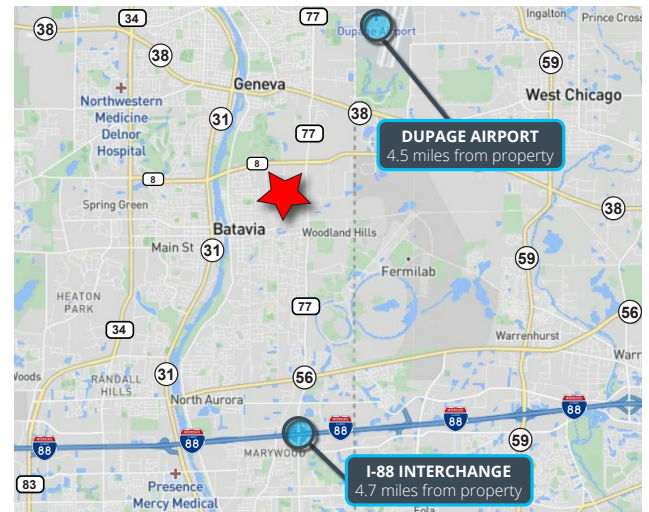

**Marko Kaplarevic**  
Associate  
847.588.5651  
marko.kaplarevic@transwestern.com

**Michael Marconi, SIOR**  
Sr. EVP & Designated Managing Broker  
847.588.5679  
michael.marconi@transwestern.com

The information provided herein was obtained from sources believed reliable; however, Transwestern makes no guarantees, warranties, or representations as to the completeness or accuracy thereof. The presentation of this information is submitted subject to errors, omissions, change of price or conditions, prior sale or lease, or withdrawal without notice. Copyright © 2024 Transwestern.

±12,471 SF  
INDUSTRIAL  
SPACE  
FOR LEASE

Corner  
Unit

Mezzanine  
Space Above  
Office Area

Professionally  
Owned and  
Managed by:



**TRANSWESTERN**  
REAL ESTATE  
SERVICES

# 1071 KINGSLAND DRIVE

Batavia, IL 60510  
[Property Website](#)

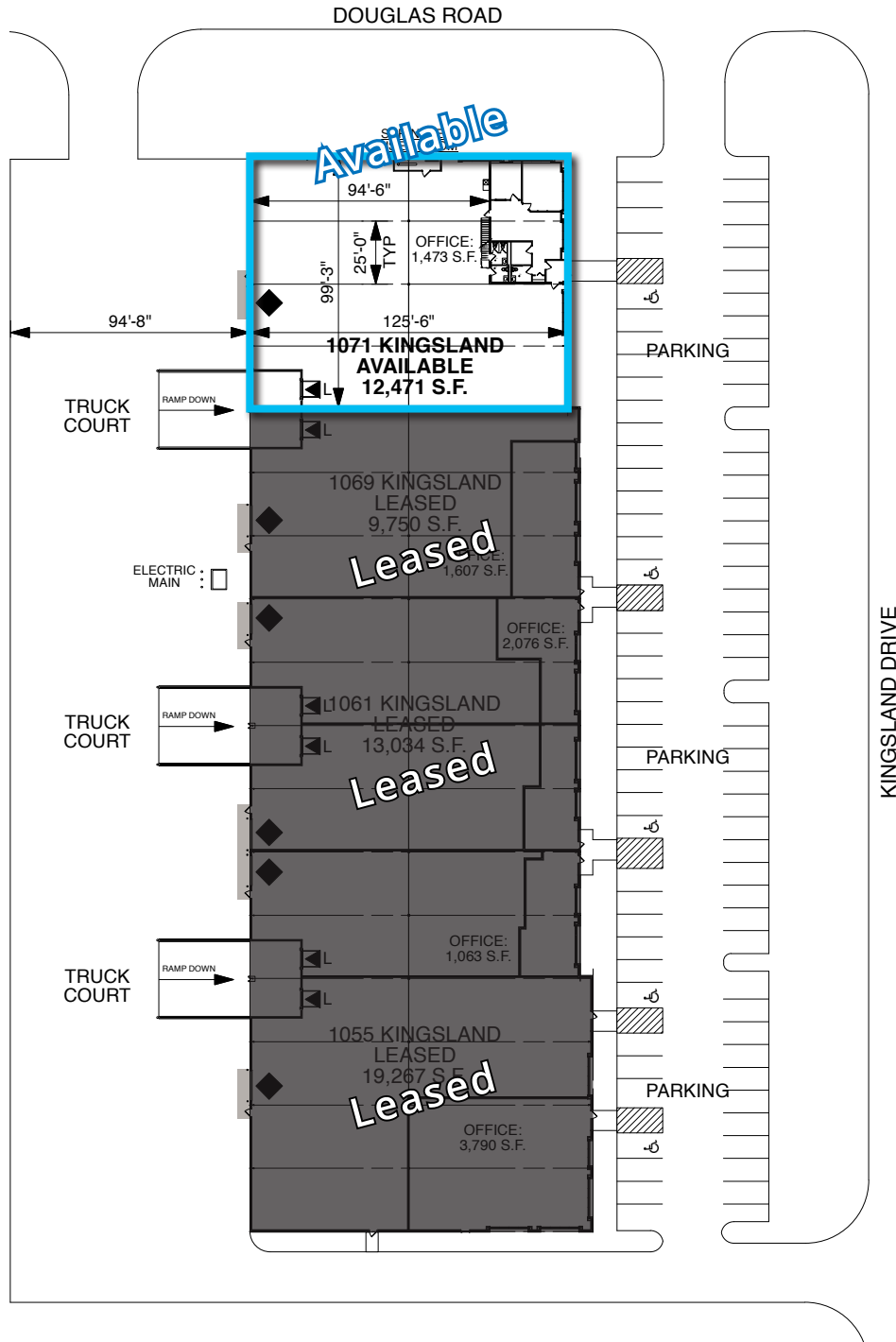

**Marko Kaplarevic**  
Associate  
847.588.5651  
marko.kaplarevic@transwestern.com

**Michael Marconi, SIOR**  
Sr. EVP & Designated Managing Broker  
847.588.5679  
michael.marconi@transwestern.com

The information provided herein was obtained from sources believed reliable; however, Transwestern makes no guarantees, warranties, or representations as to the completeness or accuracy thereof. The presentation of this information is submitted subject to errors, omissions, change of price or conditions, prior sale or lease, or withdrawal without notice. Copyright © 2024 Transwestern.