

**INDUSTRIAL
SPACE
FOR LEASE**

±6,823 SF

Easy Access
to Route 38
and Route 59

Professionally
Owned and
Managed by:

AGELLAN
COMMERCIAL REIT

TRANSWESTERN
REAL ESTATE
SERVICES

333 CHARLES COURT

Suite 105, West Chicago, IL 60185

[Property Website](#)



Specifications

- Building Size: ±45,115 SF
- Land Area: ±3.57 AC
- Available Size: ±6,823 SF
- Office Size: ±1,598 SF
- Ceiling Height: ±22'
- Loading: 1 Ext Dock / 1 DID
- Power: 400A 277/480V
- Parking: ±15 Cars
- Year Built: 2007
- Construction: Precast Concrete
- **Lease Rate: Subject to Offer**

Highlights

- Hard-to-find smaller unit with 22' ceilings
- Easy access to Route 38 and Route 59
- 6.4 miles from I-88 via Route 59
- Professionally owned and managed

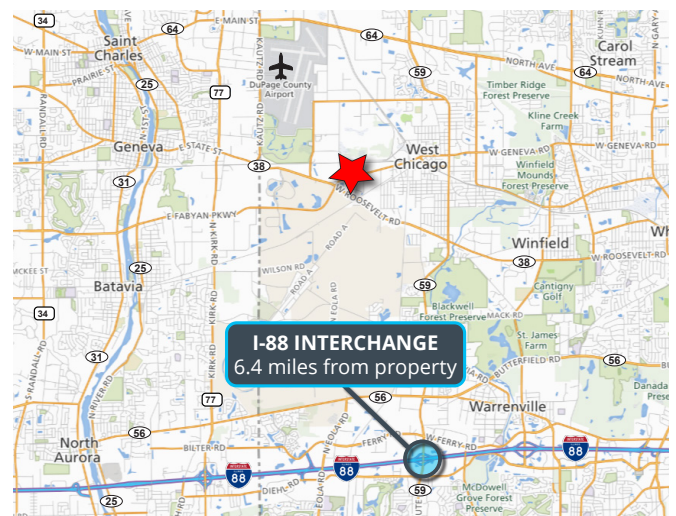

Michael Marconi, SIOR
Sr. EVP & Designated Managing Broker
847.588.5689
michael.marconi@transwestern.com

Marko Kaplarevic
Associate
847.588.5651
marko.kaplarevic@transwestern.com

The information provided herein was obtained from sources believed reliable; however, Transwestern makes no guarantees, warranties, or representations as to the completeness or accuracy thereof. The presentation of this information is submitted subject to errors, omissions, change of price or conditions, prior sale or lease, or withdrawal without notice. Copyright © 2024 Transwestern.

**INDUSTRIAL
SPACE
FOR LEASE**

±6,823 SF

Easy Access
to Route 38
and Route 59

Professionally
Owned and
Managed by:

AGELLAN
COMMERCIAL REIT

TRANSWESTERN
REAL ESTATE
SERVICES

333 CHARLES COURT

Suite 105, West Chicago, IL 60185

[Property Website](#)

UNIT LAYOUT

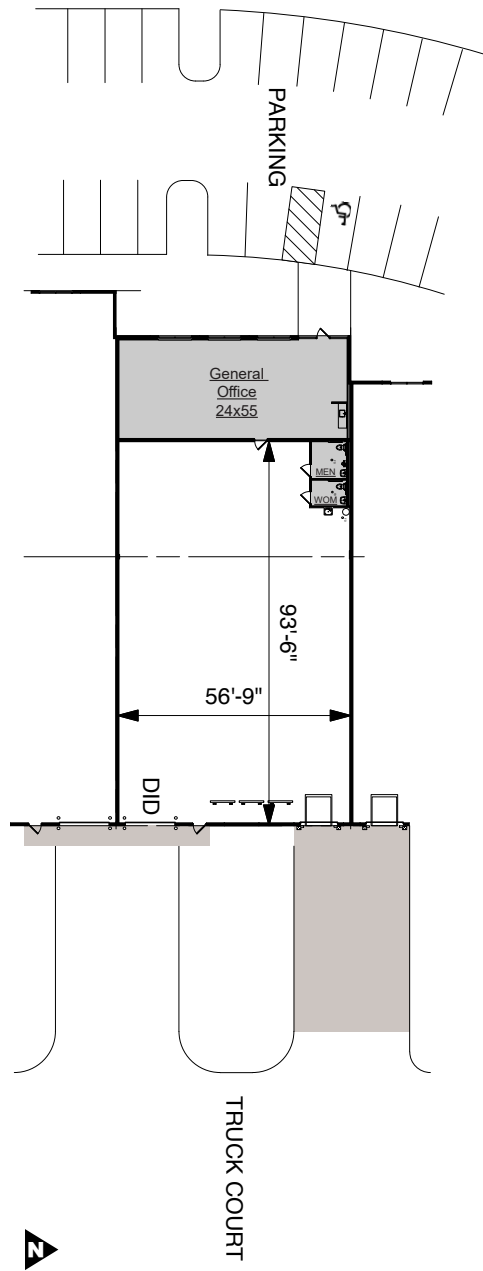

AERIAL VIEW



Michael Marconi, SIOR
Sr. EVP & Designated Managing Broker
847.588.5689
michael.marconi@transwestern.com

Marko Kaplarevic
Associate
847.588.5651
marko.kaplarevic@transwestern.com

The information provided herein was obtained from sources believed reliable; however, Transwestern makes no guarantees, warranties, or representations as to the completeness or accuracy thereof. The presentation of this information is submitted subject to errors, omissions, change of price or conditions, prior sale or lease, or withdrawal without notice. Copyright © 2024 Transwestern.