

860 Lively Boulevard

INDUSTRIAL SPACE FOR LEASE

852-864 Lively Blvd, Wood Dale, IL

[Property Website](#)

±10,415 SF
Available

Direct Access to
I-390 Tollway

Excellent Proximity
to O'Hare Airport

Professionally
Owned & Managed



Ross Lehrman

Senior Vice President
(847) 588-5671
ross.lehrman@transwestern.com

Justin Lerner, SIOR

Executive Vice President
(847) 588-5665
justin.lerner@transwestern.com

Joe Karmin, SIOR

Executive Vice President
(847) 588-5670
joe.karmin@transwestern.com

The information provided herein was obtained from sources believed reliable; however, Transwestern makes no guarantees, warranties, or representations as to the completeness or accuracy thereof. The presentation of this information is submitted subject to errors, omissions, change of price or conditions, prior sale or lease, or withdrawal without notice. Copyright © 2026 Transwestern.

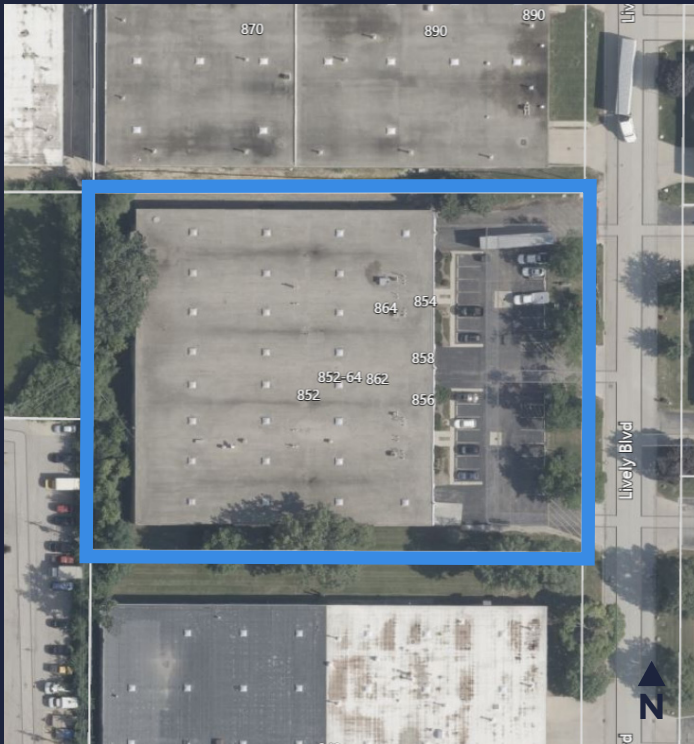

Property Highlights

- ±10,415 SF industrial space available
- New paint and carpet in office
- New LED lighting in warehouse
- Direct access to I-390 (Elgin-O'Hare Tollway)
- Well-maintained industrial multi-tenant facility
- Professionally owned and managed by
Westmount Realty Capital

BUILDING SIZE	±45,760 SF
LAND AREA	±1.93 AC
AVAILABLE SIZE	±10,415 SF
OFFICE SIZE	±1,518 SF
CEILING HEIGHT	15'
LOADING	1 Int Dock
POWER	600A 120/208V
PARKING	7 Cars
CAM	\$1.39 PSF (2026 Est.)
INS	\$0.09 PSF (2026 Est.)
RET	\$2.02 PSF (2026 Est.)
LEASE RATE	Subject to Offer

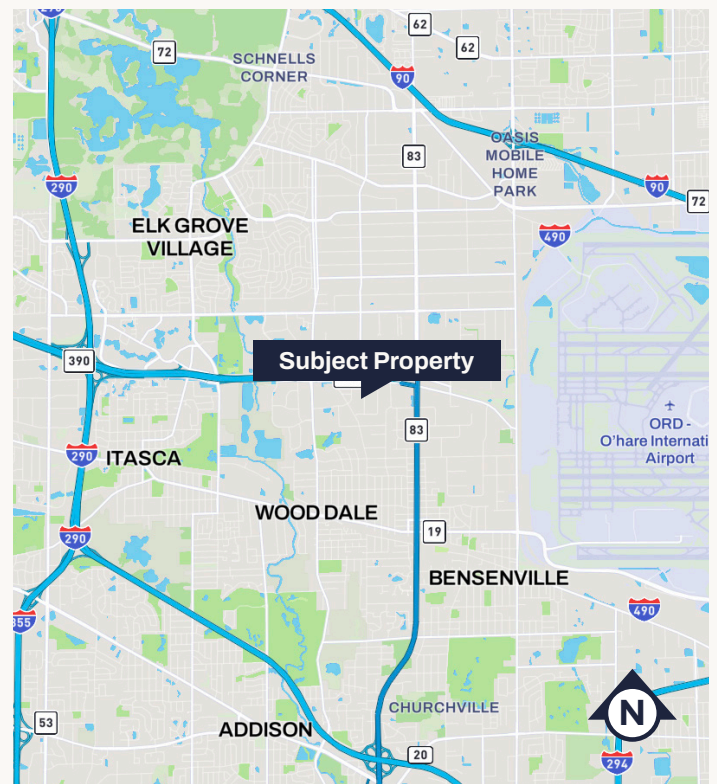

Ross Lehrman

Senior Vice President
(847) 588-5671
ross.lehrman@transwestern.com

Justin Lerner, SIOR

Executive Vice President
(847) 588-5665
justin.lerner@transwestern.com

Joe Karmin, SIOR

Executive Vice President
(847) 588-5670
joe.karmin@transwestern.com



The information provided herein was obtained from sources believed reliable; however, Transwestern makes no guarantees, warranties, or representations as to the completeness or accuracy thereof. The presentation of this information is submitted subject to errors, omissions, change of price or conditions, prior sale or lease, or withdrawal without notice. Copyright © 2026 Transwestern.

860 Lively Boulevard

INDUSTRIAL SPACE FOR LEASE

852-864 Lively Blvd, Wood Dale, IL
[Property Website](#)

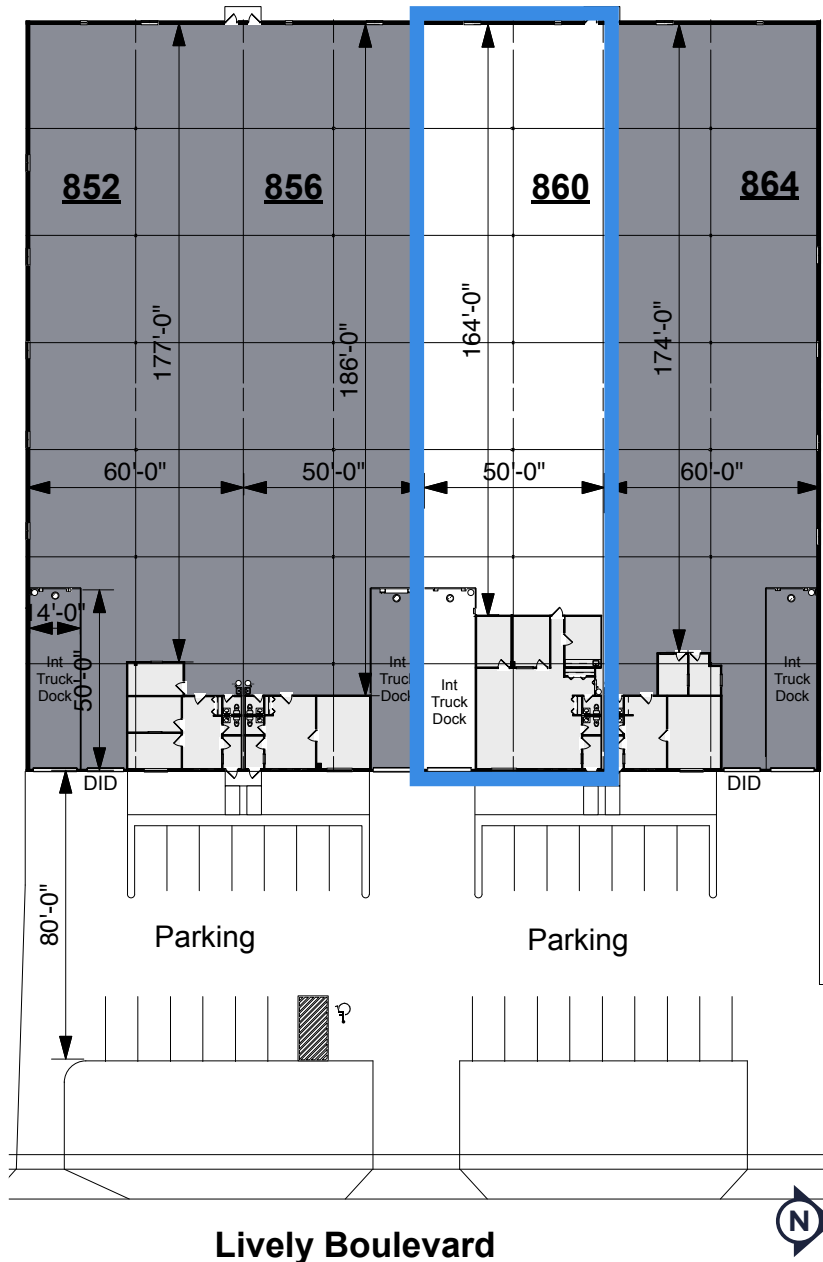

Lively Boulevard

FLOOR PLAN

Ross Lehrman

Senior Vice President
(847) 588-5671
ross.lehrman@transwestern.com

Justin Lerner, SIOR

Executive Vice President
(847) 588-5665
justin.lerner@transwestern.com

Joe Karmin, SIOR

Executive Vice President
(847) 588-5670
joe.karmin@transwestern.com

The information provided herein was obtained from sources believed reliable, however, Transwestern makes no guarantees, warranties, or representations as to the completeness or accuracy thereof. The presentation of this information is submitted subject to errors, omissions, change of price or conditions, prior sale or lease, or withdrawal without notice. Copyright © 2026 Transwestern.