

**±5,000 SF
INDUSTRIAL
SPACE
FOR LEASE**

High Ceilings
and Great
Loading Access

Direct Access
to I-90 via
Elmhurst Rd.

Professionally
Owned and
Managed by:



TRANSWESTERN
REAL ESTATE
SERVICES

2515 PAN AM BOULEVARD

Elk Grove Village, IL 60007

[Property Website](#)



Specifications

- Building Size: ±30,000 SF
- Land Area: ±2.10 AC
- Available Size: ±5,000 SF
- Office Size: ±1,500 SF
- Ceiling Height: ±18'
- Loading: 1 Ext Dock / 1 DID
- Power: 400A
- Parking: ±10 Cars
- Heating: Gas
- Year Built: 1974
- Construction: Masonry
- Zoning: I-2 (General Industrial)
- RE Taxes: \$2.06 PSF (2023)
- Lease Rate: Subject to Offer

Highlights

- Very well-maintained industrial space
- Located in the DuPage County section of Elk Grove Village
- High ceilings and great loading access
- Direct access to I-90 via Elmhurst Road
- Close proximity to O'Hare International Airport
- Low DuPage County taxes
- Professionally owned and managed facility

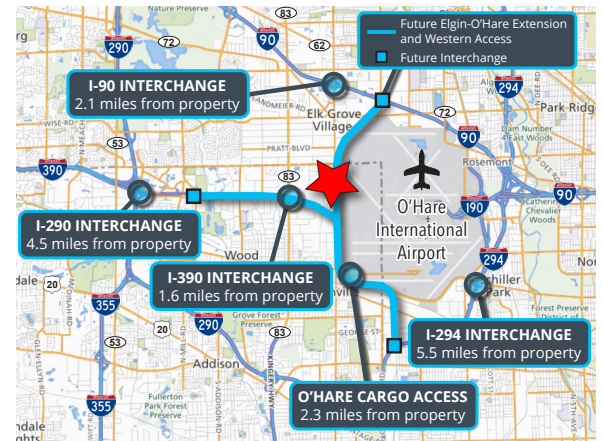

Ross Lehrman
Senior Vice President
847.588.5671
ross.lehrman@transwestern.com

Justin Lerner, SIOR
Executive Vice President
847.588.5665
justin.lerner@transwestern.com

Joe Karmin, SIOR
Executive Vice President
847.588.5670
joe.karmin@transwestern.com

The information provided herein was obtained from sources believed reliable; however, Transwestern makes no guarantees, warranties, or representations as to the completeness or accuracy thereof. The presentation of this information is submitted subject to errors, omissions, change of price or conditions, prior sale or lease, or withdrawal without notice. Copyright © 2025 Transwestern.

±5,000 SF
INDUSTRIAL
SPACE
FOR LEASE

High Ceilings
and Great
Loading Access

Direct Access
to I-90 via
Elmhurst Rd.

Professionally
Owned and
Managed by:





TRANSWESTERN
REAL ESTATE
SERVICES

2515 PAN AM BOULEVARD

Elk Grove Village, IL 60007

[Property Website](#)

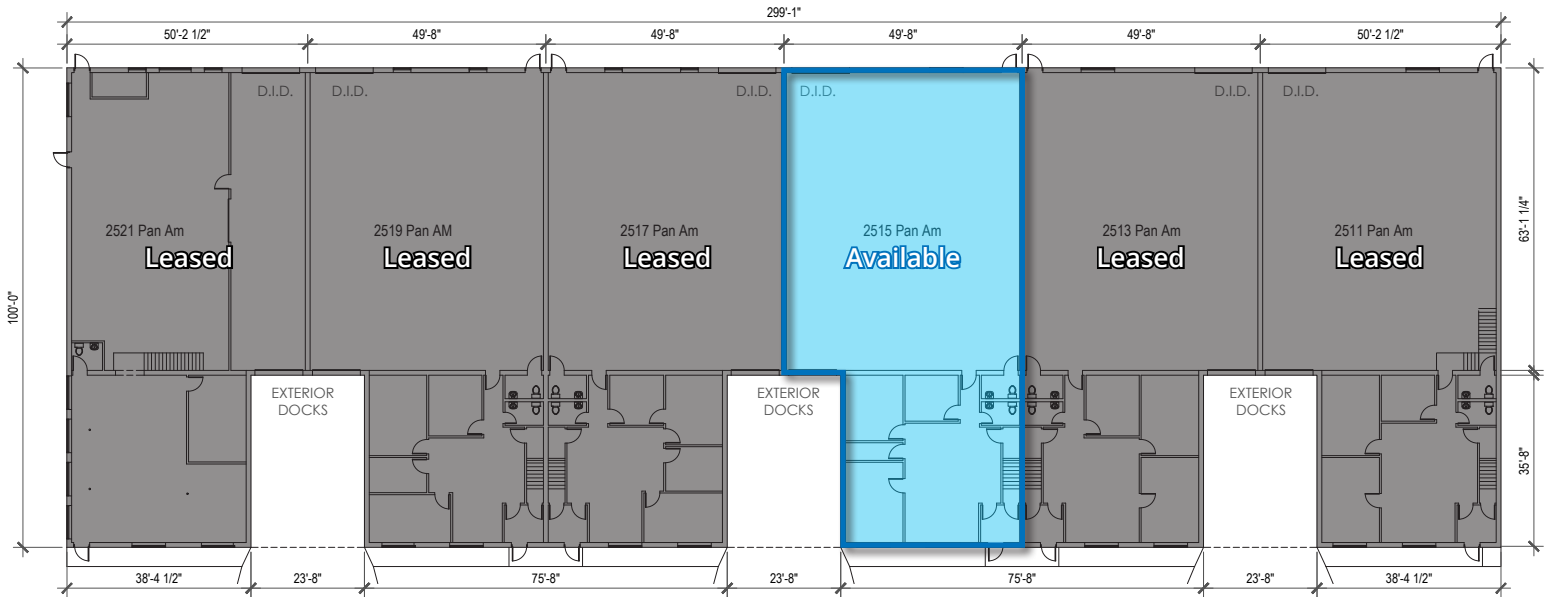
BUILDING PLAN



AERIAL VIEW



Ross Lehrman
Senior Vice President
847.588.5671
ross.lehrman@transwestern.com

Justin Lerner, SIOR
Executive Vice President
847.588.5665
justin.lerner@transwestern.com

Joe Karmin, SIOR
Executive Vice President
847.588.5670
joe.karmin@transwestern.com

The information provided herein was obtained from sources believed reliable; however, Transwestern makes no guarantees, warranties, or representations as to the completeness or accuracy thereof. The presentation of this information is submitted subject to errors, omissions, change of price or conditions, prior sale or lease, or withdrawal without notice. Copyright © 2025 Transwestern.