

**INDUSTRIAL  
BUILDING  
FOR SALE  
OR LEASE**

**±26,780 SF  
(DIVISIBLE)**

Available  
Q4 2024

Heavy  
Power



**TRANSWESTERN**

REAL ESTATE  
SERVICES

# 444 W. INTERSTATE ROAD

Addison, IL 60101

[Property Website](#)



## Specifications

- Building Size: ±26,780 SF
- Land Area: ±1.15 AC
- Divisible To: ±5,000 SF
- Office Size: ±2,500 SF
- Ceiling Height: 12' - 14' Clear
- Loading: 3 Ext Docks / 2 DID
- Power: 1200A 240V and 1200A 480V
- Parking: ±30 Cars
- Zoning: M-2 (General Mfg.)
- Year Built: 1959
- Construction: Masonry
- Heating: Gas
- **Lease Rate: Subject to Offer**
- **Sale Price: Subject to Offer**

## Highlights

- Available Q4 2024
- Very heavy power
- Addition with higher ceiling height
- Low DuPage County taxes
- Direct access to I-355 and other major expressways

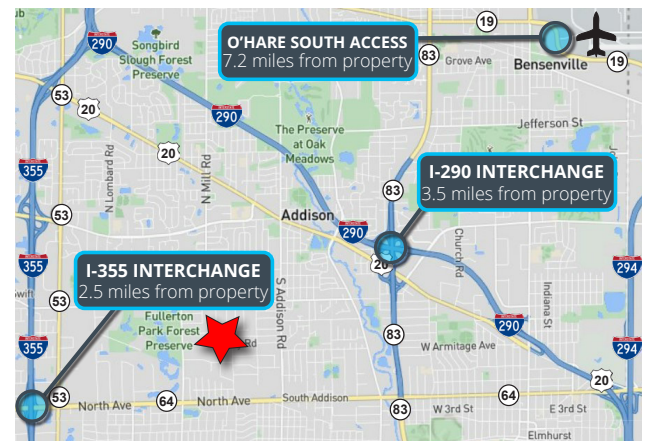

**Ross Lehrman**  
Vice President  
847.588.5671  
ross.lehrman@transwestern.com

**Joe Karmin, SIOR**  
Executive Vice President  
847.588.5670  
joe.karmin@transwestern.com

**Justin Lerner, SIOR**  
Executive Vice President  
847.588.5665  
justin.lerner@transwestern.com

The information provided herein was obtained from sources believed reliable; however, Transwestern makes no guarantees, warranties, or representations as to the completeness or accuracy thereof. The presentation of this information is submitted subject to errors, omissions, change of price or conditions, prior sale or lease, or withdrawal without notice. Copyright © 2024 Transwestern.

**INDUSTRIAL  
BUILDING  
FOR SALE  
OR LEASE**

**±26,780 SF  
(DIVISIBLE)**

Available  
Q4 2024

Heavy  
Power



**TRANSWESTERN**

REAL ESTATE  
SERVICES

# 444 W. INTERSTATE ROAD

Addison, IL 60101  
[Property Website](#)

## FLOOR PLAN

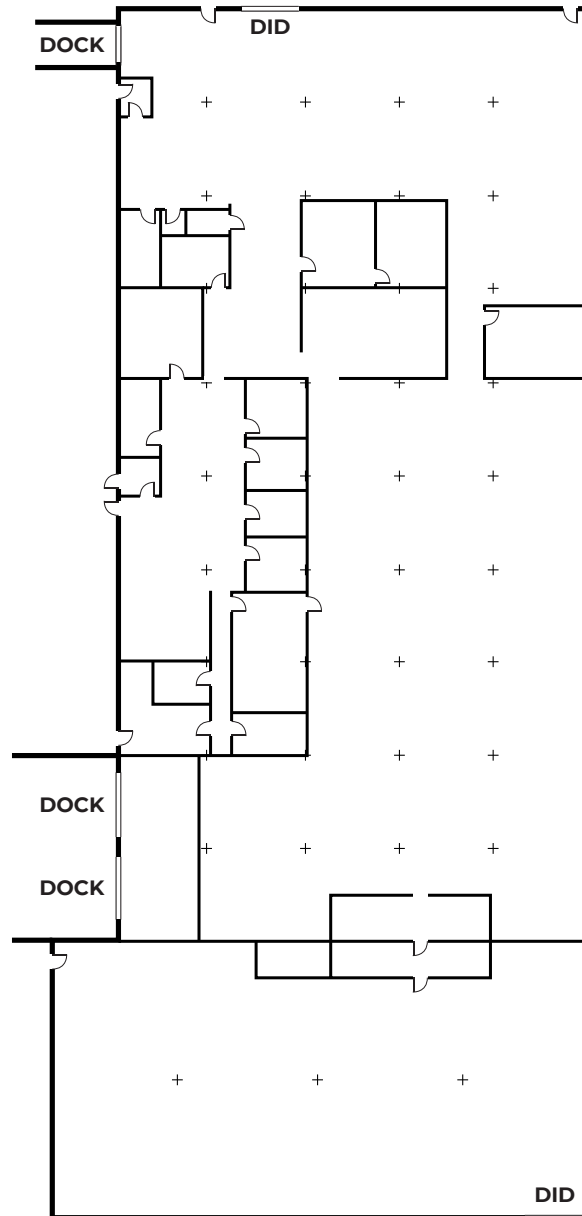

**Ross Lehrman**  
Vice President  
847.588.5671  
ross.lehrman@transwestern.com

**Joe Karmin, SIOR**  
Executive Vice President  
847.588.5670  
joe.karmin@transwestern.com

**Justin Lerner, SIOR**  
Executive Vice President  
847.588.5665  
justin.lerner@transwestern.com

The information provided herein was obtained from sources believed reliable; however, Transwestern makes no guarantees, warranties, or representations as to the completeness or accuracy thereof. The presentation of this information is submitted subject to errors, omissions, change of price or conditions, prior sale or lease, or withdrawal without notice. Copyright © 2024 Transwestern.



**INDUSTRIAL  
BUILDING  
FOR SALE  
OR LEASE**

**±26,780 SF  
(DIVISIBLE)**

Available  
Q4 2024

Heavy  
Power



**TRANSWESTERN**

REAL ESTATE  
SERVICES

# 444 W. INTERSTATE ROAD

Addison, IL 60101  
[Property Website](#)

## PROPERTY PHOTOS



**Front Southwest Outdoor Area**



**Front Southeast Loading Dock**



**Southeast Bird's Eye View**



**Aerial View**

**Ross Lehrman**  
Vice President  
847.588.5671  
ross.lehrman@transwestern.com

**Joe Karmin, SIOR**  
Executive Vice President  
847.588.5670  
joe.karmin@transwestern.com

**Justin Lerner, SIOR**  
Executive Vice President  
847.588.5665  
justin.lerner@transwestern.com

The information provided herein was obtained from sources believed reliable; however, Transwestern makes no guarantees, warranties, or representations as to the completeness or accuracy thereof. The presentation of this information is submitted subject to errors, omissions, change of price or conditions, prior sale or lease, or withdrawal without notice. Copyright © 2024 Transwestern.