

873 Cambridge Drive

INDUSTRIAL SPACE FOR SUBLEASE

873 Cambridge Dr, Elk Grove Village, IL 60007

[Property Website](#)

±15,030 SF
Available

Sublease through
February 2028

Very Well-
Maintained

Direct Access to
O'Hare via I-90



Ross Lehrman

Senior Vice President
(847) 588-5671
ross.lehrman@transwestern.com

Justin Lerner, SIOR

Executive Vice President
(847) 588-5665
justin.lerner@transwestern.com

Joe Karmin, SIOR

Executive Vice President
(847) 588-5670
joe.karmin@transwestern.com

The information provided herein was obtained from sources believed reliable, however, Transwestern makes no guarantees, warranties, or representations as to the completeness or accuracy thereof. The presentation of this information is submitted subject to errors, omissions, change of price or conditions, prior sale or lease, or withdrawal without notice. Copyright © 2026 Transwestern.

Property Highlights

- ±15,030 SF industrial space available
- Sublease through February 2028 (longer term lease options available)
- Very well-maintained
- New office finishes
- New LED lights
- Located in Regents O'Hare Business Park
- Direct access to O'Hare via I-90
- Professionally owned and managed facility



BUILDING SIZE	±67,134 SF
LAND AREA	±3.30 AC
AVAILABLE SIZE	±15,030 SF
OFFICE SIZE	±3,000 SF
CEILING HEIGHT	18' Clear
LOADING	1 Int Dock / 1 DID
PARKING	Ample
ZONING	I-1
SPRINKLERS	Wet
HEATING	Gas
CONSTRUCTION	Masonry
YEAR BUILT	1977
LEASE RATE	Subject to Offer

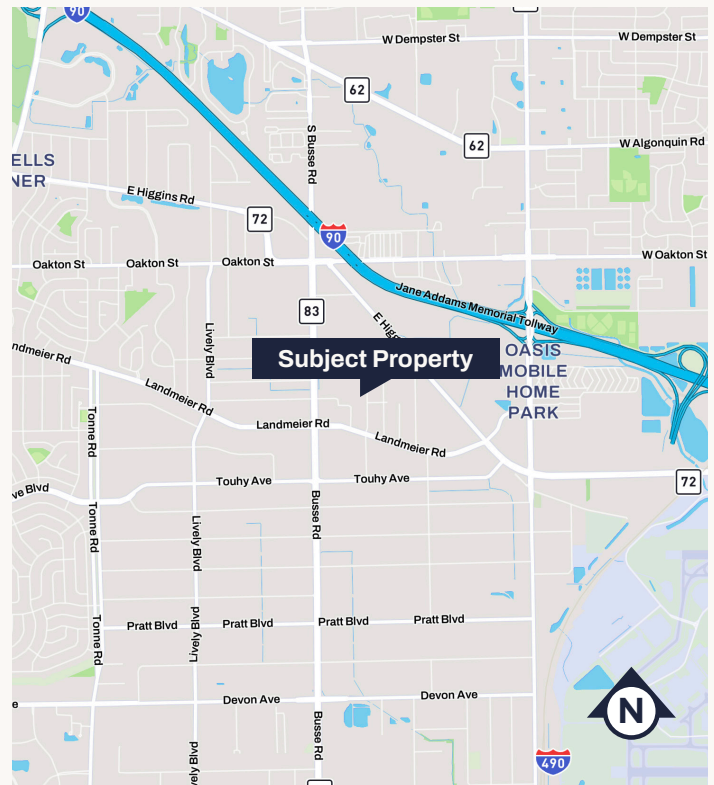

Ross Lehrman

Senior Vice President
(847) 588-5671
ross.lehrman@transwestern.com

Justin Lerner, SIOR

Executive Vice President
(847) 588-5665
justin.lerner@transwestern.com

Joe Karmin, SIOR

Executive Vice President
(847) 588-5670
joe.karmin@transwestern.com

The information provided herein was obtained from sources believed reliable; however, Transwestern makes no guarantees, warranties, or representations as to the completeness or accuracy thereof. The presentation of this information is submitted subject to errors, omissions, change of price or conditions, prior sale or lease, or withdrawal without notice. Copyright © 2026 Transwestern.

873 Cambridge Drive

INDUSTRIAL SPACE FOR SUBLEASE

873 Cambridge Dr, Elk Grove Village, IL 60007

[Property Website](#)

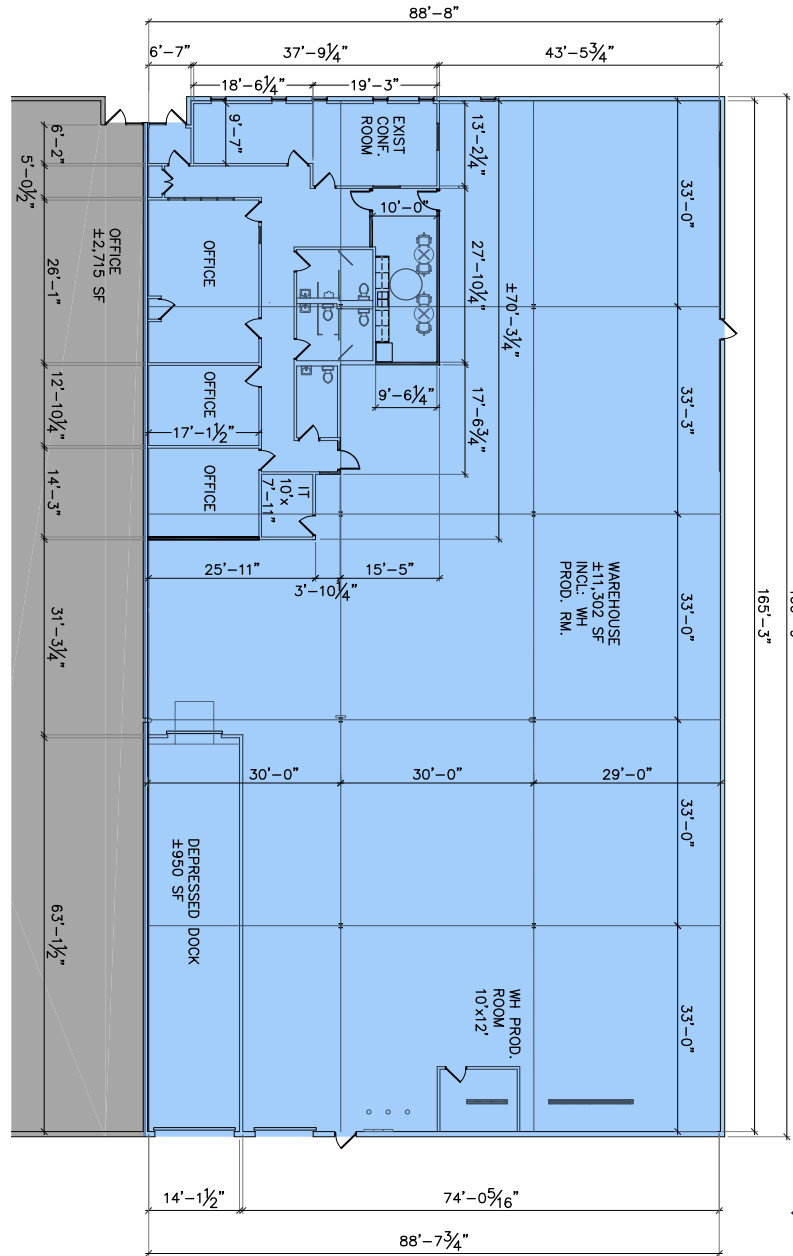

PROPOSED FLOOR PLAN

Ross Lehrman

Senior Vice President
 (847) 588-5671
ross.lehrman@transwestern.com

Justin Lerner, SIOR

Executive Vice President
 (847) 588-5665
justin.lerner@transwestern.com

Joe Karmin, SIOR

Executive Vice President
 (847) 588-5670
joe.karmin@transwestern.com

The information provided herein was obtained from sources believed reliable; however, Transwestern makes no guarantees, warranties, or representations as to the completeness or accuracy thereof. The presentation of this information is submitted subject to errors, omissions, change of price or conditions, prior sale or lease, or withdrawal without notice. Copyright © 2026 Transwestern.