

±7,570 SF  
**INDUSTRIAL  
SPACE  
FOR LEASE**

Well-maintained  
Building

Direct Access  
to I-90 and  
O'Hare Airport

Institutionally  
Owned and  
Managed by:



  
**TRANSWESTERN**  
REAL ESTATE  
SERVICES

# 1100 HOWARD STREET

Elk Grove Village, IL 60007

[Property Website](#)



## Specifications

- Building Size: ±23,500 SF
- Land Area: ±1.31 AC
- Available Size: ±7,570 SF
- Office Size: ±2,058 SF
- Ceiling Height: 14'
- Loading: 1 Ext Dock / 1 DID
- Power: 200A
- Parking: ±10 Cars
- Zoning: I-1
- Year Built: 1978
- Construction: Masonry
- **Lease Rate: Subject to Offer**

## Highlights

- Well-maintained building
- Located in the epicenter of the prestigious Elk Grove Village submarket
- Direct access to I-90 and O'Hare
- Institutionally owned and managed

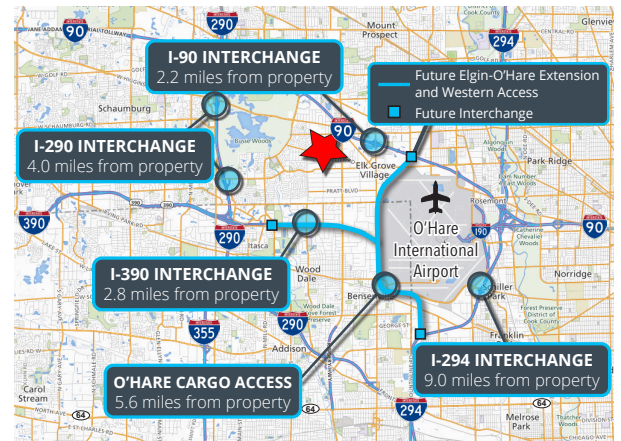

**Ross Lehrman**  
Senior Vice President  
847.588.5671  
[ross.lehrman@transwestern.com](mailto:ross.lehrman@transwestern.com)

**Joe Karmin, SIOR**  
Executive Vice President  
847.588.5670  
[joe.karmin@transwestern.com](mailto:joe.karmin@transwestern.com)

**Justin Lerner, SIOR**  
Executive Vice President  
847.588.5665  
[justin.lerner@transwestern.com](mailto:justin.lerner@transwestern.com)

The information provided herein was obtained from sources believed reliable; however, Transwestern makes no guarantees, warranties, or representations as to the completeness or accuracy thereof. The presentation of this information is submitted subject to errors, omissions, change of price or conditions, prior sale or lease, or withdrawal without notice. Copyright © 2025 Transwestern.

±7,570 SF  
INDUSTRIAL  
SPACE  
FOR LEASE

Well-maintained  
Building

Direct Access  
to I-90 and  
O'Hare Airport

Institutionally  
Owned and  
Managed by:



  
TRANSWESTERN  
REAL ESTATE  
SERVICES

# 1100 HOWARD STREET

Elk Grove Village, IL 60007

[Property Website](#)

## BUILDING PLAN

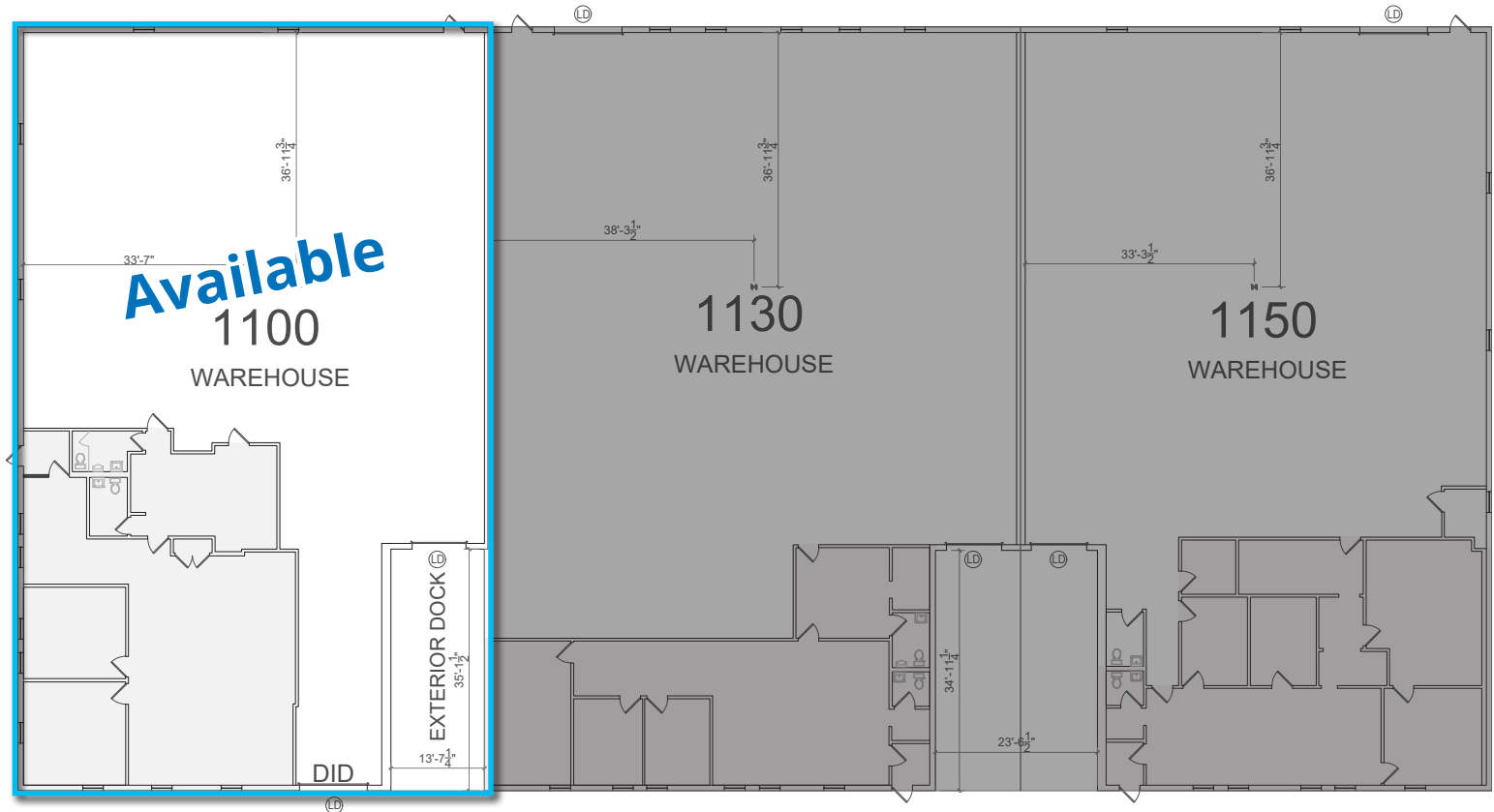

**Ross Lehrman**  
Senior Vice President  
847.588.5671  
ross.lehrman@transwestern.com

**Joe Karmin, SIOR**  
Executive Vice President  
847.588.5670  
joe.karmin@transwestern.com

**Justin Lerner, SIOR**  
Executive Vice President  
847.588.5665  
justin.lerner@transwestern.com

The information provided herein was obtained from sources believed reliable; however, Transwestern makes no guarantees, warranties, or representations as to the completeness or accuracy thereof. The presentation of this information is submitted subject to errors, omissions, change of price or conditions, prior sale or lease, or withdrawal without notice. Copyright © 2025 Transwestern.