

±15,323 SF
**INDUSTRIAL
SPACE
FOR LEASE**

Well-maintained
Precast Facility

Immediate
Access to I-355

Institutional
Ownership

AGELLAN
COMMERCIAL REIT

TRANSWESTERN
REAL ESTATE
SERVICES

2008 BLOOMINGDALE ROAD

Glendale Heights, IL 60139

[Property Website](#)



Specifications:

- Building Size: ±31,919 SF
- Available Size: ±15,323 SF
- Office Size: ±3,690 SF
- Ceiling Height: ±21'
- Loading: 1 Int Dock / 2 DID
- Power: 400-800 Amps
- Parking: ±28 Cars
- Year Built: 2000
- Construction: Precast
- CAM: \$1.98 PSF (2024 Est)
- RET: \$2.61 PSF (2024 Est)
- **Lease Rate: Subject to Offer**

Highlights:

- Available 10/1/2024
- ±16,596 SF potentially available (up to full ±31,919 SF building)
- Institutional ownership
- Professionally managed
- Well-maintained facility
- Building signage along Bloomingdale Road
- LED lights in warehouse
- Immediate access to I-355 via Army Trail Rd.
- Low DuPage County taxes

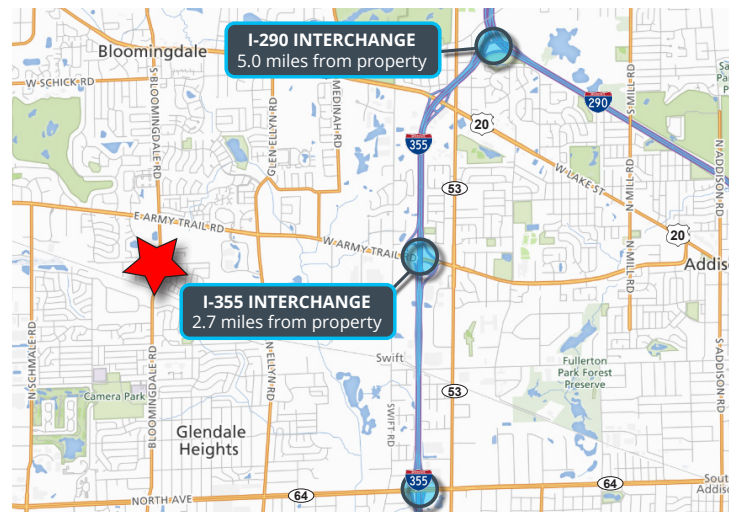

Michael Marconi, SIOR
Sr. EVP & Designated Managing Broker
847.588.5689
michael.marconi@transwestern.com

Marko Kaplarevic
Associate
708.819.2227
marko.kaplarevic@transwestern.com

The information provided herein was obtained from sources believed reliable; however, Transwestern makes no guarantees, warranties, or representations as to the completeness or accuracy thereof. The presentation of this information is submitted subject to errors, omissions, change of price or conditions, prior sale or lease, or withdrawal without notice. Copyright © 2024 Transwestern.

**±15,323 SF
INDUSTRIAL
SPACE
FOR LEASE**

Well-maintained
Precast Facility

Immediate
Access to I-355

Institutional
Ownership

AGELLAN
COMMERCIAL REIT

TRANSWESTERN
REAL ESTATE
SERVICES

2008 BLOOMINGDALE ROAD

Glendale Heights, IL 60139

[Property Website](#)

BUILDING LAYOUT

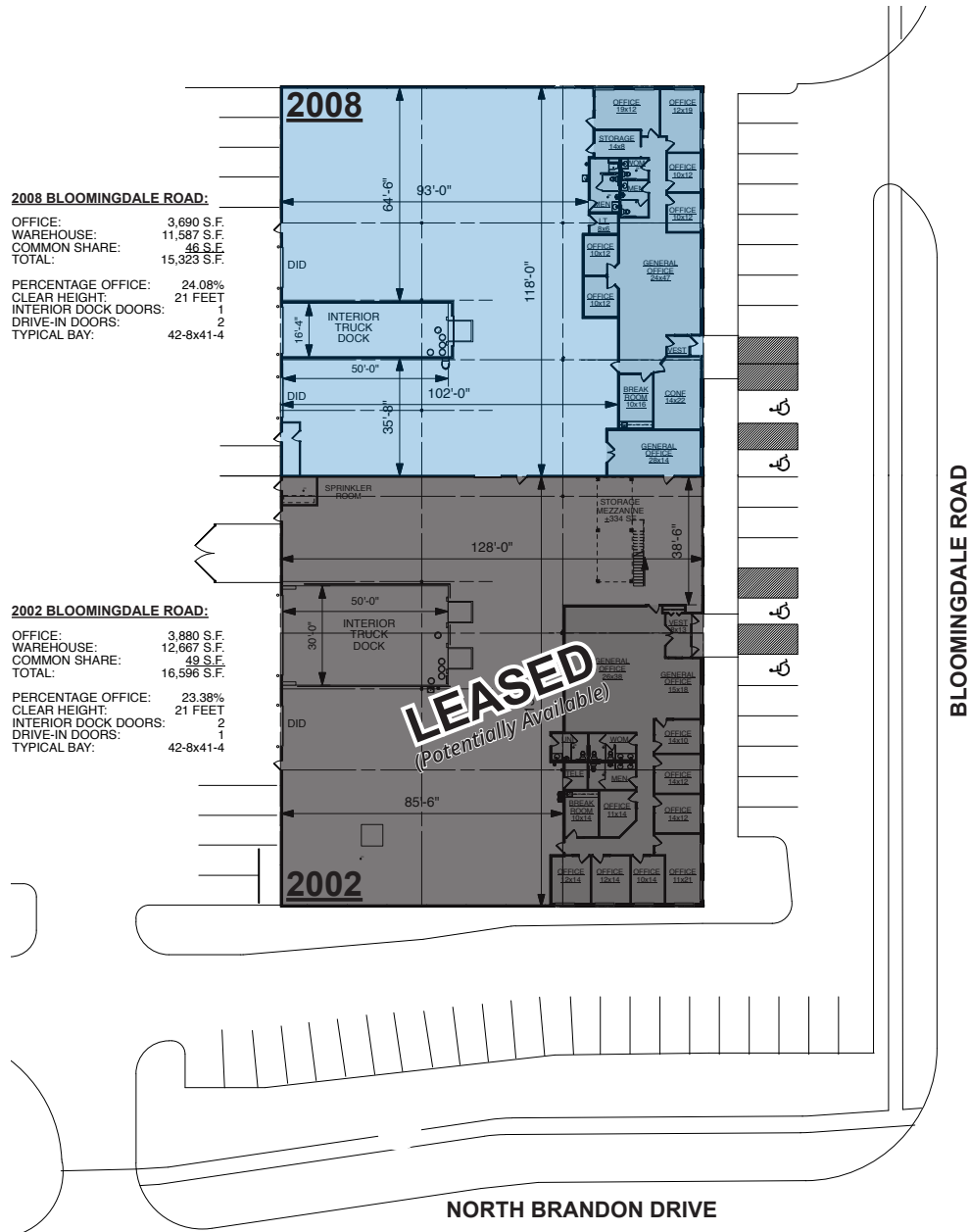

Michael Marconi, SIOR
 Sr. EVP & Designated Managing Broker
 847.588.5689
 michael.marconi@transwestern.com

Marko Kaplarevic
 Associate
 708.819.2227
 marko.kaplarevic@transwestern.com

The information provided herein was obtained from sources believed reliable; however, Transwestern makes no guarantees, warranties, or representations as to the completeness or accuracy thereof. The presentation of this information is submitted subject to errors, omissions, change of price or conditions, prior sale or lease, or withdrawal without notice. Copyright © 2024 Transwestern.