

±46,559 SF
INDUSTRIAL
BUILDING FOR
SUBLEASE

Sublease
Through
4/30/2028

Flexible
Deal
Terms

High-Image
Standalone
Facility

TRANSWESTERN
REAL ESTATE
SERVICES

865 MUIRFIELD DRIVE

Hanover Park, IL 60133

[Property Website](#)



SPECIFICATIONS

- Building Size: ±46,559 SF
- Land Area: ±3.28 AC
- Office Size: ±7,272 SF
- Ceiling Height: 24'
- Loading: 4 Ext Docks / 1 DID
- Power: 800A 480V
- Parking: ±92 Cars
- Sprinklers: Yes
- Heating: Gas
- Year Built: 1993
- Construction: Precast
- **Sublease Rate: \$11.25 PSF MG**

HIGHLIGHTS

- Sublease available through 4/30/2028
- Flexible deal terms
- High-image, standalone facility
- Recently upgraded power
- Abundant parking
- Two mezzanine areas
- Expanded in 1999
- Zoned I (Industrial)
- Close proximity to I-390 (Elgin-O'Hare Tollway)

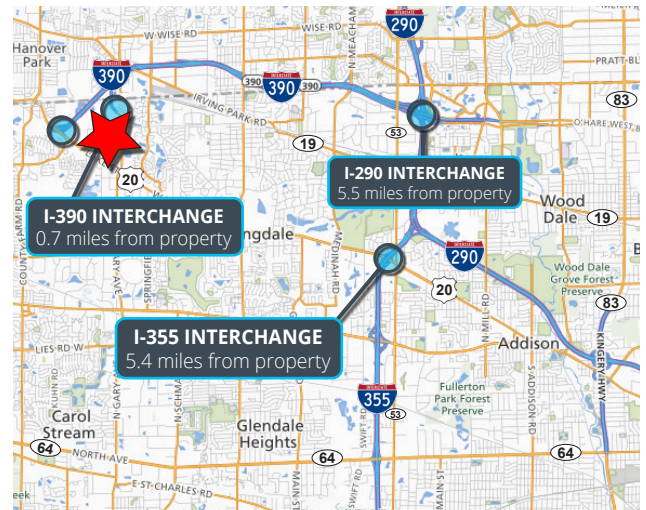

Joe Karmin, SIOR
Executive Vice President
847.588.5670
joe.karmin@transwestern.com

Michael Marconi, SIOR
Sr. EVP & Designated Managing Broker
847.588.5689
michael.marconi@transwestern.com

The information provided herein was obtained from sources believed reliable; however, Transwestern makes no guarantees, warranties, or representations as to the completeness or accuracy thereof. The presentation of this information is submitted subject to errors, omissions, change of price or conditions, prior sale or lease, or withdrawal without notice. Copyright © 2025 Transwestern.

±46,559 SF
INDUSTRIAL
BUILDING FOR
SUBLEASE

Sublease
Through
4/30/2028

Flexible
Deal
Terms

High-Image
Standalone
Facility



TRANSWESTERN

REAL ESTATE
SERVICES

865 MUIRFIELD DRIVE

Hanover Park, IL 60133

[Property Website](#)

SITE PLAN

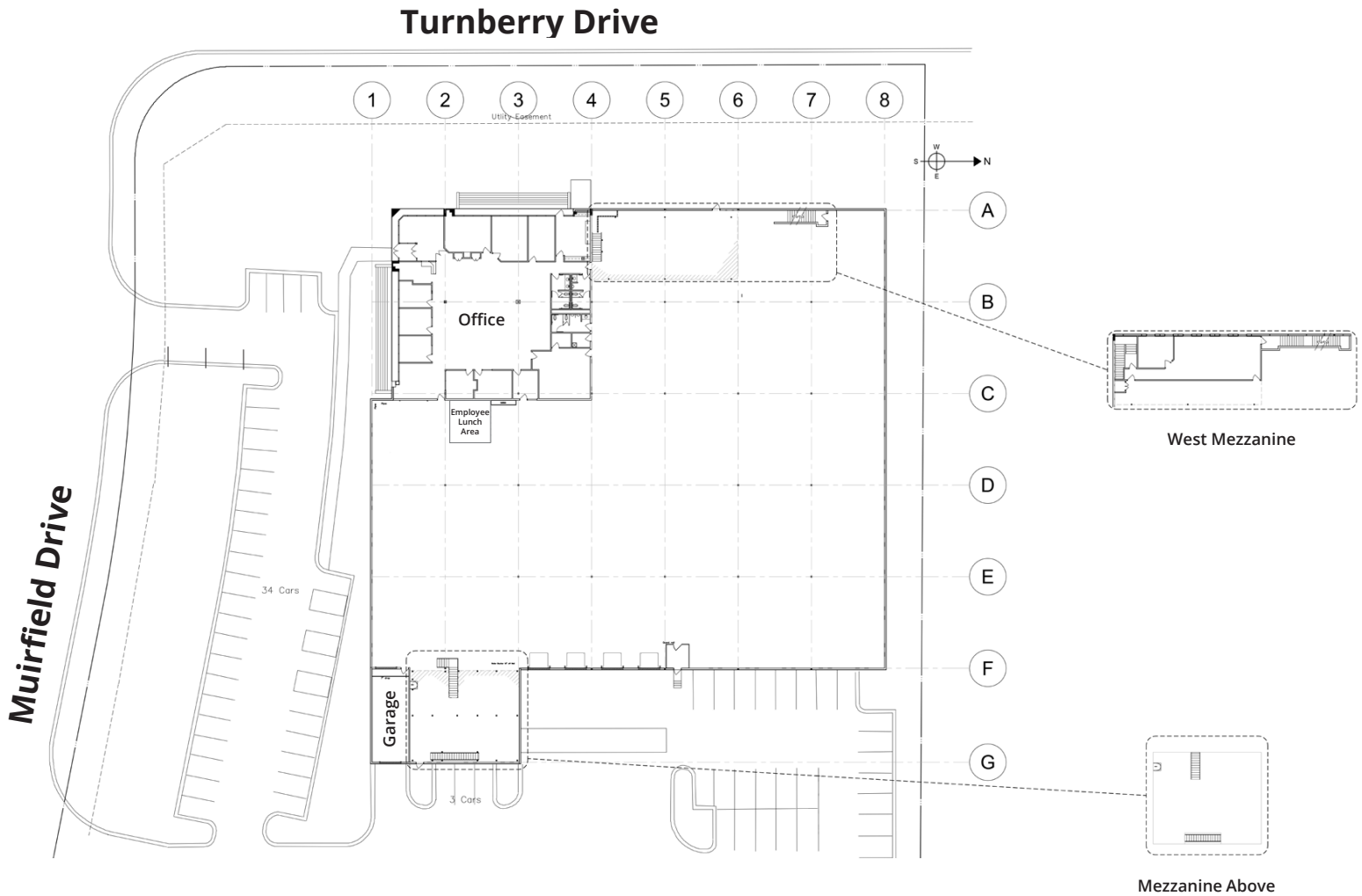

Joe Karmin, SIOR
Executive Vice President
847.588.5670
joe.karmin@transwestern.com

Michael Marconi, SIOR
Sr. EVP & Designated Managing Broker
847.588.5689
michael.marconi@transwestern.com

The information provided herein was obtained from sources believed reliable; however, Transwestern makes no guarantees, warranties, or representations as to the completeness or accuracy thereof. The presentation of this information is submitted subject to errors, omissions, change of price or conditions, prior sale or lease, or withdrawal without notice. Copyright © 2025 Transwestern.

**±46,559 SF
INDUSTRIAL
BUILDING FOR
SUBLEASE**

Sublease
Through
4/30/2028

Flexible
Deal
Terms

High-Image
Standalone
Facility



TRANSWESTERN

REAL ESTATE
SERVICES

865 MUIRFIELD DRIVE

Hanover Park, IL 60133

[Property Website](#)

PROPERTY PHOTOS



DRIVE-IN DOOR



LOADING DOCKS



BIRD'S EYE VIEW



AERIAL VIEW

Joe Karmin, SIOR
Executive Vice President
847.588.5670
joe.karmin@transwestern.com

Michael Marconi, SIOR
Sr. EVP & Designated Managing Broker
847.588.5689
michael.marconi@transwestern.com

The information provided herein was obtained from sources believed reliable; however, Transwestern makes no guarantees, warranties, or representations as to the completeness or accuracy thereof. The presentation of this information is submitted subject to errors, omissions, change of price or conditions, prior sale or lease, or withdrawal without notice. Copyright © 2025 Transwestern.