

# 800-810 Bonnie Lane

±13,877 SF (DIVISIBLE) INDUSTRIAL BUILDING FOR LEASE

800-810 Bonnie Ln, Elk Grove Village, IL 60007

[Property Website](#)

Divisible to  
±6,938 SF

Under New  
Ownership

Make-readies  
Underway

Excellent Loading  
Dock & DID Access



**Ross Lehrman**

Senior Vice President  
(847) 588-5671  
[ross.lehrman@transwestern.com](mailto:ross.lehrman@transwestern.com)

**Joe Karmin, SIOR**

Executive Vice President  
(847) 588-5670  
[joe.karmin@transwestern.com](mailto:joe.karmin@transwestern.com)

**Justin Lerner, SIOR**

Executive Vice President  
(847) 588-5665  
[justin.lerner@transwestern.com](mailto:justin.lerner@transwestern.com)

The information provided herein was obtained from sources believed reliable; however, Transwestern makes no guarantees, warranties, or representations as to the completeness or accuracy thereof. The presentation of this information is submitted subject to errors, omissions, change of price or conditions, prior sale or lease, or withdrawal without notice. Copyright © 2026 Transwestern.

# Property Highlights

- Under new ownership with make-ready improvements underway!
- Building can be divided into ±6,938 SF units with ±1,000 SF of office, 1 interior dock, and 1 DID in each (unit 810 has a total of 2 drive-in doors)
- Direct access to major expressways
- Close proximity to O'Hare Airport
- Located epicenter of Elk Grove Industrial Park



<b>BUILDING SIZE</b>	<b>±13,877 SF</b>
<b>LAND AREA</b>	<b>±0.61 AC</b>
<b>DIVISIBLE TO</b>	<b>±6,938 SF</b>
<b>OFFICE SIZE</b>	<b>±2,000 SF</b>
<b>CEILING HEIGHT</b>	<b>16'</b>
<b>LOADING</b>	<b>2 Int Docks / 3 DID</b>
<b>POWER</b>	<b>400A</b>
<b>PARKING</b>	<b>±15 Spaces</b>
<b>HEATING</b>	<b>Gas</b>
<b>ZONING</b>	<b>I-1</b>
<b>YEAR BUILT</b>	<b>1974</b>
<b>CONSTRUCTION</b>	<b>Masonry</b>
<b>LEASE RATE</b>	<b>Subject to Offer</b>

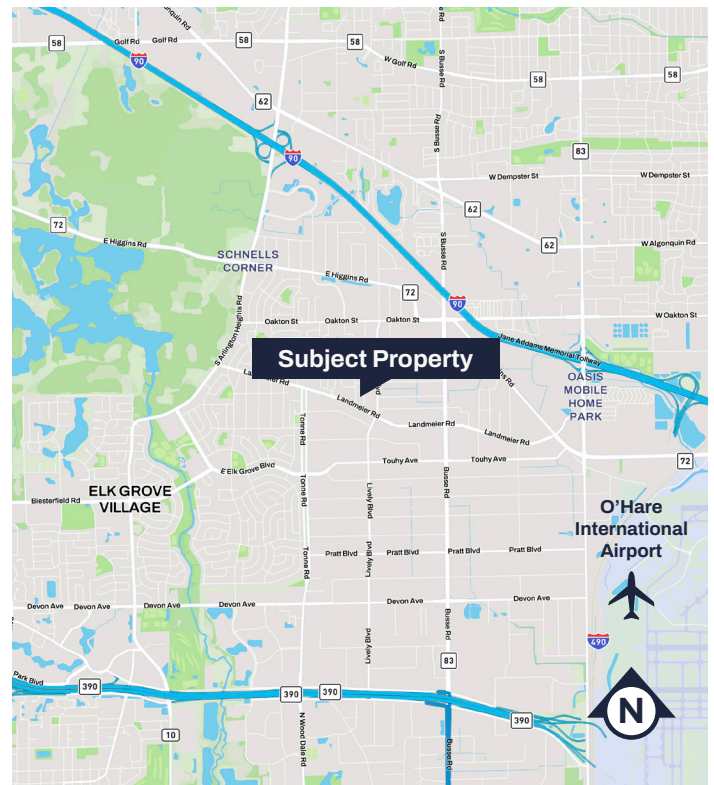

**Ross Lehrman**  
 Senior Vice President  
 (847) 588-5671  
 ross.lehrman@transwestern.com

**Joe Karmin, SIOR**  
 Executive Vice President  
 (847) 588-5670  
 joe.karmin@transwestern.com

**Justin Lerner, SIOR**  
 Executive Vice President  
 (847) 588-5665  
 justin.lerner@transwestern.com

The information provided herein was obtained from sources believed reliable; however, Transwestern makes no guarantees, warranties, or representations as to the completeness or accuracy thereof. The presentation of this information is submitted subject to errors, omissions, change of price or conditions, prior sale or lease, or withdrawal without notice. Copyright © 2026 Transwestern.

# 800-810 Bonnie Lane

±13,877 SF (DIVISIBLE) INDUSTRIAL BUILDING FOR LEASE

800 Bonnie Ln, Elk Grove Village, IL 60007

[Property Website](#)



UNIT 800 DRIVE-IN DOOR



UNIT 810 DRIVE-IN DOOR

Ross Lehrman

Senior Vice President  
(847) 588-5671  
[ross.lehrman@transwestern.com](mailto:ross.lehrman@transwestern.com)

Joe Karmin, SIOR

Executive Vice President  
(847) 588-5670  
[joe.karmin@transwestern.com](mailto:joe.karmin@transwestern.com)

Justin Lerner, SIOR

Executive Vice President  
(847) 588-5665  
[justin.lerner@transwestern.com](mailto:justin.lerner@transwestern.com)

The information provided herein was obtained from sources believed reliable; however, Transwestern makes no guarantees, warranties, or representations as to the completeness or accuracy thereof. The presentation of this information is submitted subject to errors, omissions, change of price or conditions, prior sale or lease, or withdrawal without notice. Copyright © 2026 Transwestern.

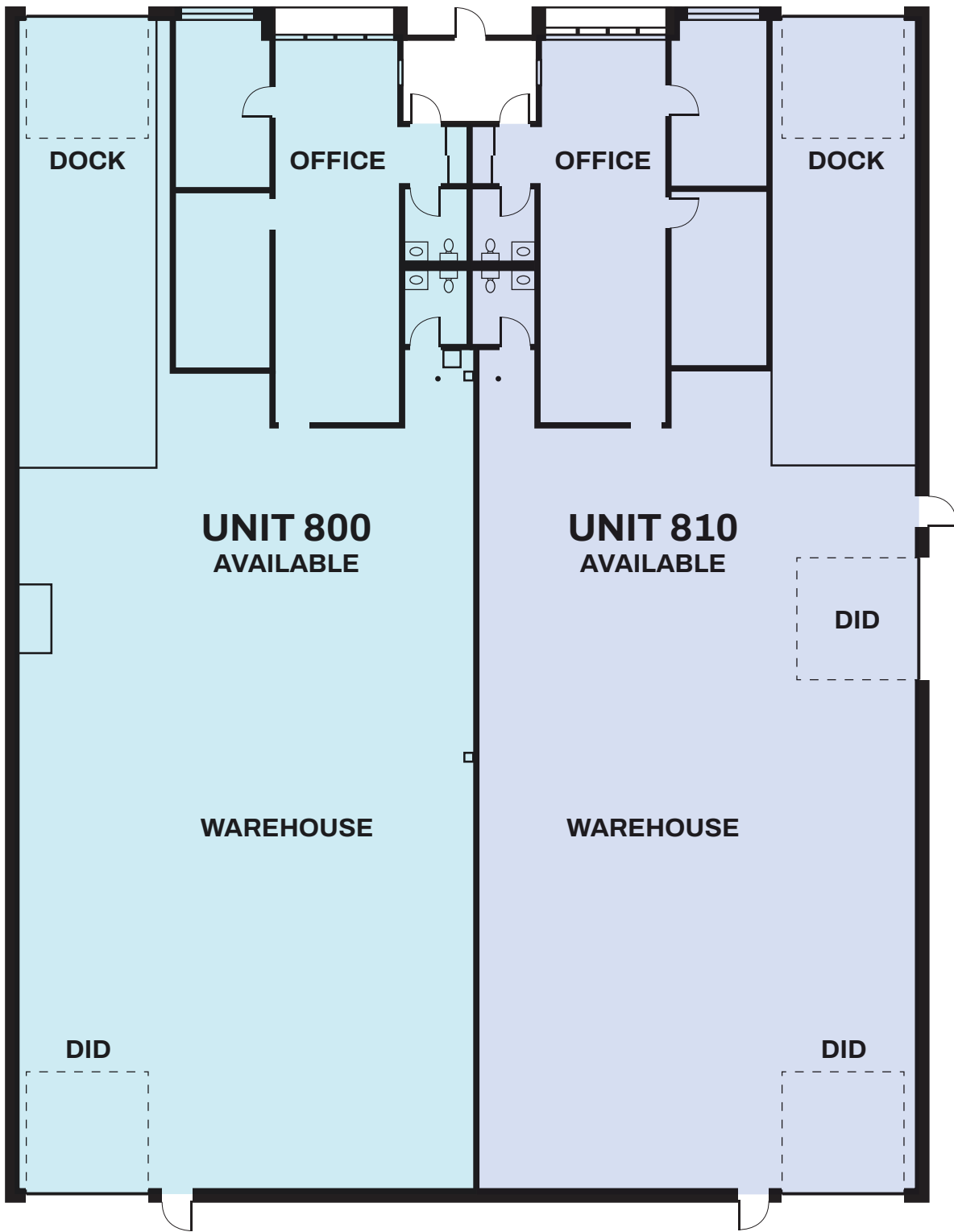

**FLOOR PLAN**



**Ross Lehrman**

Senior Vice President  
 (847) 588-5671  
[ross.lehrman@transwestern.com](mailto:ross.lehrman@transwestern.com)

**Joe Karmin, SIOR**

Executive Vice President  
 (847) 588-5670  
[joe.karmin@transwestern.com](mailto:joe.karmin@transwestern.com)

**Justin Lerner, SIOR**

Executive Vice President  
 (847) 588-5665  
[justin.lerner@transwestern.com](mailto:justin.lerner@transwestern.com)

The information provided herein was obtained from sources believed reliable; however, Transwestern makes no guarantees, warranties, or representations as to the completeness or accuracy thereof. The presentation of this information is submitted subject to errors, omissions, change of price or conditions, prior sale or lease, or withdrawal without notice. Copyright © 2026 Transwestern.