

143 Bernice Drive

INDUSTRIAL SPACE FOR LEASE

141-145 Bernice Dr, Bensenville, IL 60106

[Property Website](#)

±2,925 SF
Available

Well-maintained
Corner Unit

Direct Access to
Major Expressways

Professionally
Owned & Managed



Ross Lehrman

Senior Vice President
(847) 588-5671
ross.lehrman@transwestern.com

Joe Karmin, SIOR

Executive Vice President
(847) 588-5670
joe.karmin@transwestern.com

Justin Lerner, SIOR

Executive Vice President
(847) 588-5665
justin.lerner@transwestern.com

The information provided herein was obtained from sources believed reliable; however, Transwestern makes no guarantees, warranties, or representations as to the completeness or accuracy thereof. The presentation of this information is submitted subject to errors, omissions, change of price or conditions, prior sale or lease, or withdrawal without notice. Copyright © 2026 Transwestern.

Property Highlights

- ±2,925 SF industrial space for lease
- Well-maintained corner unit
- Direct access to major expressways
- Close proximity to O'Hare International Airport
- Low DuPage County taxes
- Professionally owned and managed facility



BUILDING SIZE	±11,700 SF
LAND AREA	±0.84 AC
AVAILABLE SIZE	±2,925 SF
OFFICE SIZE	±1,129 SF
CEILING HEIGHT	14'
LOADING	1 Drive-in Door
POWER	200 Amps
PARKING	9 Cars
YEAR BUILT	1984
CONSTRUCTION	Masonry
LEASE RATE	Subject to Offer

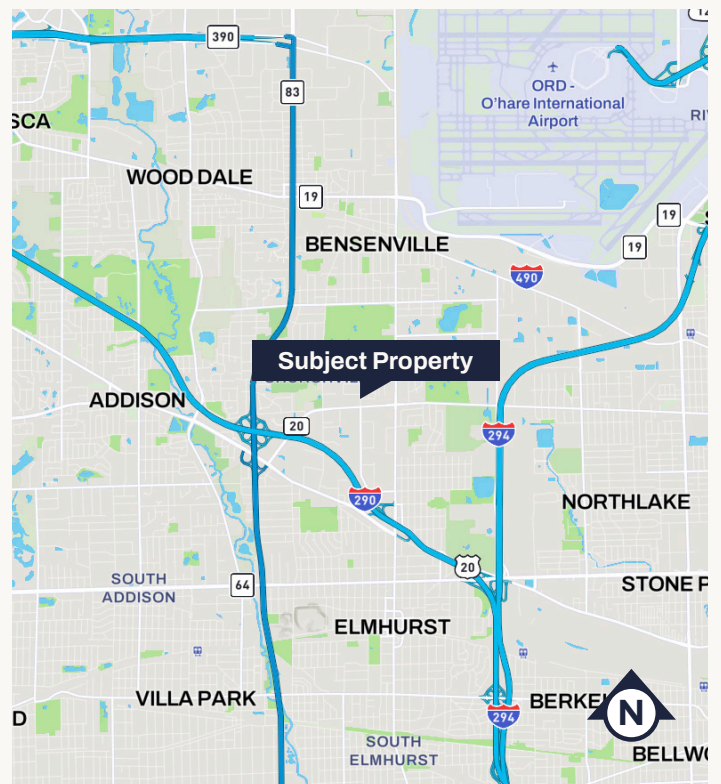

Ross Lehrman

Senior Vice President
(847) 588-5671
ross.lehrman@transwestern.com

Joe Karmin, SIOR

Executive Vice President
(847) 588-5670
joe.karmin@transwestern.com

Justin Lerner, SIOR

Executive Vice President
(847) 588-5665
justin.lerner@transwestern.com



The information provided herein was obtained from sources believed reliable; however, Transwestern makes no guarantees, warranties, or representations as to the completeness or accuracy thereof. The presentation of this information is submitted subject to errors, omissions, change of price or conditions, prior sale or lease, or withdrawal without notice. Copyright © 2026 Transwestern.

143 Bernice Drive

INDUSTRIAL SPACE FOR LEASE

141-145 Bernice Dr, Bensenville, IL 60106

[Property Website](#)

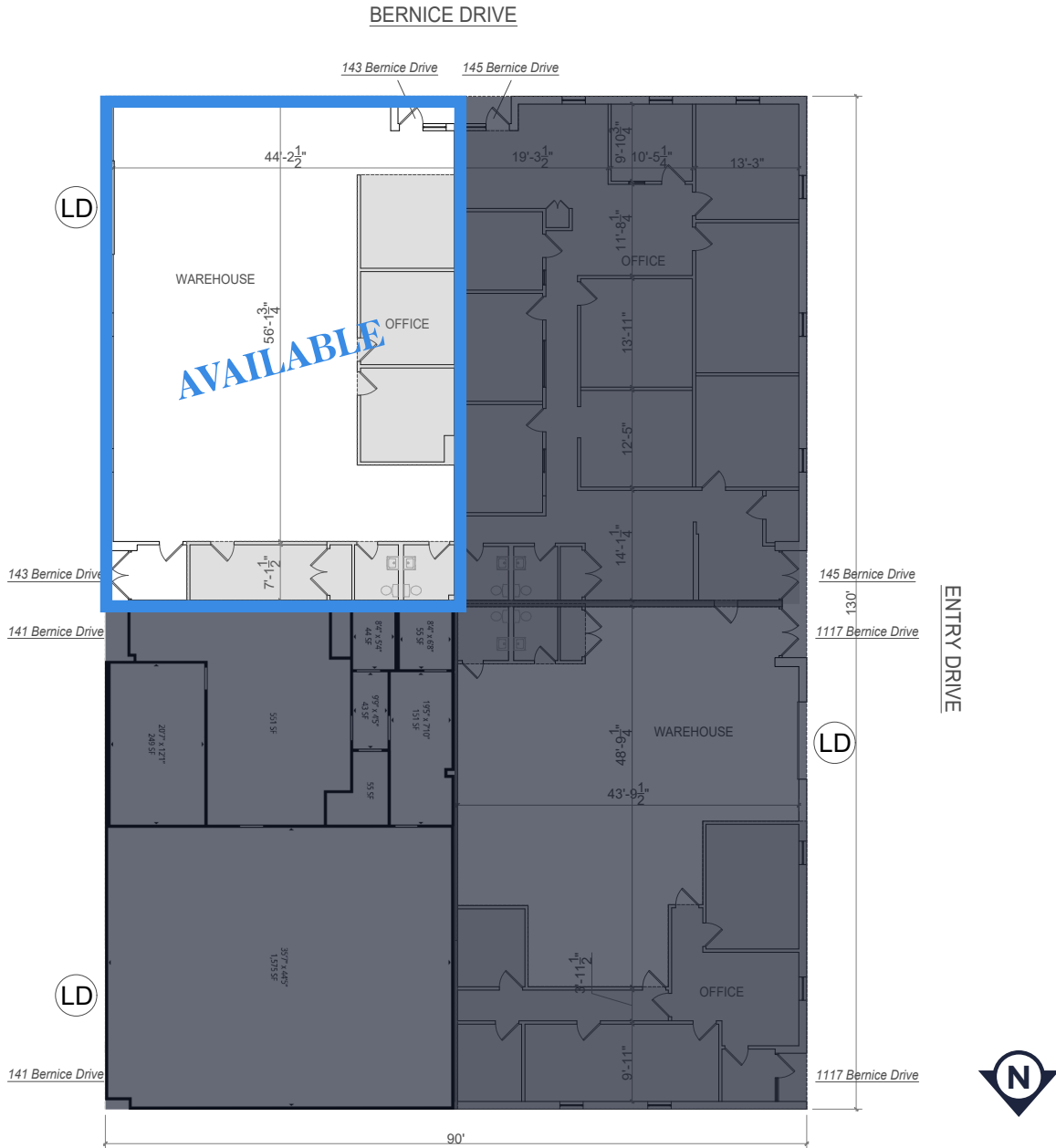

FLOOR PLAN

Ross Lehrman
Senior Vice President
(847) 588-5671
ross.lehrman@transwestern.com

Joe Karmin, SIOR
Executive Vice President
(847) 588-5670
joe.karmin@transwestern.com

Justin Lerner, SIOR
Executive Vice President
(847) 588-5665
justin.lerner@transwestern.com

The information provided herein was obtained from sources believed reliable, however, Transwestern makes no guarantees, warranties, or representations as to the completeness or accuracy thereof. The presentation of this information is submitted subject to errors, omissions, change of price or conditions, prior sale or lease, or withdrawal without notice. Copyright © 2026 Transwestern.