

±31,919 SF  
INDUSTRIAL  
BUILDING  
FOR LEASE

DIVISIBLE  
TO ±15,323 SF  
& ±16,596 SF

Tenant  
Incentive  
Available!

Institutionally  
Owned &  
Professionally  
Managed

**AGELLAN**  
COMMERCIAL REIT

**TRANSWESTERN**  
REAL ESTATE  
SERVICES

# 2002-2008 BLOOMINGDALE ROAD

Glendale Heights, IL 60139

[Property Website](#)



**TENANT INCENTIVE: First 3 Months Net Free on a Qualified Deal\***

*\*Qualified Deal must be a minimum 5-year lease signed by December 31, 2024*

## Specifications

- Building Size: ±31,919 SF
  - Unit 2002: ±16,596 SF
  - Unit 2008: ±15,323 SF
- Office Size: ±7,570 SF
  - Unit 2002: ±3,880 SF
  - Unit 2008: ±3,690 SF
- Loading: 3 Docks / 3 DID
  - Unit 2002: 2 Docks / 1 DID
  - Unit 2008: 1 Dock / 2 DID
- Ceiling Height: ±21'
- Power: 400 Amps
- Parking: ±52 Cars
- Year Built: 2000
- Construction: Precast

## Highlights

- Well-maintained facility
- LED lights in warehouse
- Building signage along Bloomingdale Road
- Immediate access to I-355 via Army Trail Road
- Low DuPage County taxes
- Institutionally owned and professionally managed

## Pricing

- CAM: \$1.98 PSF (2024 Est)
- RET: \$2.61 PSF (2024 Est)
- Lease Rate: Subject to Offer**

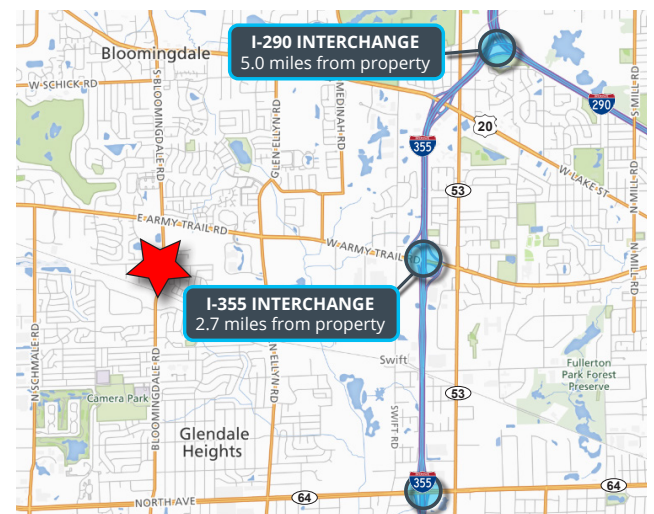

**Michael Marconi, SIOR**  
Sr. EVP & Designated Managing Broker  
847.588.5689  
michael.marconi@transwestern.com

**Marko Kaplarevic**  
Associate  
708.819.2227  
marko.kaplarevic@transwestern.com

The information provided herein was obtained from sources believed reliable; however, Transwestern makes no guarantees, warranties, or representations as to the completeness or accuracy thereof. The presentation of this information is submitted subject to errors, omissions, change of price or conditions, prior sale or lease, or withdrawal without notice. Copyright © 2024 Transwestern.

**±31,919 SF  
INDUSTRIAL  
BUILDING  
FOR LEASE**

**DIVISIBLE  
TO ±15,323 SF  
& ±16,596 SF**

Tenant  
Incentive  
Available!

Institutionally  
Owned &  
Professionally  
Managed

**AGELLAN**  
COMMERCIAL REIT

**TRANSWESTERN**  
REAL ESTATE  
SERVICES

# 2002-2008 BLOOMINGDALE ROAD

Glendale Heights, IL 60139

[Property Website](#)

## BUILDING LAYOUT

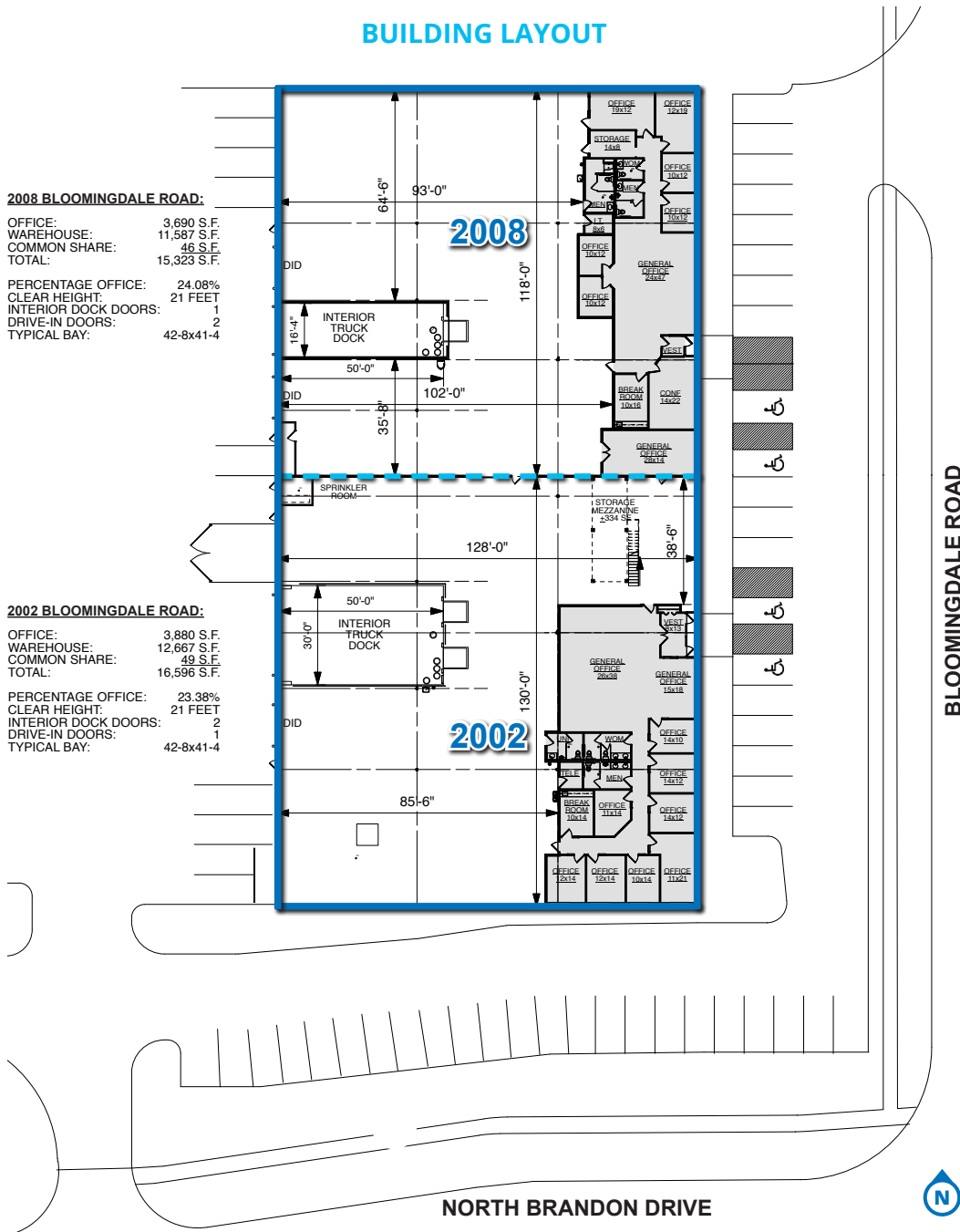

**Michael Marconi, SIOR**  
Sr. EVP & Designated Managing Broker  
847.588.5689  
michael.marconi@transwestern.com

**Marko Kaplarevic**  
Associate  
708.819.2227  
marko.kaplarevic@transwestern.com

The information provided herein was obtained from sources believed reliable; however, Transwestern makes no guarantees, warranties, or representations as to the completeness or accuracy thereof. The presentation of this information is submitted subject to errors, omissions, change of price or conditions, prior sale or lease, or withdrawal without notice. Copyright © 2024 Transwestern.