

# For Lease

## Yorkbrook Business Park

Eisenhower Lane  
Lombard, IL



**\* Also Available for Sale**

BUILDING	UNIT	AVAILABLE SF	OFFICE SF	CLEAR HEIGHT	LOADING
50-88	<u>52</u>	5,400	2,272	15'	1 Dock
50-88	<u>76</u>	2,672	503	15'	1 DID
50-88	<u>78</u>	6,038	5,810	15'	1 DID
50-88	<u>84</u>	5,455	930	15'	1 Dock / 1 DID
51-87	<u>55</u>	4,562	0	15'	1 Dock / 1 DID
51-87	<u>71</u>	9,050	3,350	15'	1 Dock / 1 DID
120-157	<u>144</u>	4,167	563	16'	1 DID
121-158	<u>121</u>	2,070	902	15'	1 DID
121-158	<u>130</u>	2,070	324	15'	1 DID
201-235	<u>211A</u>	2,283	428	15'	1 DID
201-235	<u>219</u>	15,740	6,250	15'	2 Docks / 2 DID
400-420*	<u>400</u>	16,068	13,009 / 4,410	9'	None
401-419*	<u>419</u>	9,600	9,292 / 3,490	14'	None
421-449*	<u>421</u>	7,989	6,227 / 3,454	13'	3 DID
421-449*	<u>435</u>	2,669	1,196	13'	1 DID
421-449*	<u>421-435</u>	10,658	7,423	13'	4 DID
455*	<u>455</u>	25,416	25,416	10'	None

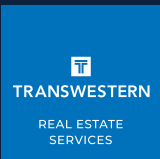

**JUSTIN  
LERNER, SIOR**

EXECUTIVE VICE PRESIDENT  
justin.lerner@transwestern.com  
847.588.5665

**JOE  
KARMIN, SIOR**

EXECUTIVE VICE PRESIDENT  
joe.karmin@transwestern.com  
847.588.5670

**ROSS  
LEHRMAN**

SENIOR VICE PRESIDENT  
ross.lehrman@transwestern.com  
847.588.5671

No warranty or representation, expressed or implied, is made as to the accuracy of the information contained herein, and same is submitted subject to error and omissions.



# Yorkbrook Business Park

50-88 Eisenhower Lane

Lombard, IL | [Property Website](#)



## PROPERTY HIGHLIGHTS

Building Size	64,800 SF
Ceiling Height	15'
• Unit 52 Size	5,400 SF
- Office Size	2,272 SF
- Loading	1 Dock
• Unit 76 Size	2,672 SF
- Office Size	503 SF
- Loading	1 DID
• Unit 78 Size	6,038 SF
- Office Size	5,810 SF
- Loading	1 DID
• Unit 84 Size	5,455 SF
- Office Size	930 SF
- Loading	1 Dock / 1 DID
Lease Rate	Subject to Offer



- HVAC maintenance & repairs included in lease rate
- Immediate access to I-355 and I-88
- Adjacent to Oakbrook restaurants and retail
- High-image office area
- Professionally owned and managed business park with on-site property management



No warranty or representation, expressed or implied, is made as to the accuracy of the information contained herein, and same is submitted subject to error and omissions.



# Yorkbrook Business Park

51-87 Eisenhower Lane

Lombard, IL | [Property Website](#)



## PROPERTY HIGHLIGHTS

Building Size	73,209 SF
Ceiling Height	15'
• Unit 55 Size	4,562 SF
- Office Size	0 SF
- Loading	1 Dock / 1 DID
• Unit 71 Size	9,050 SF
- Office Size	3,350 SF
- Loading	1 Dock / 1 DID
Lease Rate	Subject to Offer



- HVAC maintenance & repairs included in lease rate
- Immediate access to I-355 and I-88
- Adjacent to Oakbrook restaurants and retail
- High-image office area
- Professionally owned and managed business park with on-site property management



No warranty or representation, expressed or implied, is made as to the accuracy of the information contained herein, and same is submitted subject to error and omissions.

# Yorkbrook Business Park

120-157 Eisenhower Lane

Lombard, IL | [Property Website](#)



## PROPERTY HIGHLIGHTS

Building Size	74,705 SF
Ceiling Height	16'
• Unit 144 Size	4,167 SF
- Office Size	563 SF
- Loading	1 DID
Lease Rate	Subject to Offer



- HVAC maintenance & repairs included in lease rate
- Immediate access to I-355 and I-88
- Adjacent to Oakbrook restaurants and retail
- High-image office area
- Professionally owned and managed business park with on-site property management



No warranty or representation, expressed or implied, is made as to the accuracy of the information contained herein, and same is submitted subject to error and omissions.



# Yorkbrook Business Park

121-158 Eisenhower Lane

Lombard, IL | [Property Website](#)



## PROPERTY HIGHLIGHTS

Building Size	74,708 SF
Ceiling Height	15'
• Unit 121 Size	2,070 SF
- Office Size	902 SF
- Loading	1 DID
• Unit 130 Size	2,070 SF
- Office Size	324 SF
- Loading	1 DID
Lease Rate	Subject to Offer



- HVAC maintenance & repairs included in lease rate
- Immediate access to I-355 and I-88
- Adjacent to Oakbrook restaurants and retail
- High-image office area
- Professionally owned and managed business park with on-site property management



No warranty or representation, expressed or implied, is made as to the accuracy of the information contained herein, and same is submitted subject to error and omissions.



# Yorkbrook Business Park

201-235 Eisenhower Lane

Lombard, IL | [Property Website](#)



## PROPERTY HIGHLIGHTS

Building Size	72,877 SF
Ceiling Height	15'
• Unit 211A Size	2,283 SF
- Office Size	428 SF
- Loading	1 DID
• Unit 219 Size	15,740 SF
- Office Size	6,250 SF
- Loading	2 Docks / 2 DID
Lease Rate	Subject to Offer



- HVAC maintenance & repairs included in lease rate
- Immediate access to I-355 and I-88
- Adjacent to Oakbrook restaurants and retail
- High-image office area
- Professionally owned and managed business park with on-site property management

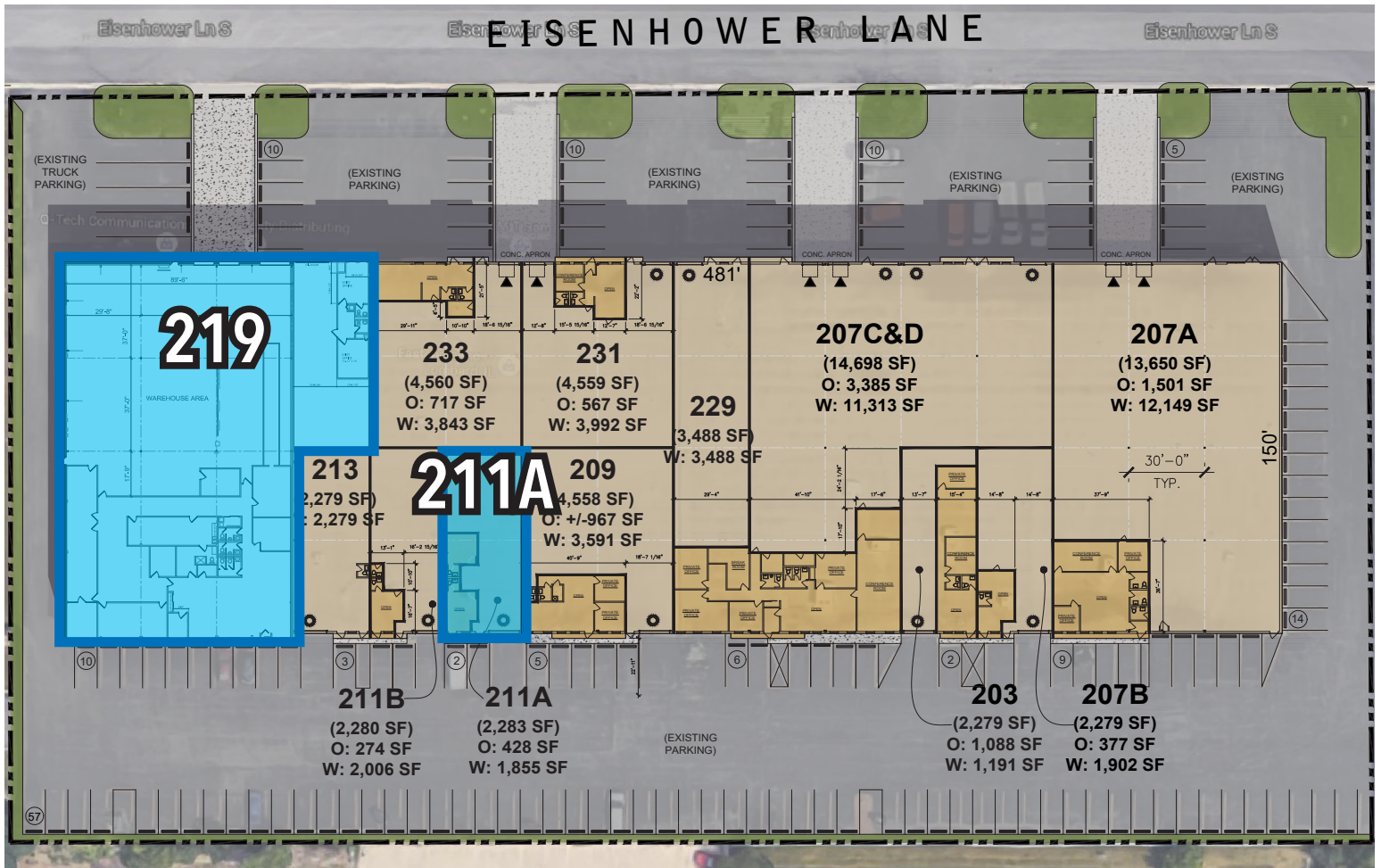

No warranty or representation, expressed or implied, is made as to the accuracy of the information contained herein, and same is submitted subject to error and omissions.



# Yorkbrook Business Park

400-420 Eisenhower Lane

Lombard, IL | [Property Website](#)



## PROPERTY HIGHLIGHTS

Building Size	39,578 SF
Ceiling Height	9'
• Unit 400 Size	16,068 SF
- Existing Office	13,009 SF
- Conceptual Office	4,410 SF
- Loading	None
Lease Rate	Subject to Offer
Sale Price	Subject to Offer
<a href="#"><b><i>CLICK HERE TO VIEW PROPERTY LEASE ECONOMICS</i></b></a>	



- HVAC maintenance & repairs included in lease rate
- Immediate access to I-355 and I-88
- Adjacent to Oakbrook restaurants and retail
- High-image office area
- Professionally owned and managed business park with on-site property management



No warranty or representation, expressed or implied, is made as to the accuracy of the information contained herein, and same is submitted subject to error and omissions.



# Yorkbrook Business Park

401-419 Eisenhower Lane

Lombard, IL | [Property Website](#)



## PROPERTY HIGHLIGHTS

Building Size	32,113 SF
Ceiling Height	14'
• Unit 419 Size	9,600 SF
- Existing Office	9,292 SF
- Conceptual Office	3,490 SF
- Loading	None
Lease Rate	Subject to Offer
Sale Price	Subject to Offer
<a href="#">CLICK HERE TO VIEW PROPERTY LEASE ECONOMICS</a>	



- HVAC maintenance & repairs included in lease rate
- Immediate access to I-355 and I-88
- Adjacent to Oakbrook restaurants and retail
- High-image office area
- Professionally owned and managed business park with on-site property management



No warranty or representation, expressed or implied, is made as to the accuracy of the information contained herein, and same is submitted subject to error and omissions.



# Yorkbrook Business Park

421-449 Eisenhower Lane

Lombard, IL | [Property Website](#)



## PROPERTY HIGHLIGHTS

Building Size	21,330 SF
Ceiling Height	13'
• Unit 421 Size*	7,989 SF (*Can be combined with 435)
- Office Size	6,227 SF (Existing) / 3,454 SF (Conceptual)
- Loading	3 DID
• Unit 435 Size*	2,669 SF (*Can be combined with 421)
- Office Size	1,196 SF
- Loading	1 DID
Lease Rate	Subject to Offer
Sale Price	Subject to Offer
<a href="#">CLICK HERE TO VIEW PROPERTY LEASE ECONOMICS</a>	



- HVAC maintenance & repairs included in lease rate
- Immediate access to I-355 and I-88
- Adjacent to Oakbrook restaurants and retail
- High-image office area
- Professionally owned and managed business park with on-site property management



No warranty or representation, expressed or implied, is made as to the accuracy of the information contained herein, and same is submitted subject to error and omissions.

# Yorkbrook Business Park

455 Eisenhower Lane

Lombard, IL | [Property Website](#)



## PROPERTY HIGHLIGHTS

Building Size	25,416 SF
Ceiling Height	10'
• Unit 100 Size	10,472 SF Office
• Unit 200 Size	14,944 SF Office
Lease Rate	Subject to Offer
Sale Price	Subject to Offer
<a href="#"><b><i>CLICK HERE TO VIEW PROPERTY LEASE ECONOMICS</i></b></a>	



- HVAC maintenance & repairs included in lease rate
- Immediate access to I-355 and I-88
- Adjacent to Oakbrook restaurants and retail
- High-image office area
- Professionally owned and managed business park with on-site property management

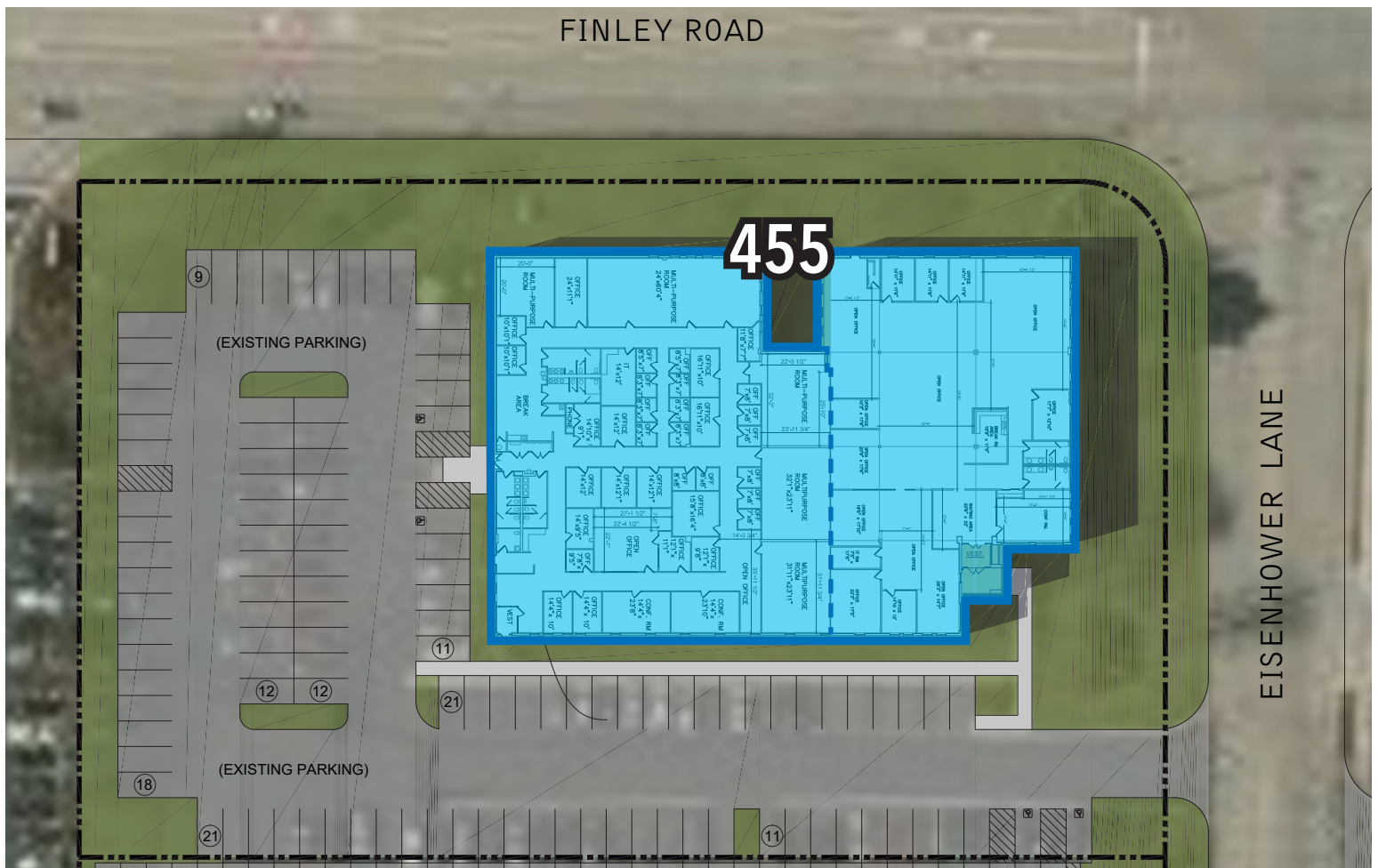

No warranty or representation, expressed or implied, is made as to the accuracy of the information contained herein, and same is submitted subject to error and omissions.



# For Lease

## Yorkbrook Business Park

Eisenhower Lane  
Lombard, IL

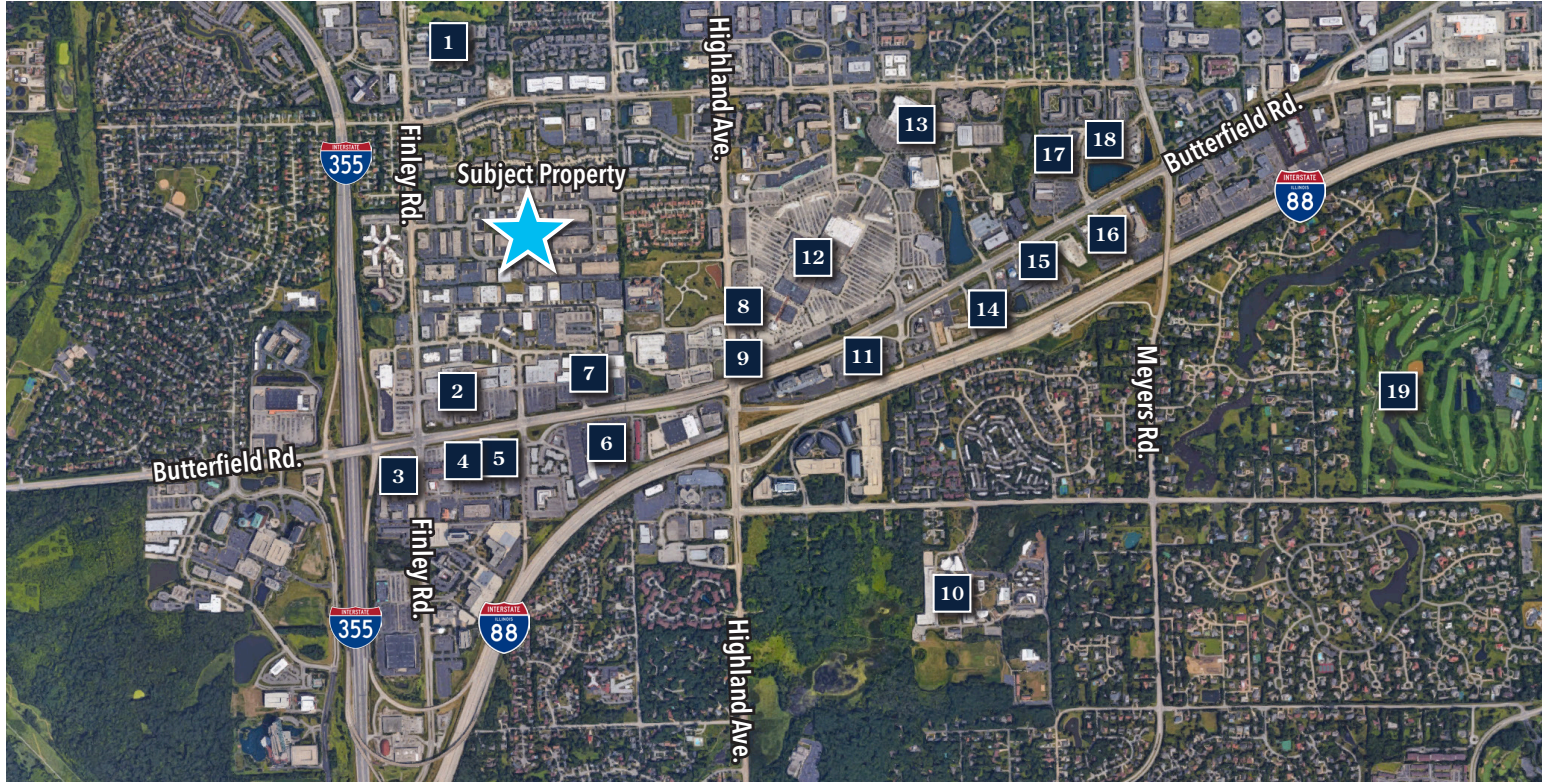

### Surrounding Amenities & Services

- |  |                                 |                                    |                                    |
|--|---------------------------------|------------------------------------|------------------------------------|
| <b>1</b> Four Seasons Park                 | <b>6</b> Olive Garden           | <b>11</b> Miller's Ale House       | <b>16</b> Oak Brook Promenade      |
| <b>2</b> Finley Square Shopping Center     | <b>7</b> Butterfield Plaza      | <b>12</b> Yorktown Shopping Center | <b>17</b> Uncle Julio's            |
| <b>3</b> Chama Gaucha Brazilian Steakhouse | <b>8</b> Rock Bottom            | <b>13</b> Target                   | <b>18</b> Hyatt Place              |
| <b>4</b> Red Lobster                       | <b>9</b> Bucca di Beppo         | <b>14</b> Embassy Suites by Hilton | <b>19</b> Butterfield Country Club |
| <b>5</b> Brickhouse Tavern and Tap         | <b>10</b> Midwestern University | <b>15</b> Benihana                 |                                    |

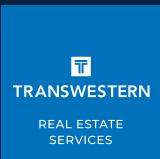

**JUSTIN  
LERNER, SIOR**

EXECUTIVE VICE PRESIDENT  
justin.lerner@transwestern.com  
847.588.5665

**JOE  
KARMIN, SIOR**

EXECUTIVE VICE PRESIDENT  
joe.karmin@transwestern.com  
847.588.5670

**ROSS  
LEHRMAN**

SENIOR VICE PRESIDENT  
ross.lehrman@transwestern.com  
847.588.5671

*No warranty or representation, expressed or implied, is made as to the accuracy of the information contained herein, and same is submitted subject to error and omissions.*