

**INDUSTRIAL  
BUILDING  
FOR LEASE**

**±58,000 SF  
(DIVISIBLE)**

Divisible to  
±21,750 SF  
or ±36,250 SF

Professionally  
Owned and  
Managed by:

  
**WESTMOUNT  
REALTY CAPITAL, LLC**

  
**TRANSWESTERN**  
REAL ESTATE  
SERVICES

# 940 LIVELY BOULEVARD

Elk Grove Village, IL 60007

[Property Website](#)



## Specifications

- Building Size: ±58,000 SF
- Land Area: ±2.59 AC
- Divisible To: ±21,750 SF
- North Office: ±2,344 SF
- South Office: ±5,000 SF
- Ceiling Height: 18'
- Loading: 4 Int Docks / 2 DID
- Power: 800A 480V
- Parking: ±75 Cars
- Year Built: 1980
- Construction: Masonry

## Highlights

- Flexible space options available
- Divisible to ±21,750 SF with ±2,344 SF office or ±36,250 SF with ±5,000 SF office
- Direct access to Busse Rd & I-90
- Professionally owned & managed

## Pricing

- CAM: \$1.05 PSF (2024 Est)
- INS: \$0.12 PSF (2024 Est)
- UTL: \$0.13 PSF (2024 Est)
- RET: \$3.86 PSF (2024 Est)
- **Lease Rate: Subject to Offer**

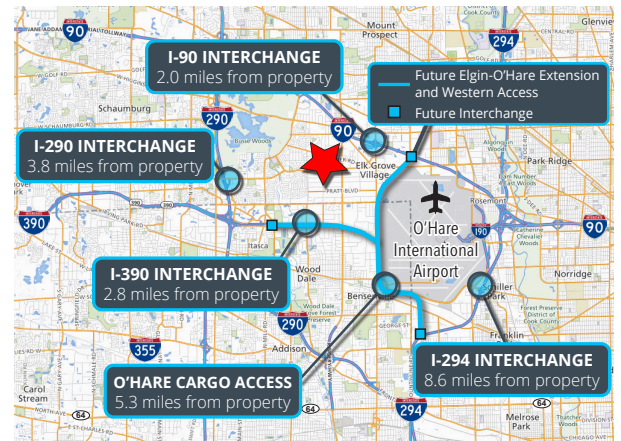

**Ross Lehrman**  
Vice President  
847.588.5671  
ross.lehrman@transwestern.com

**Joe Karmin, SIOR**  
Executive Vice President  
847.588.5670  
joe.karmin@transwestern.com

**Justin Lerner, SIOR**  
Executive Vice President  
847.588.5665  
justin.lerner@transwestern.com

The information provided herein was obtained from sources believed reliable; however, Transwestern makes no guarantees, warranties, or representations as to the completeness or accuracy thereof. The presentation of this information is submitted subject to errors, omissions, change of price or conditions, prior sale or lease, or withdrawal without notice. Copyright © 2024 Transwestern.

**INDUSTRIAL  
BUILDING  
FOR LEASE**

**±58,000 SF  
(DIVISIBLE)**

Divisible to  
±21,750 SF  
or ±36,250 SF

Professionally  
Owned and  
Managed by:

**WESTMOUNT**  
REALTY CAPITAL, LLC

**TRANSWESTERN**  
REAL ESTATE  
SERVICES

# 940 LIVELY BOULEVARD

Elk Grove Village, IL 60007

[Property Website](#)

## SITE PLAN

Landmeier Rd

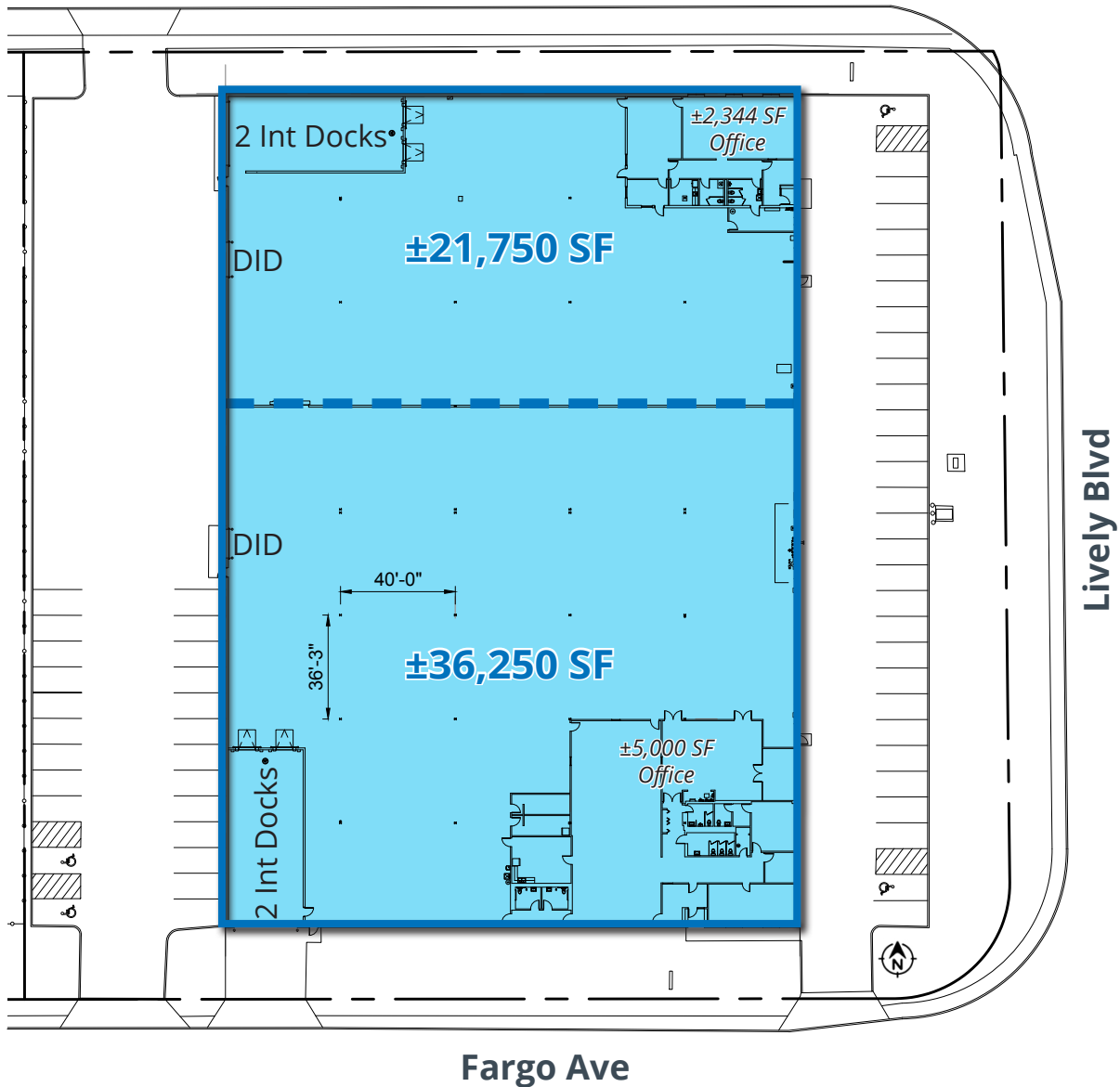

**Ross Lehrman**  
Vice President  
847.588.5671  
ross.lehrman@transwestern.com

**Joe Karmin, SIOR**  
Executive Vice President  
847.588.5670  
joe.karmin@transwestern.com

**Justin Lerner, SIOR**  
Executive Vice President  
847.588.5665  
justin.lerner@transwestern.com

The information provided herein was obtained from sources believed reliable; however, Transwestern makes no guarantees, warranties, or representations as to the completeness or accuracy thereof. The presentation of this information is submitted subject to errors, omissions, change of price or conditions, prior sale or lease, or withdrawal without notice. Copyright © 2024 Transwestern.