

±8,384 SF  
INDUSTRIAL  
SPACE  
FOR LEASE

Preferred  
Corner Unit

Clear Span  
Warehouse

Professionally  
Owned and  
Managed by:



  
TRANSWESTERN  
REAL ESTATE  
SERVICES

# 431 N. RADDANT ROAD

Batavia, IL 60510

[Property Website](#)



## SPECIFICATIONS

- Building Size: ±56,935 SF
- Land Area: ±4.08 AC
- Available Size: ±8,384 SF
- Office Size: ±2,463 SF
- Ceiling Height: 19' - 22'
- Loading: 1 Ext Dock / 1 DID
- Power: 400A 480V
- Parking: ±15 Cars
- Sprinklers: Wet
- Year Built: 1997
- Zoning: LI (Light Industrial)
- Construction: Masonry/Metal
- **Lease Rate: Subject to Offer**

## HIGHLIGHTS

- Preferred corner unit
- Clear span warehouse
- ±724 SF mezzanine area not included in total building size
- Restrooms in both office and warehouse areas
- Kane County taxes
- Professionally owned and managed

## PRICING

- CAM: \$1.16 PSF
- INS: \$0.13 PSF
- RET: \$1.57 PSF
- **Lease Rate: Subject to Offer**

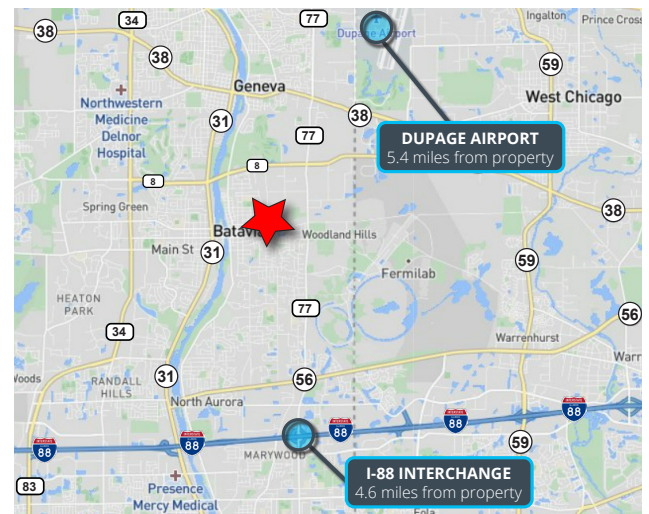

Marko Kaplarevic  
Associate  
847.588.5651  
marko.kaplarevic@transwestern.com

Michael Marconi, SIOR  
Sr. EVP & Designated Managing Broker  
847.588.5679  
michael.marconi@transwestern.com

The information provided herein was obtained from sources believed reliable; however, Transwestern makes no guarantees, warranties, or representations as to the completeness or accuracy thereof. The presentation of this information is submitted subject to errors, omissions, change of price or conditions, prior sale or lease, or withdrawal without notice. Copyright © 2024 Transwestern.

±8,384 SF  
INDUSTRIAL  
SPACE  
FOR LEASE

Preferred  
Corner Unit

Clear Span  
Warehouse

Professionally  
Owned and  
Managed by:



  
TRANSWESTERN  
REAL ESTATE  
SERVICES

# 431 N. RADDANT ROAD

Batavia, IL 60510  
[Property Website](#)

## MAIN FLOOR PLAN

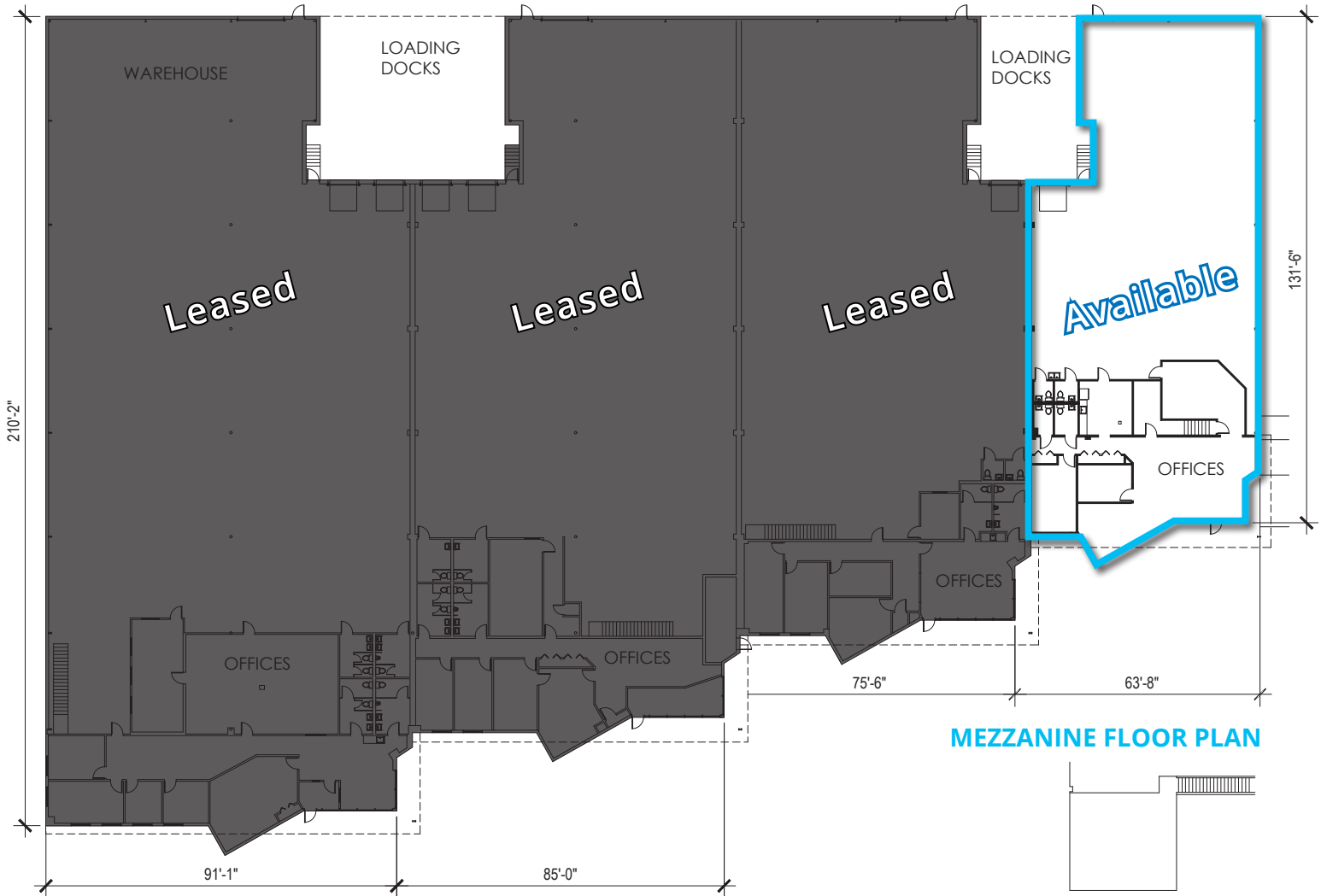

## MEZZANINE FLOOR PLAN

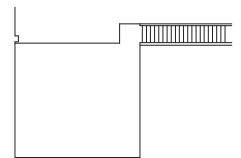

**Marko Kaplarevic**  
Associate  
847.588.5651  
marko.kaplarevic@transwestern.com

**Michael Marconi, SIOR**  
Sr. EVP & Designated Managing Broker  
847.588.5679  
michael.marconi@transwestern.com

The information provided herein was obtained from sources believed reliable; however, Transwestern makes no guarantees, warranties, or representations as to the completeness or accuracy thereof. The presentation of this information is submitted subject to errors, omissions, change of price or conditions, prior sale or lease, or withdrawal without notice. Copyright © 2024 Transwestern.

±8,384 SF  
**INDUSTRIAL  
SPACE  
FOR LEASE**

Preferred  
Corner Unit

Clear Span  
Warehouse

Professionally  
Owned and  
Managed by:



  
**TRANSWESTERN**  
REAL ESTATE  
SERVICES

# 431 N. RADDANT ROAD

Batavia, IL 60510  
[Property Website](#)

## PROPERTY PHOTOS



**Marko Kaplarevic**  
Associate  
847.588.5651  
marko.kaplarevic@transwestern.com

**Michael Marconi, SIOR**  
Sr. EVP & Designated Managing Broker  
847.588.5679  
michael.marconi@transwestern.com

The information provided herein was obtained from sources believed reliable; however, Transwestern makes no guarantees, warranties, or representations as to the completeness or accuracy thereof. The presentation of this information is submitted subject to errors, omissions, change of price or conditions, prior sale or lease, or withdrawal without notice. Copyright © 2024 Transwestern.