

±5,661 SF  
**INDUSTRIAL  
SPACE  
FOR LEASE**

High-image  
Business  
Park

Immediate  
Access to I-355  
and North Ave

Professionally  
Owned and  
Managed by:



**TRANSWESTERN**  
REAL ESTATE  
SERVICES

# 1040 N. DUPAGE AVENUE

Lombard, IL 60148

[Property Website](#)



## Specifications

- Building Size: ±19,246 SF
- Available Size: ±5,661 SF
- Ceiling Height: ±14' Clear
- Loading: 1 Ext Dock / 1 DID
- Power: 200-400A 3PH
- Parking: ±10 Cars
- Year Built: 1987
- Construction: Masonry
- RE Taxes: \$2.03 PSF (2023)
- **Lease Rate: Subject to Offer**

## Highlights

- High-image business park
- Hard-to-find smaller unit
- Well-maintained
- Immediate access to I-355 and North Avenue
- Low DuPage County taxes
- Professionally owned and managed

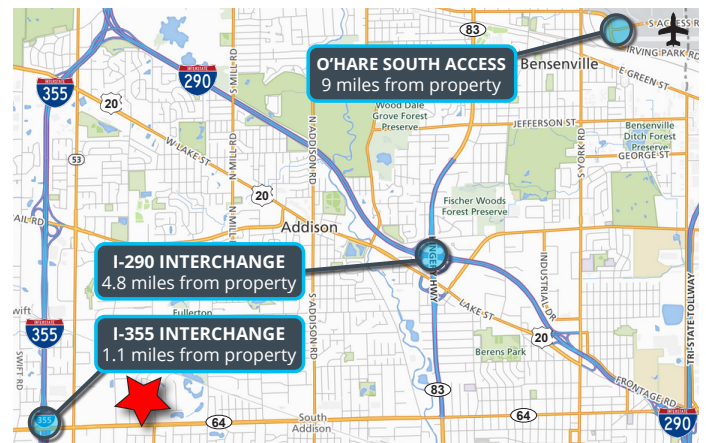

**Justin Lerner, SIOR**  
*Executive Vice President*  
847.588.5665  
[justin.lerner@transwestern.com](mailto:justin.lerner@transwestern.com)

**Joe Karmin, SIOR**  
*Executive Vice President*  
847.588.5670  
[joe.karmin@transwestern.com](mailto:joe.karmin@transwestern.com)

**Ross Lehrman**  
*Senior Vice President*  
847.588.5671  
[ross.lehrman@transwestern.com](mailto:ross.lehrman@transwestern.com)

The information provided herein was obtained from sources believed reliable; however, Transwestern makes no guarantees, warranties, or representations as to the completeness or accuracy thereof. The presentation of this information is submitted subject to errors, omissions, change of price or conditions, prior sale or lease, or withdrawal without notice. Copyright © 2025 Transwestern.

±5,661 SF  
**INDUSTRIAL  
SPACE  
FOR LEASE**

High-image  
Business  
Park

Immediate  
Access to I-355  
and North Ave

Professionally  
Owned and  
Managed by:



  
**TRANSWESTERN**  
REAL ESTATE  
SERVICES

# 1040 N. DUPAGE AVENUE

Lombard, IL 60148

[Property Website](#)

## BUILDING PLAN



**Justin Lerner, SIOR**  
Executive Vice President  
847.588.5665  
justin.lerner@transwestern.com

**Joe Karmin, SIOR**  
Executive Vice President  
847.588.5670  
joe.karmin@transwestern.com

**Ross Lehrman**  
Senior Vice President  
847.588.5671  
ross.lehrman@transwestern.com

The information provided herein was obtained from sources believed reliable; however, Transwestern makes no guarantees, warranties, or representations as to the completeness or accuracy thereof. The presentation of this information is submitted subject to errors, omissions, change of price or conditions, prior sale or lease, or withdrawal without notice. Copyright © 2025 Transwestern.