

±21,400 SF  
INDUSTRIAL  
BUILDING FOR  
SUBLEASE

Sublease  
Through  
4/30/2027

Longer Term  
Lease Options  
Available

Excellent  
Access  
to I-90

  
**TRANSWESTERN**  
REAL ESTATE  
SERVICES

# 605 BONNIE LANE

Elk Grove Village, IL 60007

[Property Website](#)

**NOW AVAILABLE FOR SUBLEASE**



## Specifications

- Building Size: ±21,400 SF
- Land Area: ±0.95 AC
- Office Size: ±3,500 SF
- Ceiling Height: 15' - 16'
- Loading: 2 Docks / 1 DID
- Power: 1600 Amps
- Parking: ±25 Cars
- Year Built: 1977
- Construction: Masonry
- Heating: Gas Fired Units

## Highlights

- Sublease through 4/30/27
- Longer term lease options available
- Class 6b status
- LED lighting
- Excellent access to I-90 and other major expressways

## Pricing

- CAM: \$1.20 PSF (2024 Est.)
- RET: \$1.48 PSF (2024 Est.)
- **Lease Rate: \$10.25 PSF Net**

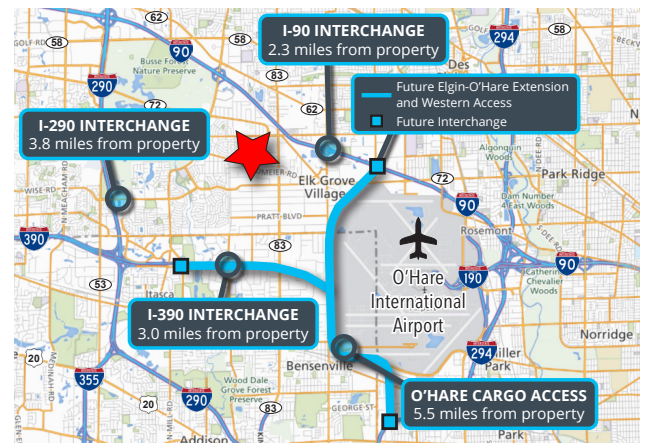

**Ross Lehrman**  
Vice President  
847.588.5671  
ross.lehrman@transwestern.com

**Joe Karmin, SIOR**  
Executive Vice President  
847.588.5670  
joe.karmin@transwestern.com

**Justin Lerner, SIOR**  
Executive Vice President  
847.588.5665  
justin.lerner@transwestern.com

The information provided herein was obtained from sources believed reliable; however, Transwestern makes no guarantees, warranties, or representations as to the completeness or accuracy thereof. The presentation of this information is submitted subject to errors, omissions, change of price or conditions, prior sale or lease, or withdrawal without notice. Copyright © 2024 Transwestern.

±21,400 SF  
INDUSTRIAL  
BUILDING FOR  
SUBLEASE

Sublease  
Through  
4/30/2027

Longer Term  
Lease Options  
Available

Excellent  
Access  
to I-90

  
**TRANSWESTERN**  
REAL ESTATE  
SERVICES

# 605 BONNIE LANE

Elk Grove Village, IL 60007  
[Property Website](#)

## BUILDING LAYOUT

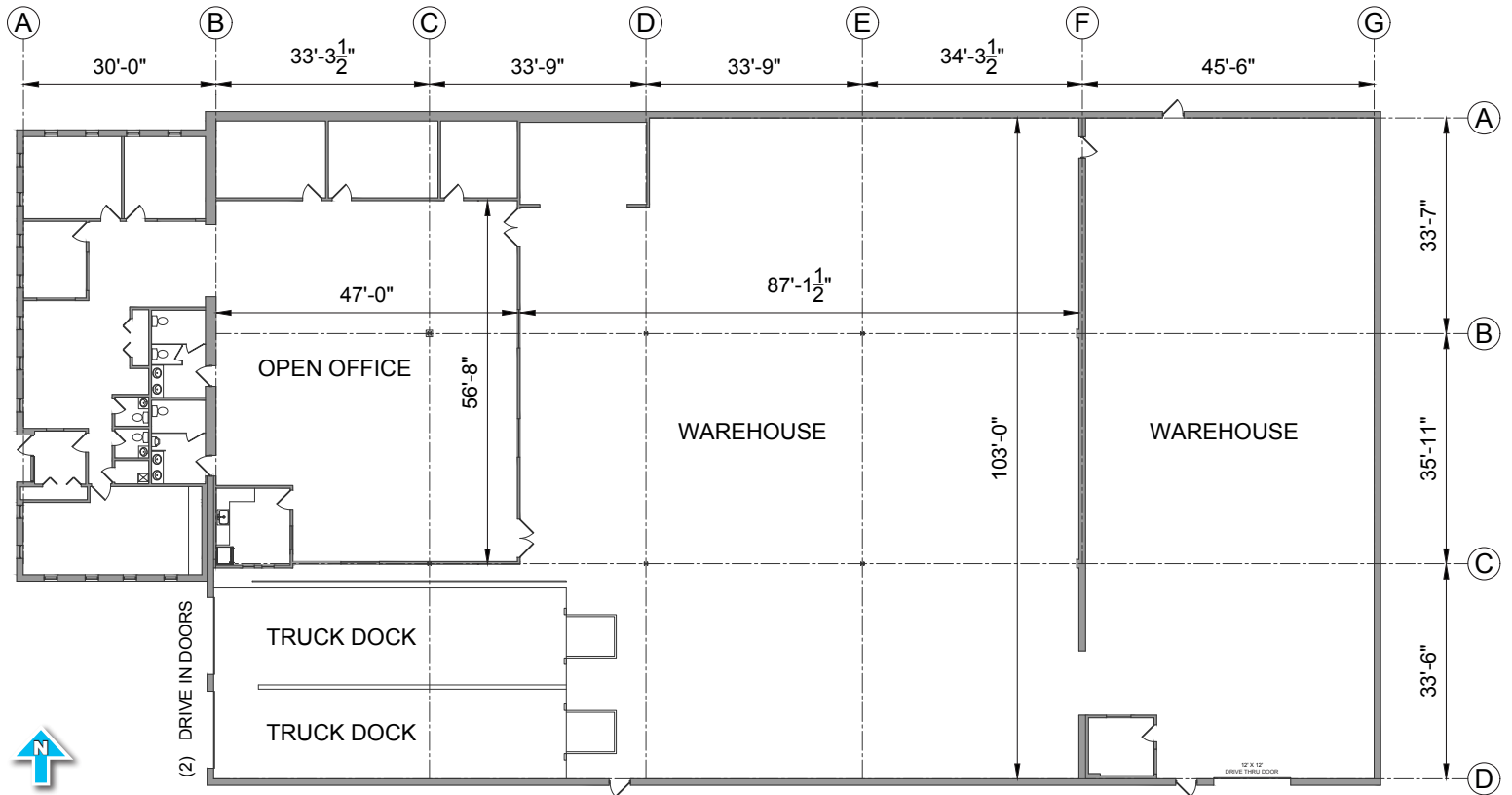

**Ross Lehrman**  
Vice President  
847.588.5671  
ross.lehrman@transwestern.com

**Joe Karmin, SIOR**  
Executive Vice President  
847.588.5670  
joe.karmin@transwestern.com

**Justin Lerner, SIOR**  
Executive Vice President  
847.588.5665  
justin.lerner@transwestern.com

±21,400 SF  
INDUSTRIAL  
BUILDING FOR  
SUBLEASE

Sublease  
Through  
4/30/2027

Longer Term  
Lease Options  
Available

Excellent  
Access  
to I-90



TRANSWESTERN

REAL ESTATE  
SERVICES

# 605 BONNIE LANE

Elk Grove Village, IL 60007

[Property Website](#)

## BUILDING RENDERINGS



**Ross Lehrman**  
Vice President  
847.588.5671  
ross.lehrman@transwestern.com

**Joe Karmin, SIOR**  
Executive Vice President  
847.588.5670  
joe.karmin@transwestern.com

**Justin Lerner, SIOR**  
Executive Vice President  
847.588.5665  
justin.lerner@transwestern.com

The information provided herein was obtained from sources believed reliable; however, Transwestern makes no guarantees, warranties, or representations as to the completeness or accuracy thereof. The presentation of this information is submitted subject to errors, omissions, change of price or conditions, prior sale or lease, or withdrawal without notice. Copyright © 2024 Transwestern.