

**INDUSTRIAL
SPACE
FOR LEASE**

±6,961 SF

Excellent
Access to
Routes 30,
47 and 56

Institutionally
Owned and
Professionally
Managed by:

AGELLAN
COMMERCIAL REIT

TRANSWESTERN
REAL ESTATE
SERVICES

483 HEARTLAND DRIVE

Suite F, Sugar Grove, IL 60554

[Property Website](#)



Specifications

- Building Size: ±36,426 SF
- Land Area: ±2.56 AC
- Available Size: ±6,961 SF
- Office Size: ±1,258 SF
- Loading: 1 Ext Dock / 1 DID
- Ceiling Height: 20'
- Power: 200 Amps
- Parking: ±7 Cars
- Zoning: M-1 (Limited Mfg.)
- Sprinklers: Wet
- Year Built: 2010
- Construction: Precast

Highlights

- Preferred corner unit
- Located in an established industrial park just north of Aurora Airport
- Excellent access to Route 30, Route 47, and Route 56
- Institutionally owned and professionally managed

Pricing

- CAM: \$1.58 PSF (2023)
- INS: \$0.34 PSF (2023)
- RET: \$2.05 PSF (2023)
- **Lease Rate: Subject to Offer**

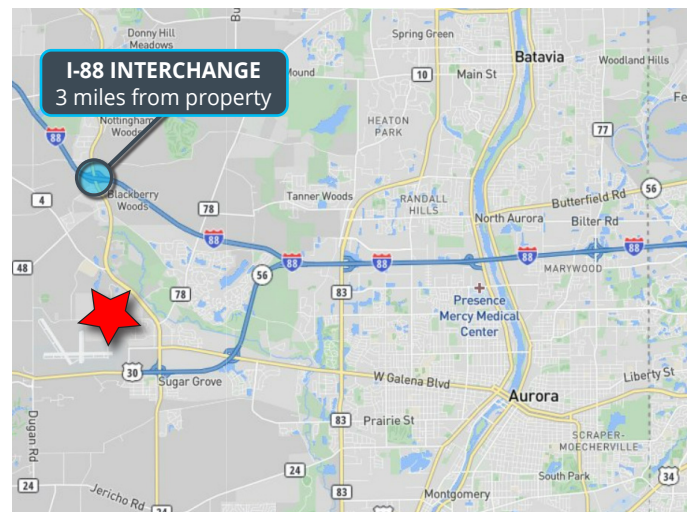

Michael Marconi, SIOR
Sr. EVP & Designated Managing Broker
847.588.5689
michael.marconi@transwestern.com

Marko Kaplarevic
Associate
847.588.5651
marko.kaplarevic@transwestern.com

The information provided herein was obtained from sources believed reliable; however, Transwestern makes no guarantees, warranties, or representations as to the completeness or accuracy thereof. The presentation of this information is submitted subject to errors, omissions, change of price or conditions, prior sale or lease, or withdrawal without notice. Copyright © 2024 Transwestern.

**INDUSTRIAL
SPACE
FOR LEASE**

±6,961 SF

Excellent
Access to
Routes 30,
47 and 56

Institutionally
Owned and
Professionally
Managed by:

AGELLAN
COMMERCIAL REIT

TRANSWESTERN
REAL ESTATE
SERVICES

483 HEARTLAND DRIVE

Suite F, Sugar Grove, IL 60554
[Property Website](#)

BUILDING LAYOUT

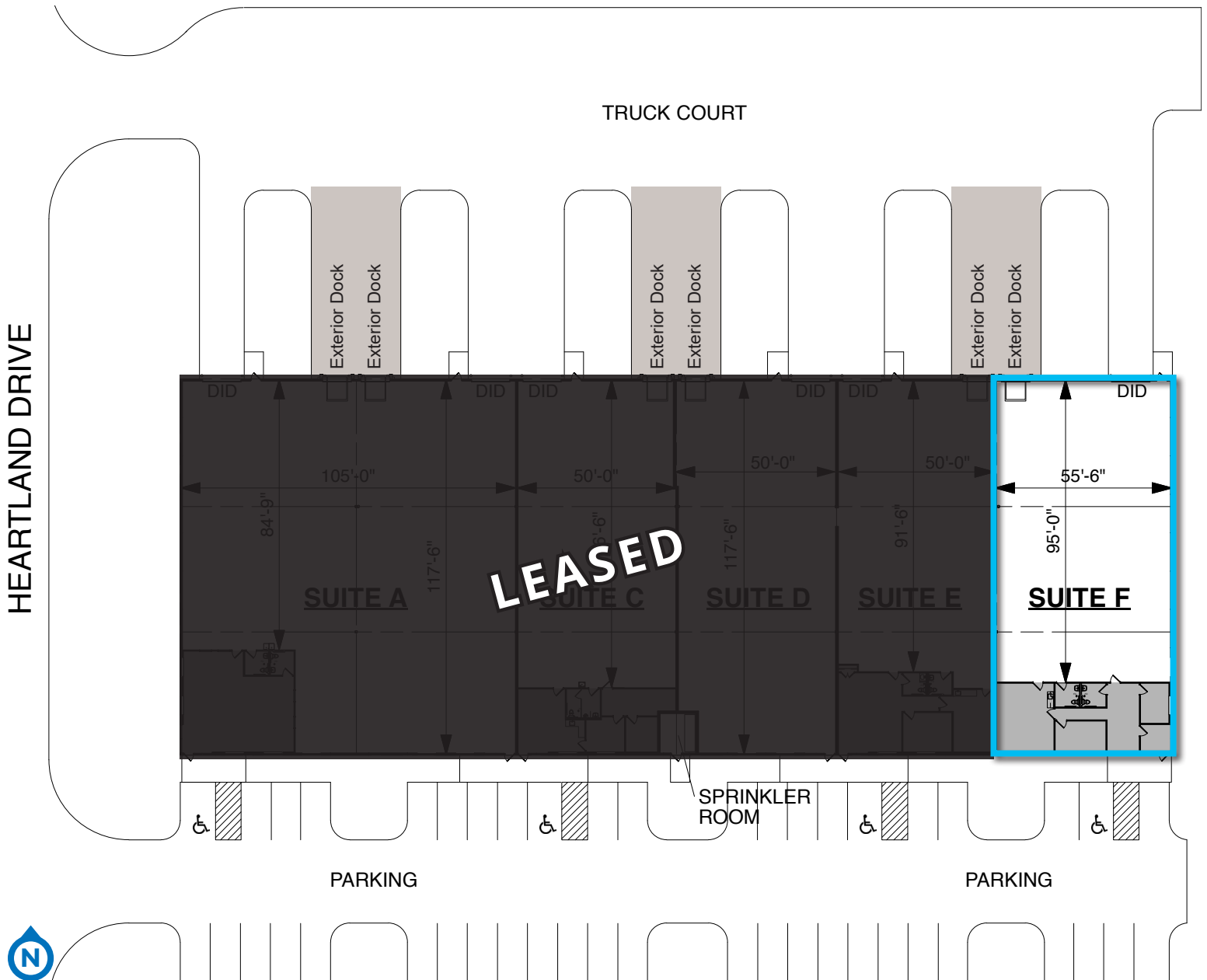

Michael Marconi, SIOR
Sr. EVP & Designated Managing Broker
847.588.5689
michael.marconi@transwestern.com

Marko Kaplarevic
Associate
847.588.5651
marko.kaplarevic@transwestern.com

The information provided herein was obtained from sources believed reliable; however, Transwestern makes no guarantees, warranties, or representations as to the completeness or accuracy thereof. The presentation of this information is submitted subject to errors, omissions, change of price or conditions, prior sale or lease, or withdrawal without notice. Copyright © 2024 Transwestern.

**INDUSTRIAL
SPACE
FOR LEASE**

±6,961 SF

Excellent
Access to
Routes 30,
47 and 56

Institutionally
Owned and
Professionally
Managed by:

AGELLAN
COMMERCIAL REIT

TRANSWESTERN
REAL ESTATE
SERVICES

483 HEARTLAND DRIVE

Suite F, Sugar Grove, IL 60554

[Property Website](#)

BUILDING PHOTOS



Michael Marconi, SIOR
Sr. EVP & Designated Managing Broker
847.588.5689
michael.marconi@transwestern.com

Marko Kaplarevic
Associate
847.588.5651
marko.kaplarevic@transwestern.com

The information provided herein was obtained from sources believed reliable; however, Transwestern makes no guarantees, warranties, or representations as to the completeness or accuracy thereof. The presentation of this information is submitted subject to errors, omissions, change of price or conditions, prior sale or lease, or withdrawal without notice. Copyright © 2024 Transwestern.