

±5,493 SF
**INDUSTRIAL
SPACE
FOR LEASE**

Cross-loading
Capability

Direct Access
to I-90 and
Busse Road

Professionally
Owned by:



221 STANLEY STREET

Elk Grove Village, IL 60007

[Property Website](#)



Specifications

- Building Size: ±10,993 SF
- Land Area: ±0.55 AC
- Available Size: ±5,493 SF
- Office Size: ±1,373 SF
- Ceiling Height: 14' Clear
- Loading Docks: 1 Exterior
- Drive-in Doors: 1 (12' x 13'6")
- Power: 400A 208/120V 3P 4W
- Parking: 7 Cars
- Heating: Gas
- Year Built: 1980
- Construction: Masonry
- **Lease Rate: Subject to Offer**

Highlights

- Under new ownership
- Cross-loading capability
- Direct access to I-90 and Busse Road
- Very well-maintained industrial facility
- Adjacent to Elk Grove Village Technology Park
- Professionally owned and managed

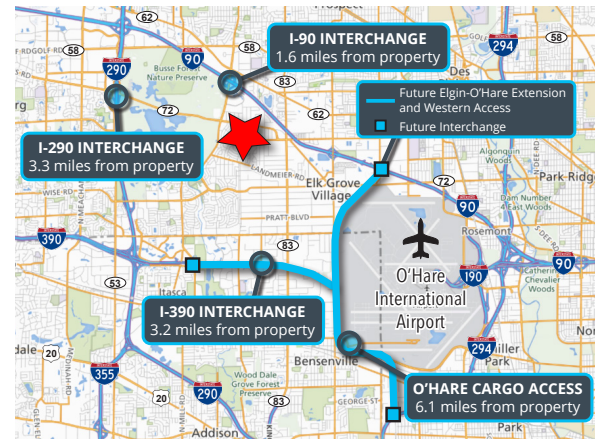

Ross Lehrman
Senior Vice President
847.588.5671
ross.lehrman@transwestern.com

Joe Karmin, SIOR
Executive Vice President
847.588.5670
joe.karmin@transwestern.com

Justin Lerner, SIOR
Executive Vice President
847.588.5665
justin.lerner@transwestern.com

The information provided herein was obtained from sources believed reliable; however, Transwestern makes no guarantees, warranties, or representations as to the completeness or accuracy thereof. The presentation of this information is submitted subject to errors, omissions, change of price or conditions, prior sale or lease, or withdrawal without notice. Copyright © 2025 Transwestern.

±5,493 SF
**INDUSTRIAL
SPACE
FOR LEASE**

Cross-loading
Capability

Direct Access
to I-90 and
Busse Road

Professionally
Owned by:



221 STANLEY STREET

Elk Grove Village, IL 60007

[Property Website](#)

Site Plan

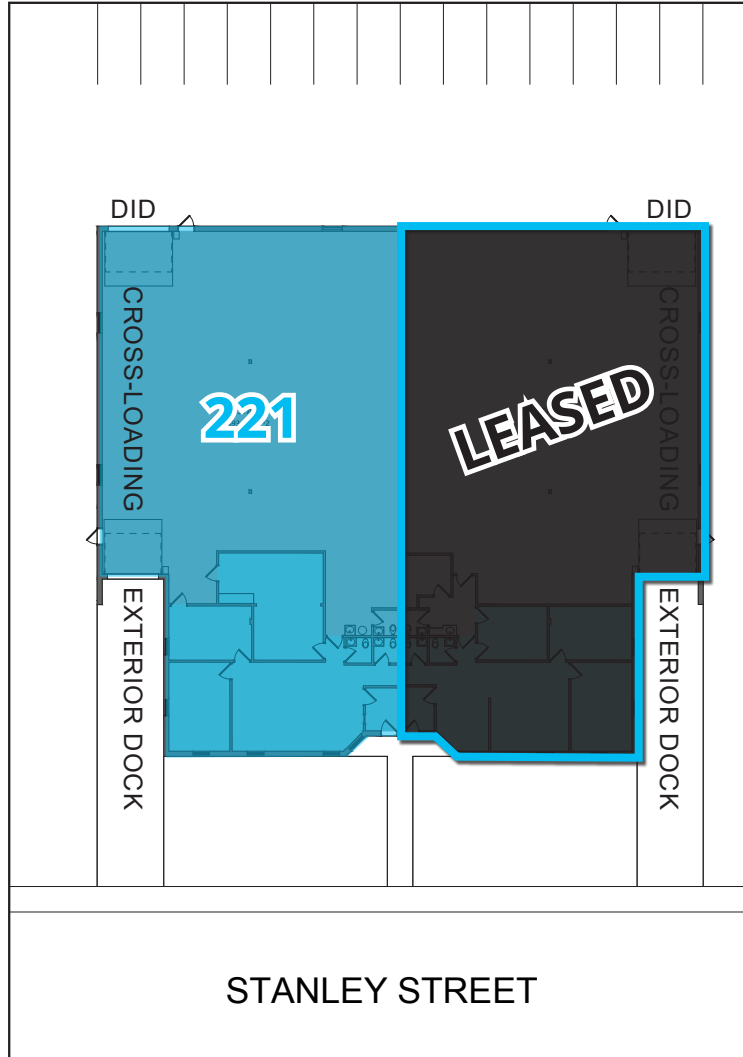

Aerial View

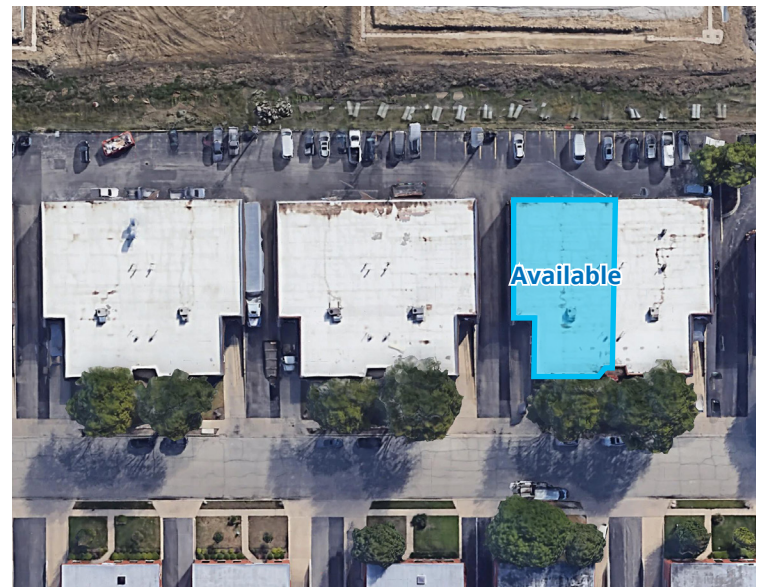

Ross Lehrman
Senior Vice President
847.588.5671
ross.lehrman@transwestern.com

Joe Karmin, SIOR
Executive Vice President
847.588.5670
joe.karmin@transwestern.com

Justin Lerner, SIOR
Executive Vice President
847.588.5665
justin.lerner@transwestern.com

The information provided herein was obtained from sources believed reliable; however, Transwestern makes no guarantees, warranties, or representations as to the completeness or accuracy thereof. The presentation of this information is submitted subject to errors, omissions, change of price or conditions, prior sale or lease, or withdrawal without notice. Copyright © 2025 Transwestern.

±5,493 SF
**INDUSTRIAL
SPACE
FOR LEASE**

Cross-loading
Capability

Direct Access
to I-90 and
Busse Road

Professionally
Owned by:



221 STANLEY STREET

Elk Grove Village, IL 60007

[Property Website](#)

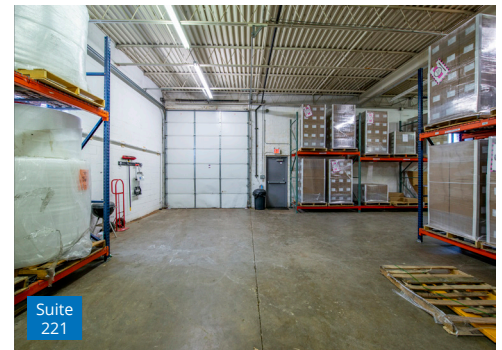
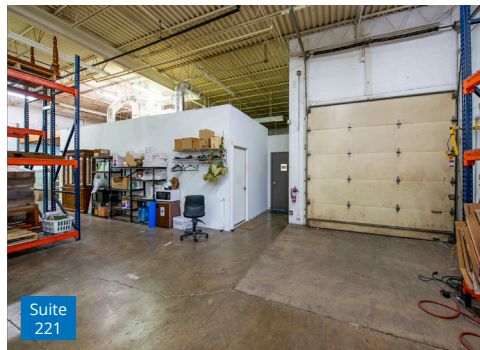
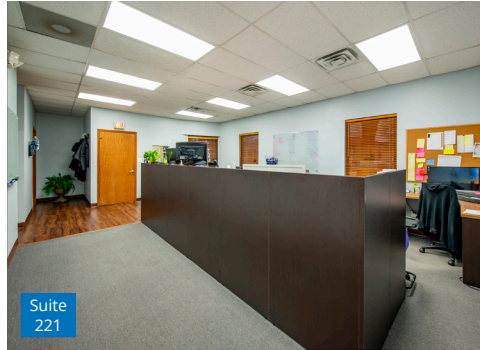

Ross Lehrman
Senior Vice President
847.588.5671
ross.lehrman@transwestern.com

Joe Karmin, SIOR
Executive Vice President
847.588.5670
joe.karmin@transwestern.com

Justin Lerner, SIOR
Executive Vice President
847.588.5665
justin.lerner@transwestern.com

The information provided herein was obtained from sources believed reliable; however, Transwestern makes no guarantees, warranties, or representations as to the completeness or accuracy thereof. The presentation of this information is submitted subject to errors, omissions, change of price or conditions, prior sale or lease, or withdrawal without notice. Copyright © 2025 Transwestern.