

**INDUSTRIAL
BUILDING
FOR LEASE**

±9,760 SF

Well-maintained
Building

Great
Loading Access



TRANSWESTERN

REAL ESTATE
SERVICES

160-170 KELLY STREET

Elk Grove Village, IL 60007

[Property Website](#)



SPECIFICATIONS

- Building Size: ±9,760 SF
- Land Area: ±0.46 AC
- Office Size: TBD
- Ceiling Height: 14'
- Loading: 2 Ext Docks / 1 DID
- Parking: ±6 Cars
- Zoning: I-1
- Year Built: 1968
- Construction: Masonry
- **Lease Rate: \$14.95 PSF MG**

HIGHLIGHTS

- Hard-to-find standalone facility
- Well-maintained building
- Located in the highly sought-after Elk Grove Village submarket
- Direct access to I-90 via Arlington Heights Rd
- Close proximity to other major expressways
- Great loading access

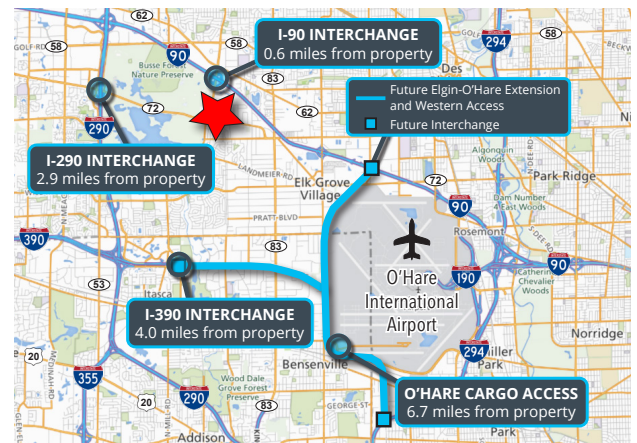

Joe Karmin, SIOR
Executive Vice President
847.588.5670
joe.karmin@transwestern.com

Ross Lehrman
Senior Vice President
847.588.5671
ross.lehrman@transwestern.com

Justin Lerner, SIOR
Executive Vice President
847.588.5665
justin.lerner@transwestern.com

The information provided herein was obtained from sources believed reliable; however, Transwestern makes no guarantees, warranties, or representations as to the completeness or accuracy thereof. The presentation of this information is submitted subject to errors, omissions, change of price or conditions, prior sale or lease, or withdrawal without notice. Copyright © 2026 Transwestern.

**INDUSTRIAL
BUILDING
FOR LEASE**

±9,760 SF

Well-maintained
Building

Great
Loading Access



TRANSWESTERN

REAL ESTATE
SERVICES

160-170 KELLY STREET

Elk Grove Village, IL 60007

[Property Website](#)

FLOOR PLAN

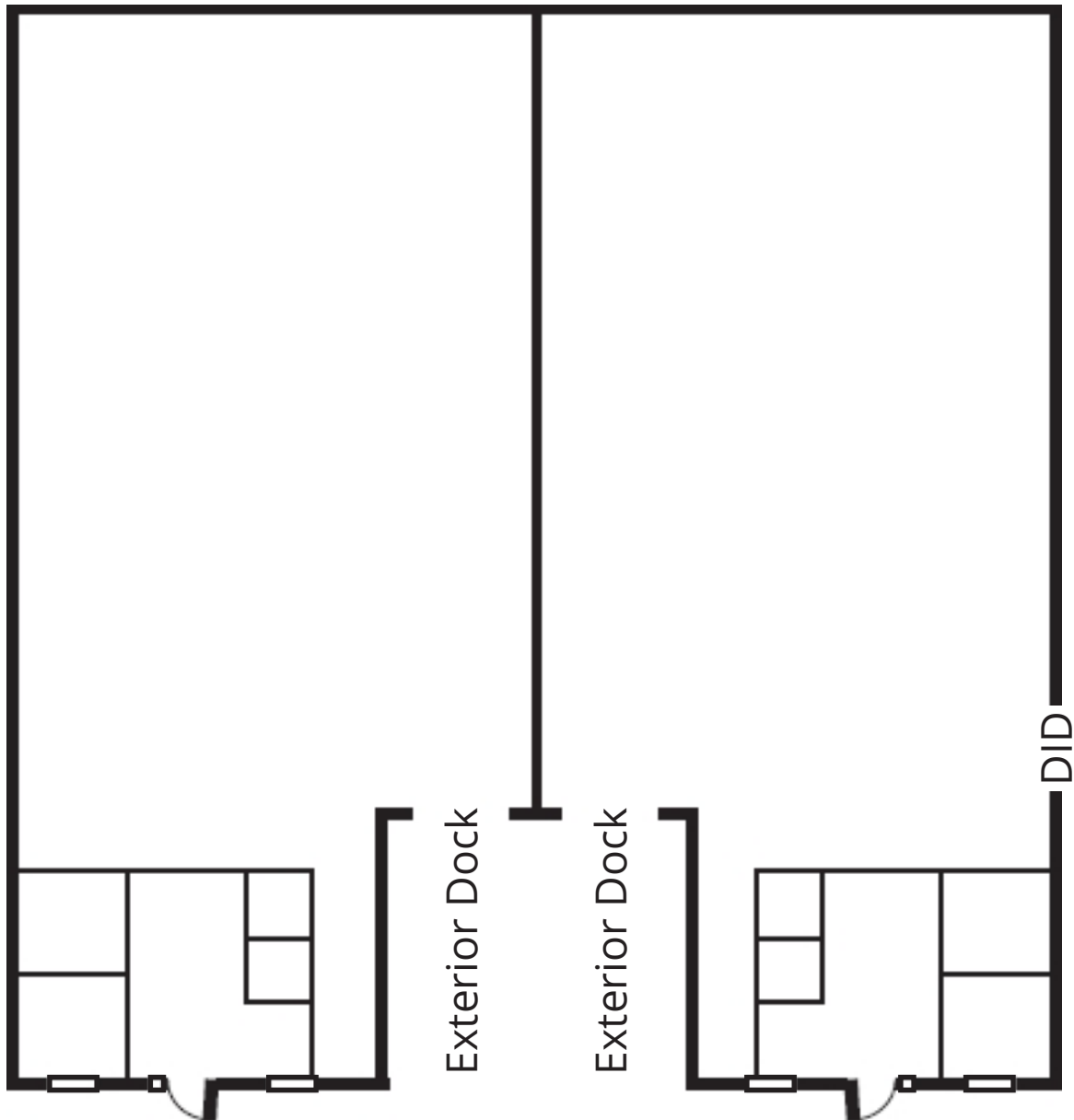

Joe Karmin, SIOR
Executive Vice President
847.588.5670
joe.karmin@transwestern.com

Ross Lehrman
Senior Vice President
847.588.5671
ross.lehrman@transwestern.com

Justin Lerner, SIOR
Executive Vice President
847.588.5665
justin.lerner@transwestern.com

The information provided herein was obtained from sources believed reliable; however, Transwestern makes no guarantees, warranties, or representations as to the completeness or accuracy thereof. The presentation of this information is submitted subject to errors, omissions, change of price or conditions, prior sale or lease, or withdrawal without notice. Copyright © 2026 Transwestern.

**INDUSTRIAL
BUILDING
FOR LEASE**

±9,760 SF

Well-maintained
Building

Great
Loading Access



TRANSWESTERN

REAL ESTATE
SERVICES

160-170 KELLY STREET

Elk Grove Village, IL 60007

[Property Website](#)

PROPERTY AERIAL



Joe Karmin, SIOR
Executive Vice President
847.588.5670
joe.karmin@transwestern.com

Ross Lehrman
Senior Vice President
847.588.5671
ross.lehrman@transwestern.com

Justin Lerner, SIOR
Executive Vice President
847.588.5665
justin.lerner@transwestern.com

The information provided herein was obtained from sources believed reliable; however, Transwestern makes no guarantees, warranties, or representations as to the completeness or accuracy thereof. The presentation of this information is submitted subject to errors, omissions, change of price or conditions, prior sale or lease, or withdrawal without notice. Copyright © 2026 Transwestern.