

For Lease

296 Beeline Drive

Bensenville, IL 60106

21,800 SF

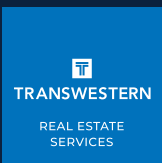

**ROSS
LEHRMAN**

SENIOR VICE PRESIDENT
ross.lehrman@transwestern.com
847.588.5671

**JUSTIN
LERNER, SIOR**

EXECUTIVE VICE PRESIDENT
justin.lerner@transwestern.com
847.588.5665

**JOE
KARMIN, SIOR**

EXECUTIVE VICE PRESIDENT
joe.karmin@transwestern.com
847.588.5670

No warranty or representation, expressed or implied, is made as to the accuracy of the information contained herein, and same is submitted subject to error and omissions.

296 Beeline Drive

Bensenville, IL 60106

21,800 SF



PROPERTY HIGHLIGHTS

Building Size	54,478 SF
Land Area	2.47 AC
Available Size	21,800 SF
Office Size	2,789 SF
Ceiling Height	18'8"
Loading	4 Interior Docks / 1 Drive-in Door
Power	400 Amps
Parking	31 Cars
Sprinklers	Wet
Year Built	1975
Construction	Masonry
Zoning	I-2 (General Industrial)
Lease Rate	Subject to Offer



- Proximity to O'Hare International Airport
- Great loading dock access
- Low DuPage County taxes
- Professionally owned and managed

LOCATION:

- 1.3 miles from the O'Hare Cargo Access
- 1.7 miles from the I-390 interchange
- Close proximity to Rt 83, I-290, and I-294

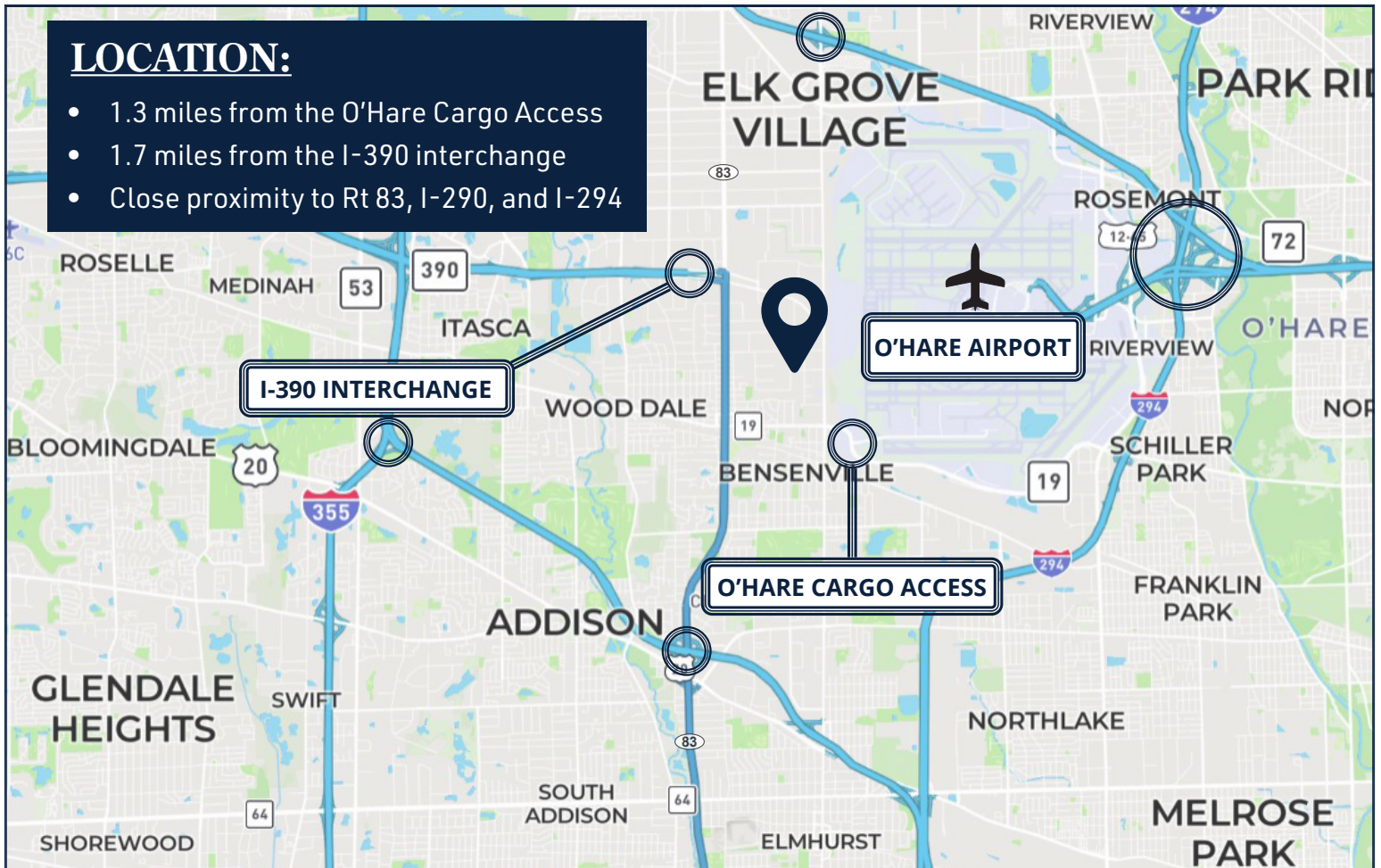

No warranty or representation, expressed or implied, is made as to the accuracy of the information contained herein, and same is submitted subject to error and omissions.

296 Beeline Drive

Bensenville, IL 60106

21,800 SF



FLOOR PLAN

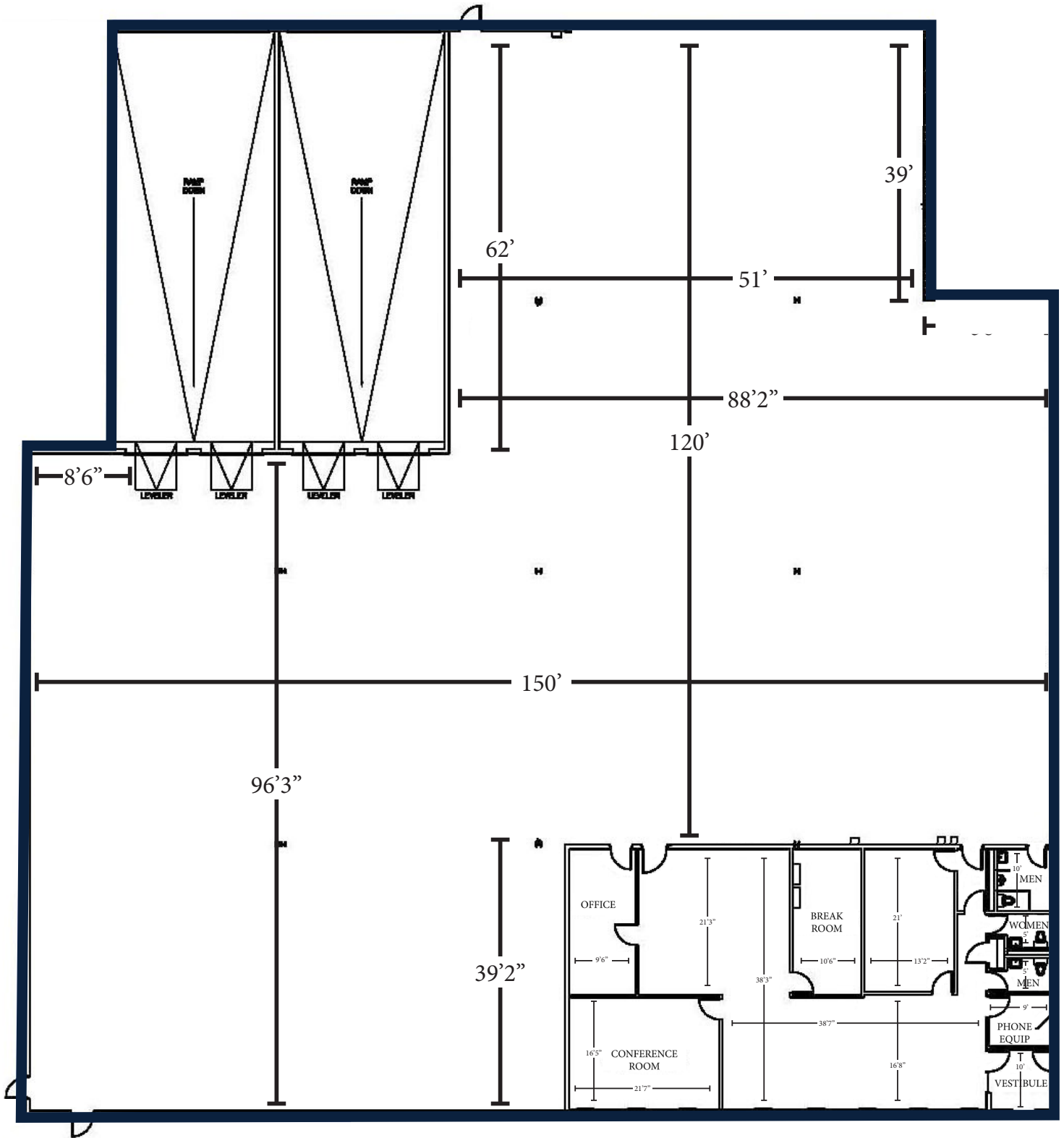

No warranty or representation, expressed or implied, is made as to the accuracy of the information contained herein, and same is submitted subject to error and omissions.