

**INDUSTRIAL
SPACE FOR
SUBLEASE**

±21,800 SF

Great
Loading Dock
Access

Direct Access
to O'Hare
Airport



TRANSWESTERN

REAL ESTATE
SERVICES

296 BEELINE DRIVE

Bensenville, IL 60106

[Property Website](#)



Specifications

- Building Size: ±54,478 SF
- Land Area: ±2.47 AC
- Available Size: ±21,800 SF
- Office Size: ±2,789 SF
- Ceiling Height: 18'8"
- Loading: 4 Interior Docks / 1 DID
- Power: 400 Amps
- Car Parking: 31
- Sprinklers: Wet
- Heating: Gas
- Year Built: 1975
- Construction: Masonry
- Zoning: I-2 (General Industrial)
- **Sublease Rate: Subject to Offer**

Highlights

- Direct access to O'Hare Airport
- Great loading dock access
- Very well-maintained building
- Professionally owned and managed
- Low DuPage County taxes
- Close proximity to Route 83, I-290, I-294 and I-390

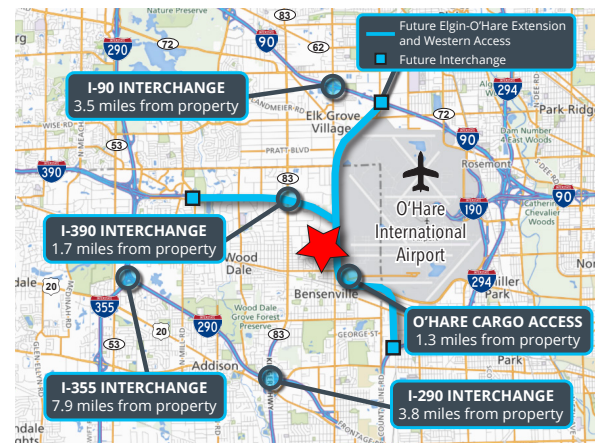

Ross Lehrman
Vice President
847.588.5671
ross.lehrman@transwestern.com

Justin Lerner, SIOR
Executive Vice President
847.588.5665
justin.lerner@transwestern.com

Joe Karmin, SIOR
Executive Vice President
847.588.5670
joe.karmin@transwestern.com

**INDUSTRIAL
SPACE FOR
SUBLEASE**

±21,800 SF

Great
Loading Dock
Access

Direct Access
to O'Hare
Airport



TRANSWESTERN

REAL ESTATE
SERVICES

296 BEELINE DRIVE

Bensenville, IL 60106

[Property Website](#)

SPACE LAYOUT

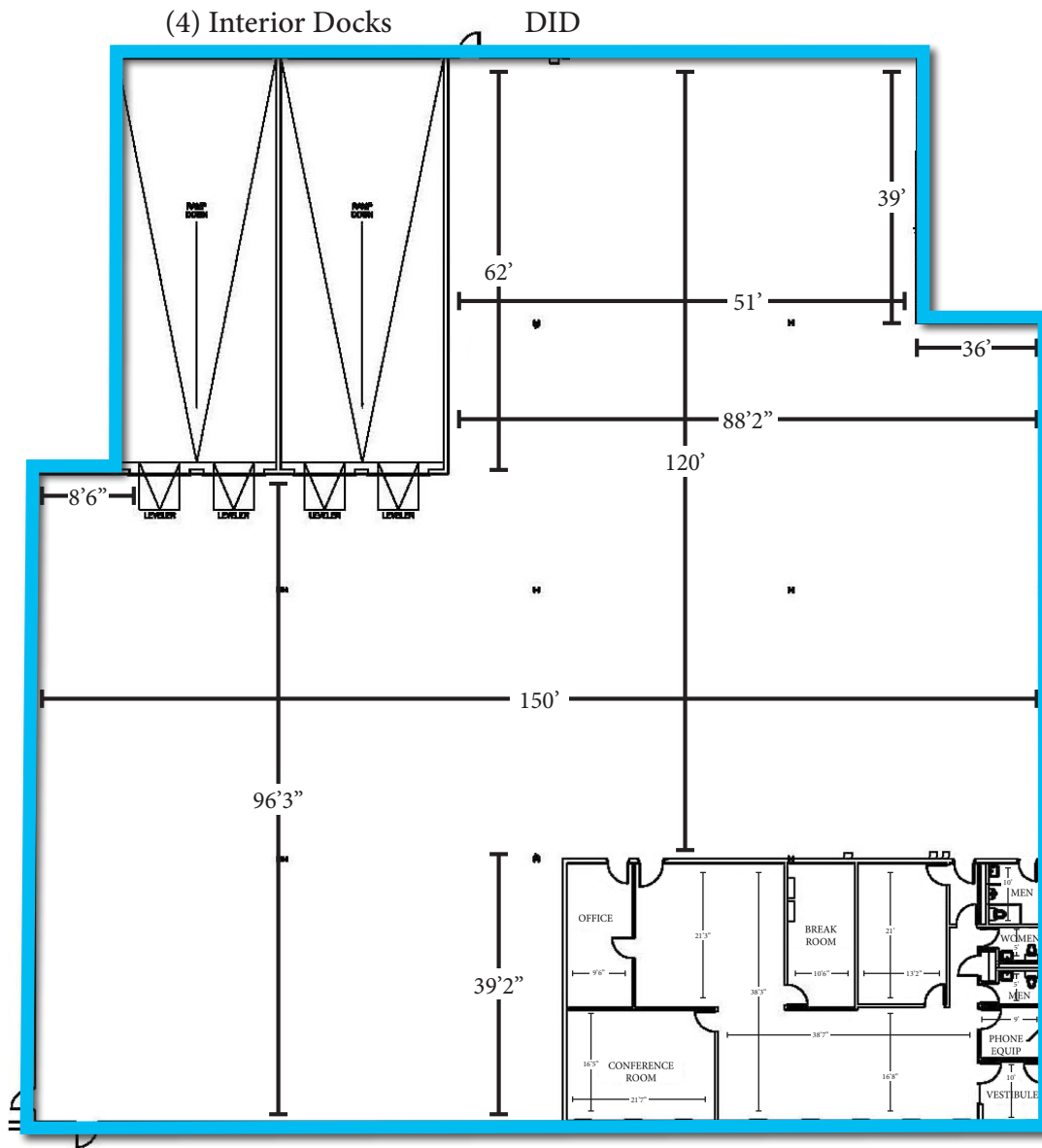

Ross Lehrman
Vice President
847.588.5671
ross.lehrman@transwestern.com

Justin Lerner, SIOR
Executive Vice President
847.588.5665
justin.lerner@transwestern.com

Joe Karmin, SIOR
Executive Vice President
847.588.5670
joe.karmin@transwestern.com