

±9,615 SF
**INDUSTRIAL
SPACE
FOR LEASE**

Make-ready
Office Space
Improvements
Underway

Abundant
Power

Fully
Temperature-
Controlled
Warehouse

TRANSWESTERN
REAL ESTATE
SERVICES

2503 PAN AM BLVD.

Elk Grove Village, IL 60007
[Property Website](#)



SPECIFICATIONS

- Building Size: ±15,987 SF
- Land Area: ±0.92 AC
- Available Size: ±9,615 SF
- Office Size: ±2,033 SF
- Ceiling Height: 13'
- Loading: 1 Ext. Dock / 1 DID
- Power: 1200A 240V
- Parking: ±10 Cars
- Heating: Gas
- Year Built: 1985
- Construction: Masonry
- Zoning: I-2 (General Industrial)
- **Lease Rate: \$13.50 PSF MG**

HIGHLIGHTS

- Make-ready office space improvements underway
- Recently paved parking lot
- Abundant power
- Fully temperature-controlled warehouse
- Low DuPage County taxes
- Direct access to O'Hare and major expressways

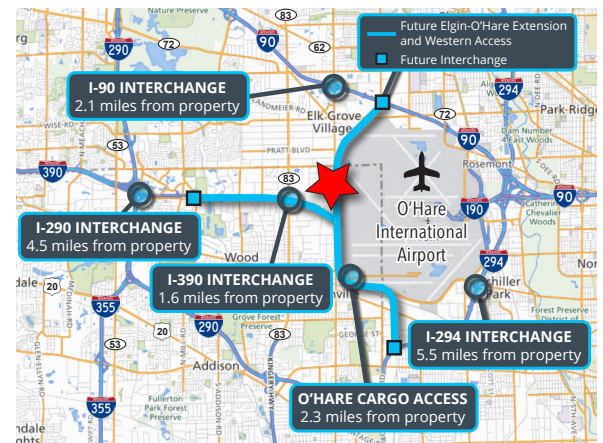

Ross Lehrman
Senior Vice President
847.588.5671
ross.lehrman@transwestern.com

Joe Karmin, SIOR
Executive Vice President
847.588.5670
joe.karmin@transwestern.com

Justin Lerner, SIOR
Executive Vice President
847.588.5665
justin.lerner@transwestern.com

±9,615 SF
**INDUSTRIAL
SPACE
FOR LEASE**

Make-ready
Office Space
Improvements
Underway

Abundant
Power

Fully
Temperature-
Controlled
Warehouse



TRANSWESTERN
REAL ESTATE
SERVICES

2503 PAN AM BLVD.

Elk Grove Village, IL 60007

[Property Website](#)

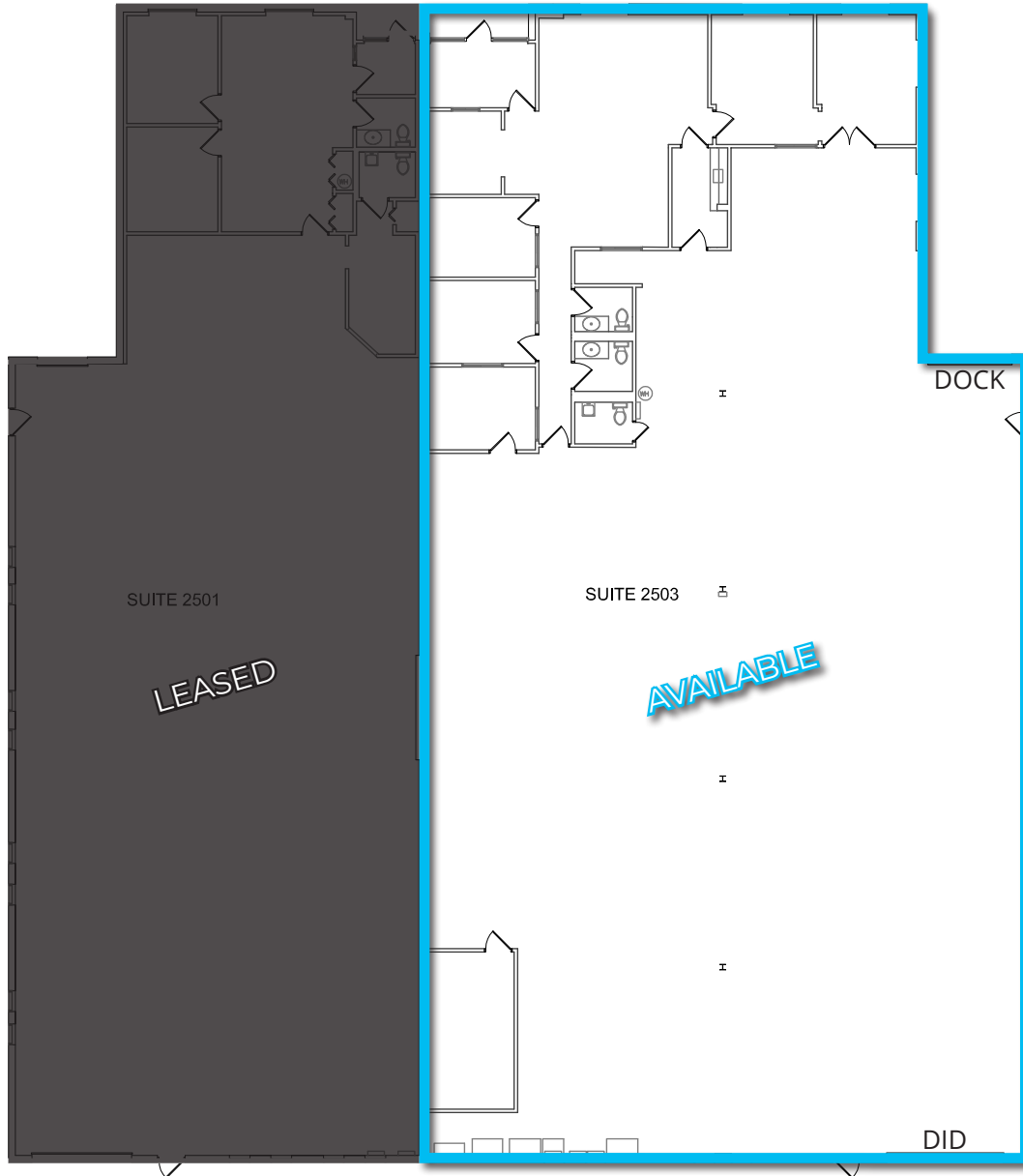
BUILDING LAYOUT



Ross Lehrman
Senior Vice President
847.588.5671
ross.lehrman@transwestern.com

Joe Karmin, SIOR
Executive Vice President
847.588.5670
joe.karmin@transwestern.com

Justin Lerner, SIOR
Executive Vice President
847.588.5665
justin.lerner@transwestern.com

The information provided herein was obtained from sources believed reliable; however, Transwestern makes no guarantees, warranties, or representations as to the completeness or accuracy thereof. The presentation of this information is submitted subject to errors, omissions, change of price or conditions, prior sale or lease, or withdrawal without notice. Copyright © 2025 Transwestern.

±9,615 SF
**INDUSTRIAL
SPACE
FOR LEASE**

Make-ready
Office Space
Improvements
Underway

Abundant
Power

Fully
Temperature-
Controlled
Warehouse

TRANSWESTERN
REAL ESTATE
SERVICES

2503 PAN AM BLVD.

Elk Grove Village, IL 60007
[Property Website](#)

PROPERTY PHOTOS



Warehouse



Warehouse



Office



Break Room

Ross Lehrman
Senior Vice President
847.588.5671
ross.lehrman@transwestern.com

Joe Karmin, SIOR
Executive Vice President
847.588.5670
joe.karmin@transwestern.com

Justin Lerner, SIOR
Executive Vice President
847.588.5665
justin.lerner@transwestern.com

The information provided herein was obtained from sources believed reliable; however, Transwestern makes no guarantees, warranties, or representations as to the completeness or accuracy thereof. The presentation of this information is submitted subject to errors, omissions, change of price or conditions, prior sale or lease, or withdrawal without notice. Copyright © 2025 Transwestern.