

# Whitewater Plaza

**OFFICE SPACE FOR LEASE**

12400 Whitewater Drive | Minnetonka, MN



## Property Details

This office space features Class A finishes with convenient first-floor access and an abundance of natural light from numerous windows. The suites can be retrofitted to meet your specific needs, offering flexibility for a variety of users. Tenants will benefit from abundant parking at a ratio of 4:1,000, along with excellent accessibility just minutes from I-494 and Crosstown (Highway 62), making it an ideal location for both employees and clients.

---

**LOCATION**                    **12400 WHITEWATER DR**  
**MINNETONKA, MN**

---

**BUILDING SIZE**            **60,000 SF**

---

**AVAILABILITY**

**SUITE 110A: 3,491 RSF \***  
**SUITE 110B: 4,011 RSF \***  
**\* CAN BE COMBINED TO 7,502 RSF**

**SUITE 2010: 11,652 RSF \***  
**SUITE 2030: 7,734 RSF \***  
**\* CAN BE COMBINED TO 19,386 RSF**

---

**ASKING RATES**            **\$15.00 PSF**

---

**2026 CAM & TAXES**    **\$9.75 PSF [SUITES 210 + 230]**  
**ESTIMATES**                **\$6.50 PSF [ SUITE 110 - FULL SERVICE]**

---



Chad Anvary

(612) 359-1642 | chad.anvary@transwestern.com

Bryan Beltrand

(612) 359-1616 | bryan.beltrand@transwestern.com

# Suite 110 Floor Plan - 7,502 RSF

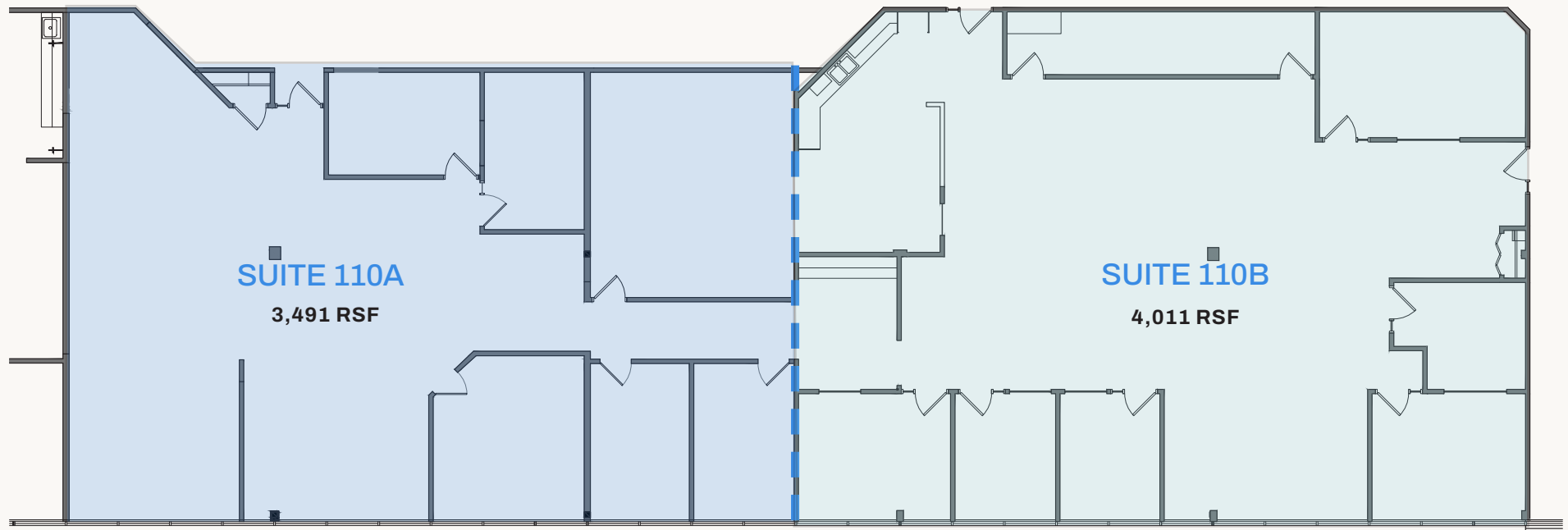

# Suite 2010 + 2030 Floor Plan - 19,386 RSF

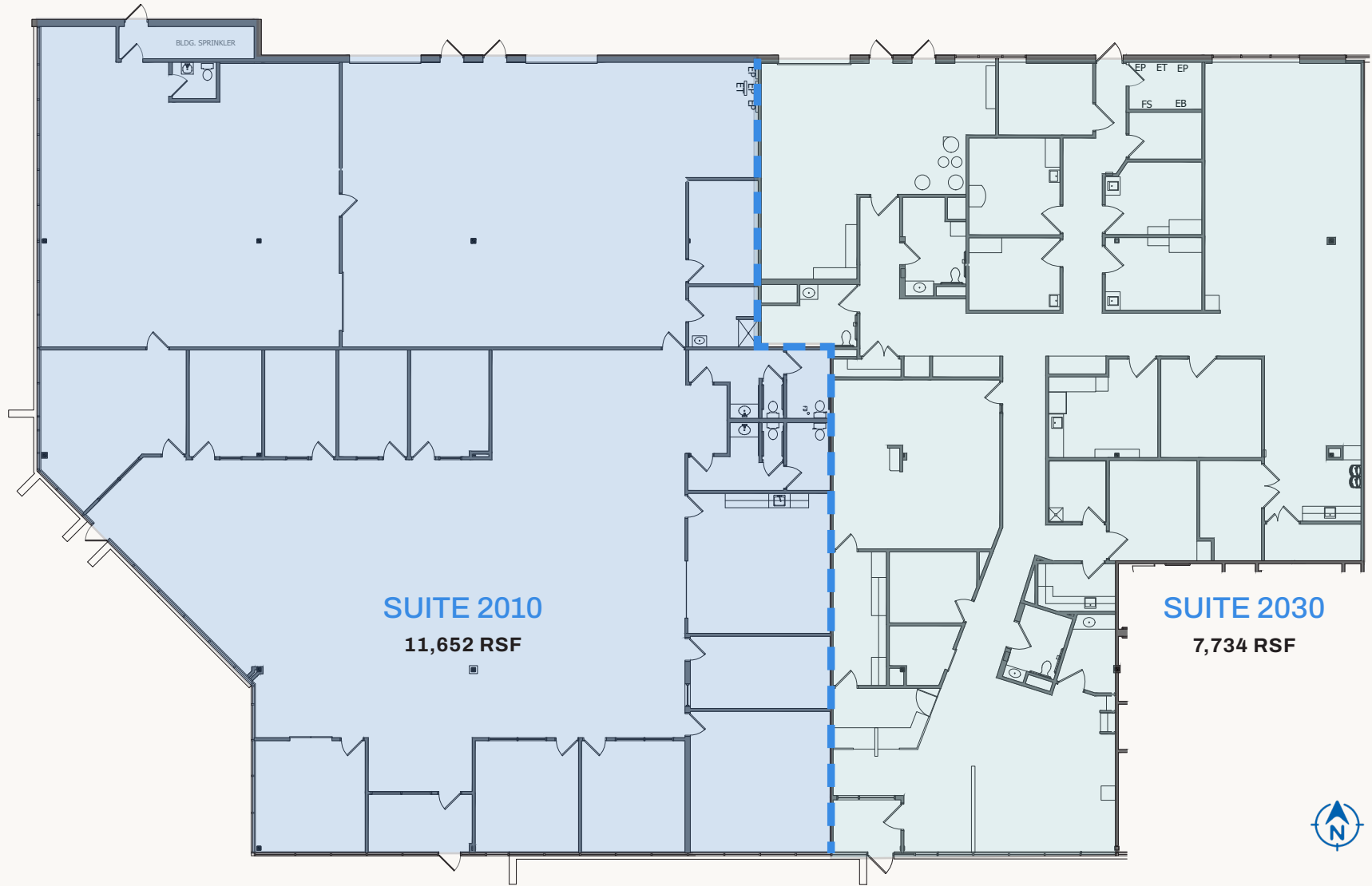





 Transwestern

Chad Anvary

(612) 359-1642

[chad.anvary@transwestern.com](mailto:chad.anvary@transwestern.com)

Bryan Beltrand

(612) 359-1616

[bryan.beltrand@transwestern.com](mailto:bryan.beltrand@transwestern.com)