

140

HAWTHORNE

SF | CA

AVAILABLE
NOW



FURNITURE AVAILABLE

140 HAWTHORNE SF | CA

140 Hawthorne sits in the heart of one of the most sought-after commercial neighborhoods in San Francisco. Located just 3 blocks from South Park and a short walk to public transportation, the building is surrounded by restaurants, coffee shops and other amenities. Built in 1948 and fully renovated in 2013, the building boasts soaring ceilings and abundant natural light.

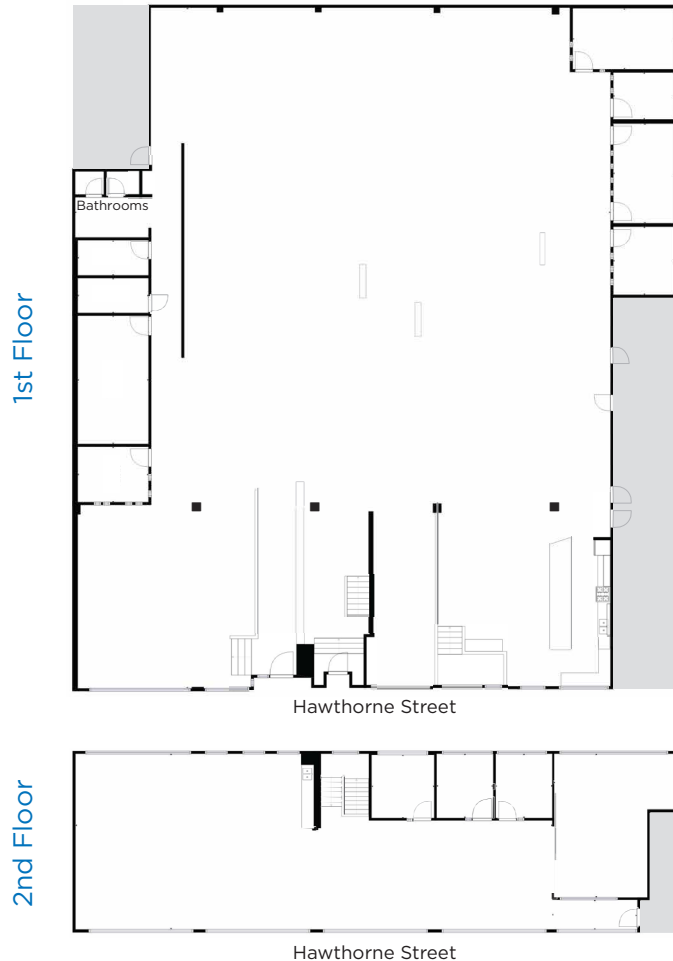

BUILDING FEATURES

- High \$60s IG
- 14,250 RSF
- Fully Furnished with High-End Furniture
- Free-Standing Building With Possible Exterior Signage
- Showers
- Full Commercial Kitchen
- Skylights
- Between Folsom & Harrison
- Walking Distance to BART/MUNI & Caltrain

1st Floor



2nd Floor



CONTACT

MIKE MCCARTHY

LIC# 00929942

mike.mccarthy@transwestern.com

415.489.1756

BRIAN MCCARTHY

LIC# 01840990

brian.mccarthy@transwestern.com

415.489.1753

MADDIE MEYERSIECK

LIC# 01961652

maddie.meyersieck@transwestern.com

415.489.1757