



BLAINE SQUARE

Retail For Lease | SWQ Hwy 242 & Hwy 65 | Blaine, MN

BLAINE SQUARE OVERVIEW



SITE INFORMATION

Location: SWQ of Hwy 242 (Main St) & Hwy 65 | Blaine, MN
Address: 12371 Ulysses Street NE | Blaine, MN



PHASE I

- Lot 1:** Chipotle (OPEN)
- Lot 2:** Popeyes (OPEN)
- Lot 3:** Caribou | Papa Murphy's | Pressed (OPEN)
- Lot 4:** Take 5 Oil Change (OPEN)
- Lot 5:** Bank of America (spring 2025 construction)

PHASE II

- Lot 1:** Cafe Zupas (OPEN)
- Lot 2:** Heartland Dental (OPEN)
- Lot 3:** Noodles | **QSR 2,880 SF w/ pickup window**
- Lot 4:** Chick-fil-A (OPEN)
- Lot 5:** Mister Car Wash (OPEN)



TRAFFIC COUNTS

Hwy 65 (Central Ave): 41,000 vpd
Hwy 242 (Main St): 22,100 vpd
Ulysses Street: 7,500 vpd



DEMOGRAPHICS

	1 Mile	3 Mile	5 Mile
Population	11,451	61,995	135,917
Daytime Population	9,768	52,387	120,002
Median HH Income	\$85,139	\$93,676	\$87,076
Average HH Income	\$99,879	\$112,472	\$103,652



BLAINE SQ. TENANTS



FOR MORE INFO CONTACT:

RICK HAUSER | 612.313.0125
 rhauser@caprei.com

ALLISON MORGAN | 612.313.0126
 amorgan@caprei.com

CHRIS SIMMONS | 612.359.1675
 chris.simmons@transwestern.com

JOHN JOHANNSON | 612.359.1680
 john.johannson@transwestern.com

BLAINE SQUARE PHASE I SITE PLAN

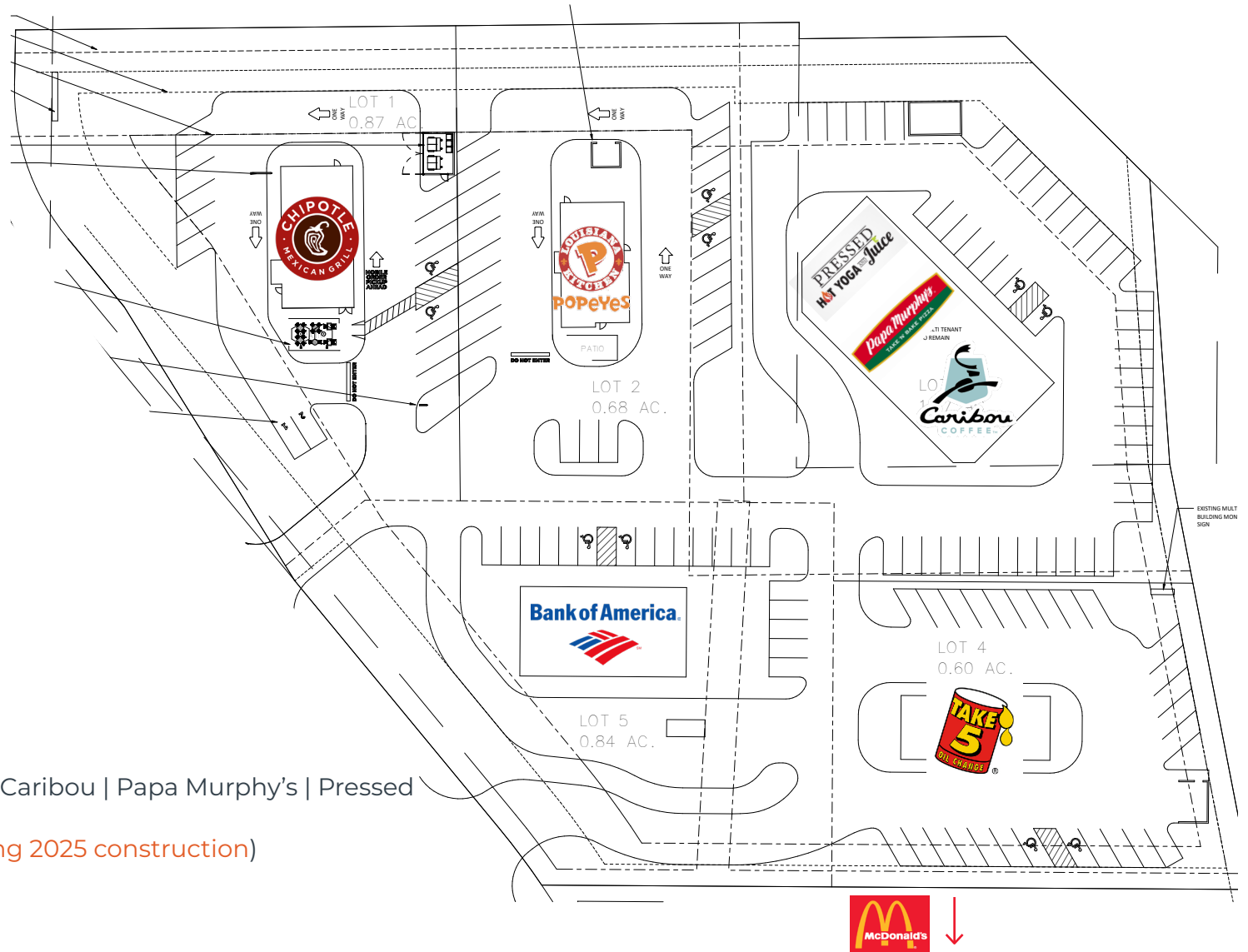

AVAILABILITY

- Lot 1:** Chipotle
- Lot 2:** Popeyes
- Lot 3:** Existing Strip Center - Caribou | Papa Murphy's | Pressed
- Lot 4:** Take 5 Oil Change
- Lot 5:** Bank of America (spring 2025 construction)

FOR MORE INFO CONTACT:

RICK HAUSER | 612.313.0125 | rhauser@caprei.com

ALLISON MORGAN | 612.313.0126 | amorgan@caprei.com

CHRIS SIMMONS | 612.359.1675 | chris.simmons@transwestern.com

JOHN JOHANNSON | 612.359.1680 | john.johannson@transwestern.com

BLAINE SQUARE PHASE II SITE PLAN

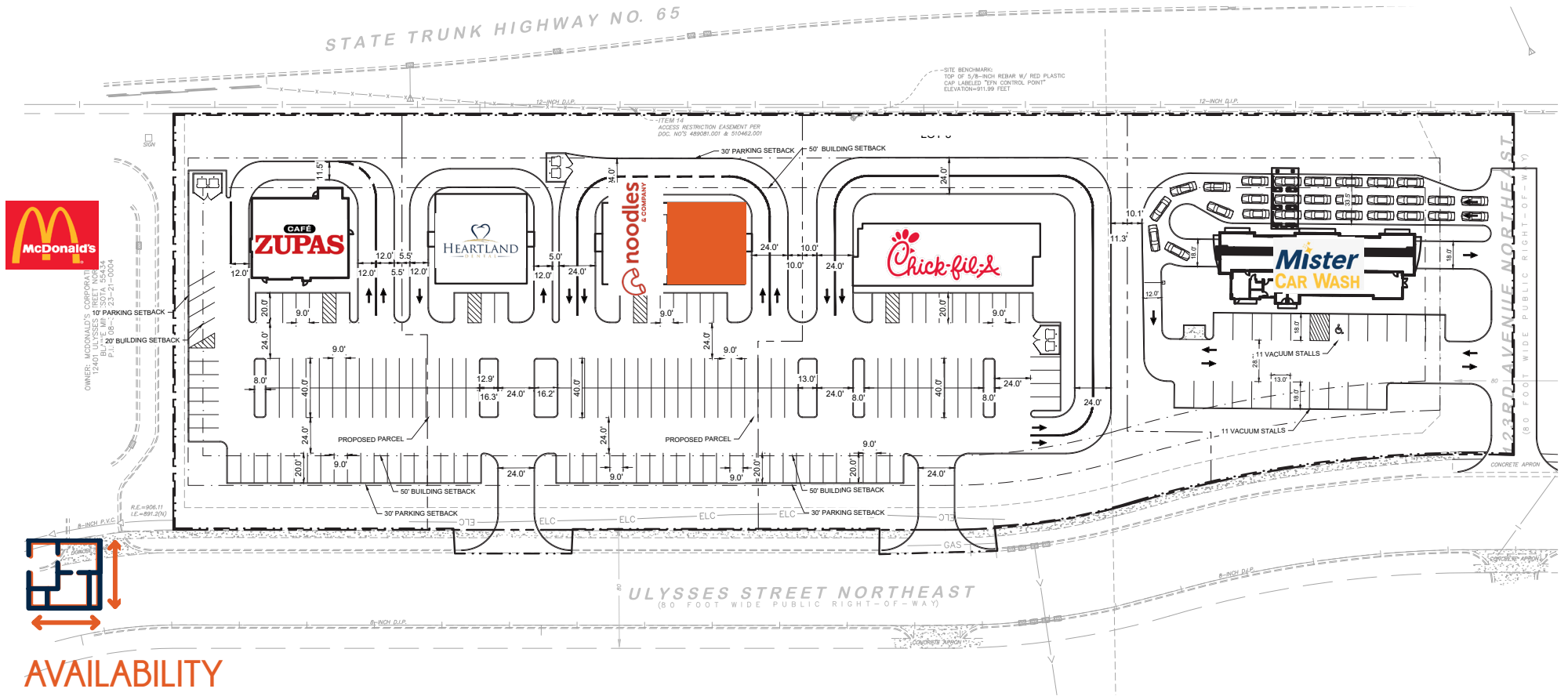

AVAILABILITY

- Lot 1:** Cafe Zupas
- Lot 2:** Heartland Dental
- Lot 3:** Noodles | **QSR 2,880 SF w/ pickup window**
- Lot 4:** Chick-fil-A
- Lot 5:** Mister Car Wash

FOR MORE INFO CONTACT:

RICK HAUSER | 612.313.0125 | rhauser@caprei.com

ALLISON MORGAN | 612.313.0126 | amorgan@caprei.com

CHRIS SIMMONS | 612.359.1675 | chris.simmons@transwestern.com

JOHN JOHANNSON | 612.359.1680 | john.johannson@transwestern.com

