

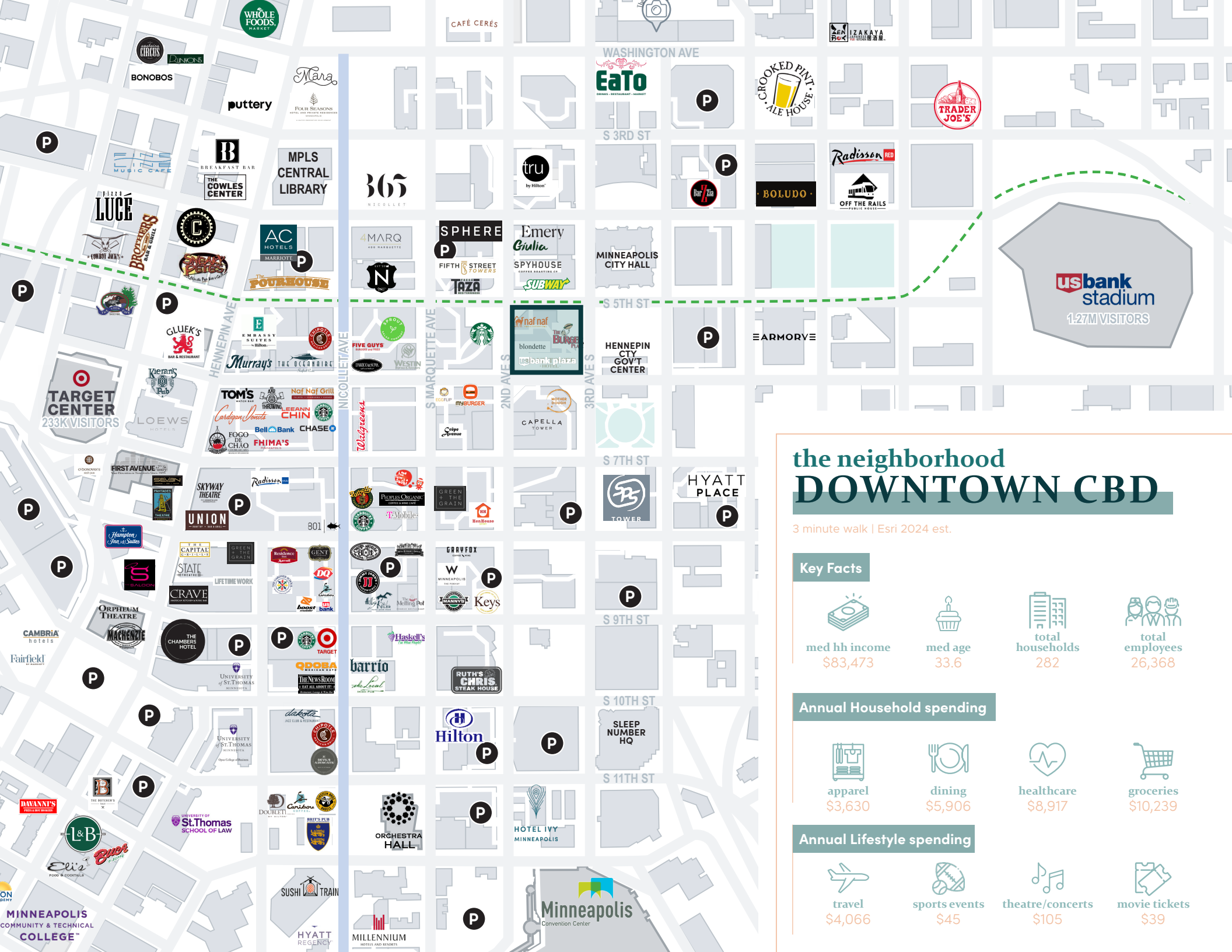

usbank plaza

RETAIL FOR LEASE
200 + 220 S. Sixth Street | Minneapolis, MN



the neighborhood DOWNTOWN CBD

3 minute walk | Esri 2024 est.

Key Facts



med hh income
\$83,473



med age
33.6



total households
282



total employees
26,368

Annual Household spending



apparel
\$3,630



dining
\$5,906



healthcare
\$8,917



groceries
\$10,239

Annual Lifestyle spending



travel
\$4,066



sports events
\$45



theatre/concerts
\$105



movie tickets
\$39

the OPPORTUNITY

Overview

LOCATION	200 + 220 S 6th Street Minneapolis, MN
GLA	1.3M sq. ft. office complex w/ skyway+street level retail/restaurant space
PARKING	530 stalls on-site
HIGHLIGHTS	Centrally located in the heart of Minneapolis CBD 4-skyway connections
CAM + TAX	\$10.94 psf Total (\$6.89 psf Ops + \$4.05 psf Tax)

Street Level Availabilities

SUITE A	1,912 sq. ft.
SUITE B	3,268 sq. ft.

Skyway Level Availabilities

SUITE C	2,587 sq. ft.
SUITE E	2,158 sq. ft. click for virtual tour
SUITE F	685 sq. ft.
SUITE G	1,875 sq. ft.



contacts RETAIL LEASING

• **Tony Strauss** • 612 359 1694 • tony.strauss@transwestern.com
• **Kris Schisel** • 612 359 1691 • kris.schisel@transwestern.com

T TRANSWESTERN

REALTY
RESOURCES
MEMBER

street level FLOOR PLAN



skyway level FLOOR PLAN

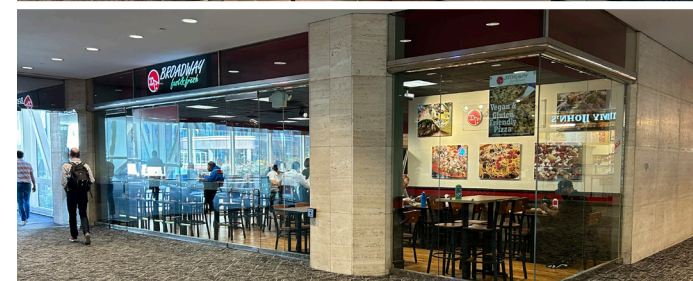
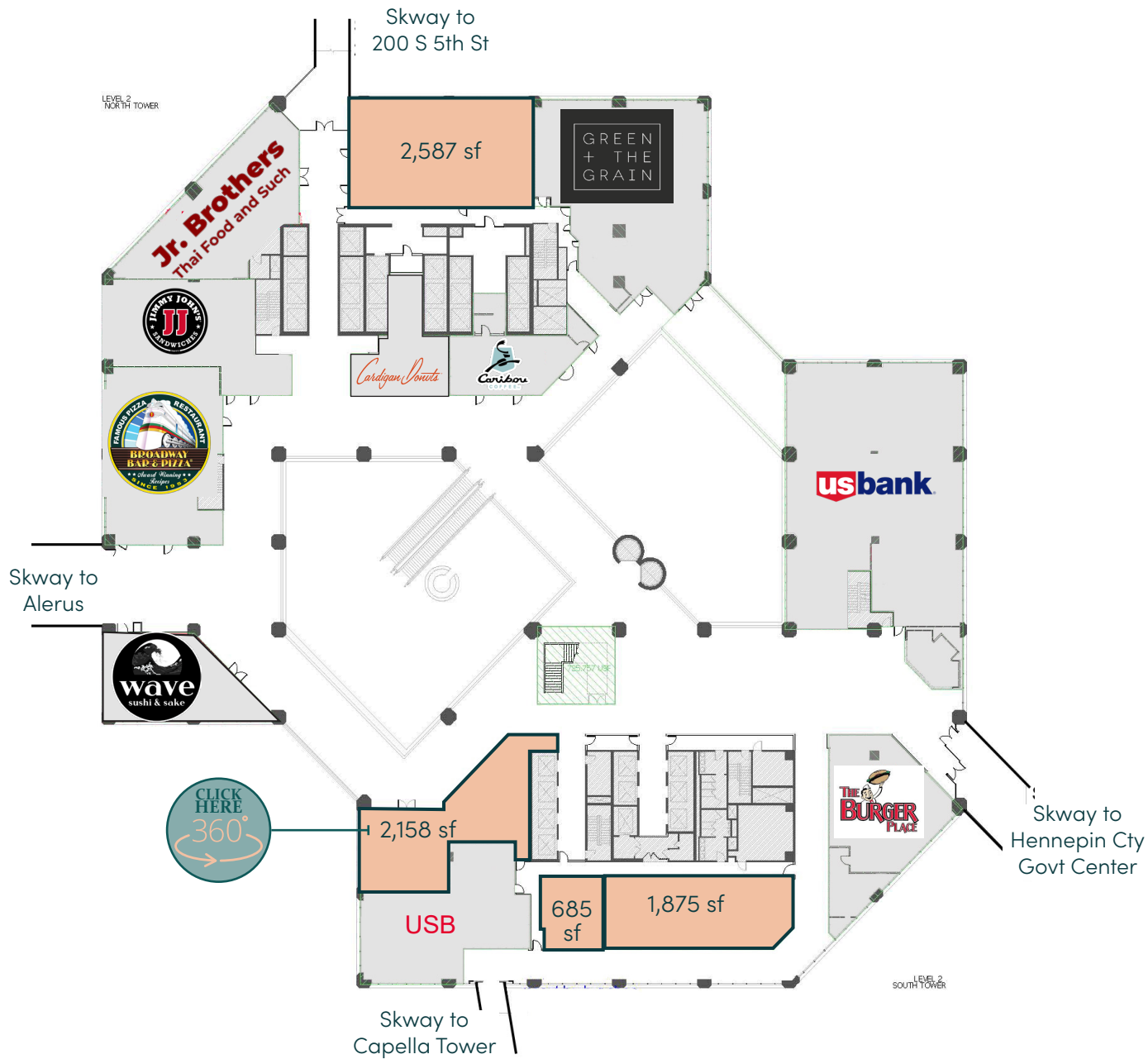

A photograph of the US Bank Plaza building, a tall, modern skyscraper with a grid-like facade of windows and concrete. The building is situated on a city street corner. In the foreground, there are traffic lights, street signs, and a few cars. The sky is clear and blue.

usbank plaza

RETAIL SPACE CONTACT

Tony Strauss • 612 359 1694 • tony.strauss@transwestern.com

Kris Schisel • 612 359 1691 • kris.schisel@transwestern.com

 **TRANSWESTERN**