



SUN RAY SHOPPING CENTER

Retail For SubLease | St. Paul, MN

JANET OLSON | 612-359-1681 | janet.olson@transwestern.com

SUN RAY SHOPPING CENTER

SUBLEASE OVERVIEW



TRANSWESTERN



SITE INFORMATION

Location: 2197 Old Hudson Road | St. Paul, MN
Description: Cub Foods anchored Shopping Center
Center GLA: 215,855 SF
Parking: Surface Lot

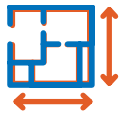

AVAILABILITY

Sublease: 14,242 SF Endcap
 Can be demised to 3,000 SF



TRAFFIC COUNTS

Interstate 94: 81,516 VPD
N McKnight Road: 20,200 VPD



DEMOGRAPHICS

| | 1 Mile | 3 Mile | 5 Mile |
|---------------------------|----------|----------|----------|
| Population | 13,576 | 103,943 | 264,972 |
| Daytime Population | 17,133 | 94,530 | 284,509 |
| Median HH Income | \$54,059 | \$58,228 | \$62,853 |
| Average HH Income | \$67,003 | \$73,945 | \$82,408 |



CENTER TENANTS



FOR INFORMATION CONTACT:

JANET OLSON | 612.359-1681
 janet.olson@transwestern.com

The information provided herein was obtained from sources believed reliable; however, Transwestern makes no guarantees, warranties or representations as to the completeness of accuracy thereof. The presentation of this property is submitted subject to errors, omissions, change of price or conditions, prior to sale or lease, or withdrawal without notice. Copyright © 2020 Transwestern.

AERIAL



FOR MORE INFO CONTACT:

JANET OLSON | 612-359-1681 | janet.olson@transwestern.com



PLAN

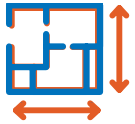
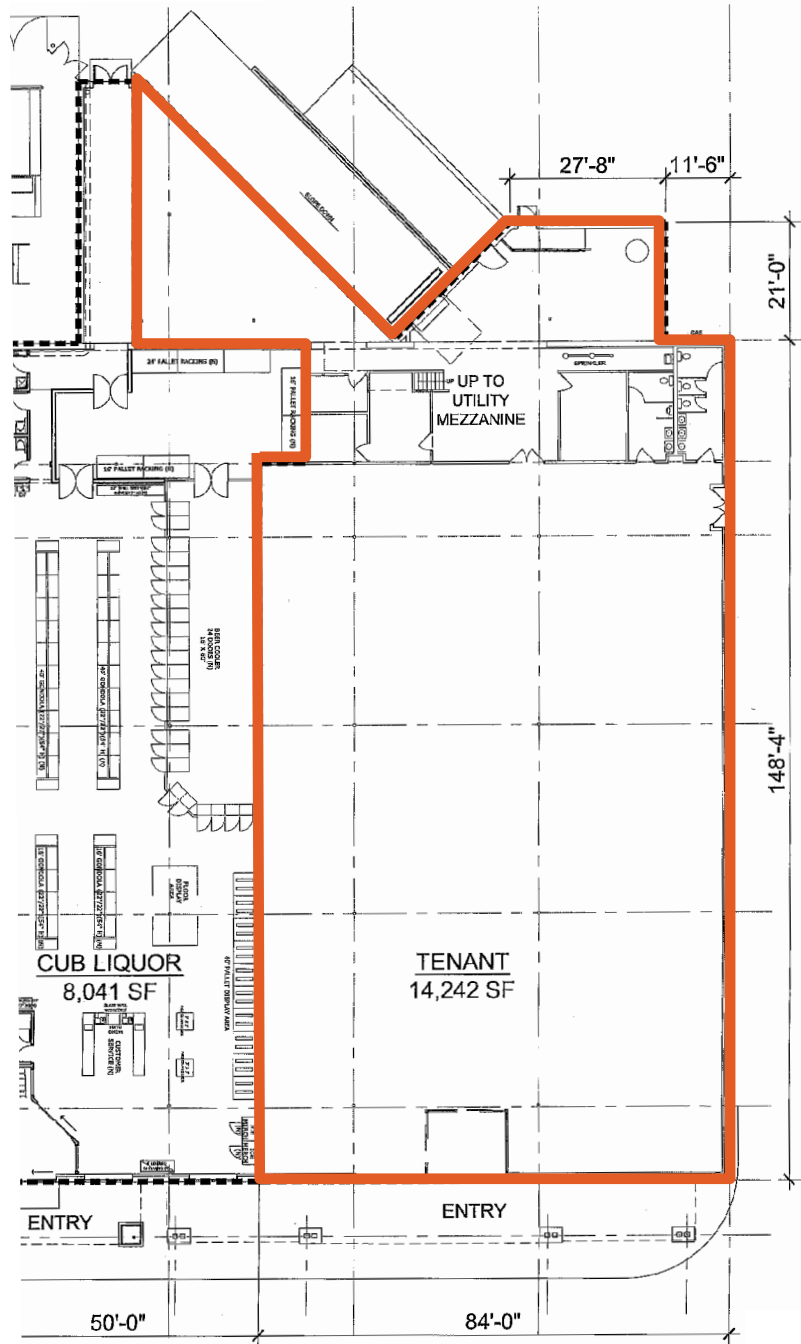

AVAILABILITY

Sublease: 14,242 SF

FOR MORE INFO CONTACT:

JANET OLSON | 612-359-1681 | janet.olson@transwestern.com

PHOTO



TRANSWESTERN



FOR MORE INFO CONTACT:

JANET OLSON | 612-359-1681 | janet.olson@transwestern.com

